

RAKE DETAILS

BD0010-ANGLE ATTACHMENT (MAR01)
BD0011-ANGLE ATTACHMENT WITH INSULATED ROOF PANEL
BD0015-ANGLE ATTACHMENT (MAP01)
BD0020-PARAPET ANGLE ATTACHMENT
BD0021-PARAPET ANGLE ATTACHMENT (NON-STRUCTURAL)
BD0025-PARAPET ANGLE ATTACHMENT (STRUCTURAL)
BD0030-PARAPET ANGLE ATTACHMENT (RAFTER IN HIGH BLDG)
BD0031-PARAPET ANGLE ATTACHMENT - WALL BELOW (RAFTER IN HIGH BLDG)
BD0040-PARAPET ANGLE ATTACHMENT (RAFTER IN LOW BLDG.)
BD0041-PARAPET ANGLE ATTACHMENT - WALL BELOW (RAFTER IN LOW BLDG)
BD0050-ANGLE ATTACHMENT AT CLOSED FASCIA
BD0060-ANGLE ATTACHMENT WITH RAKE EXTENSION
BD0070-ANGLE AND WRAP ATTACHMENT WITH RAKE EXTENSION
BD0100-ROOF SECONDARY NOTCH DETAIL
BD2000-ANGLE AND IRC MEMBER ATTACHMENT FOR R-Boost™

BD0010 - ANGLE ATTACHMENT (MAR01)

[Download the DWG file by clicking here.](#)

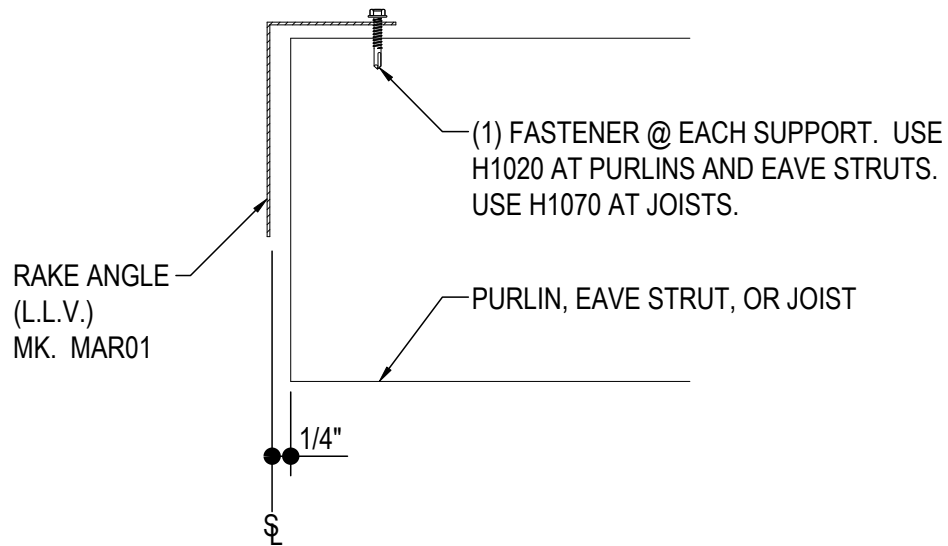

RAKE ANGLE ATTACHMENT

AT ENDWALL STEEL LINE

BD0010

Detailer Notes:

1)

BD0011 - ANGLE ATTACHMENT W/ INSULATED ROOF PANEL

[Download the DWG file by clicking here.](#)

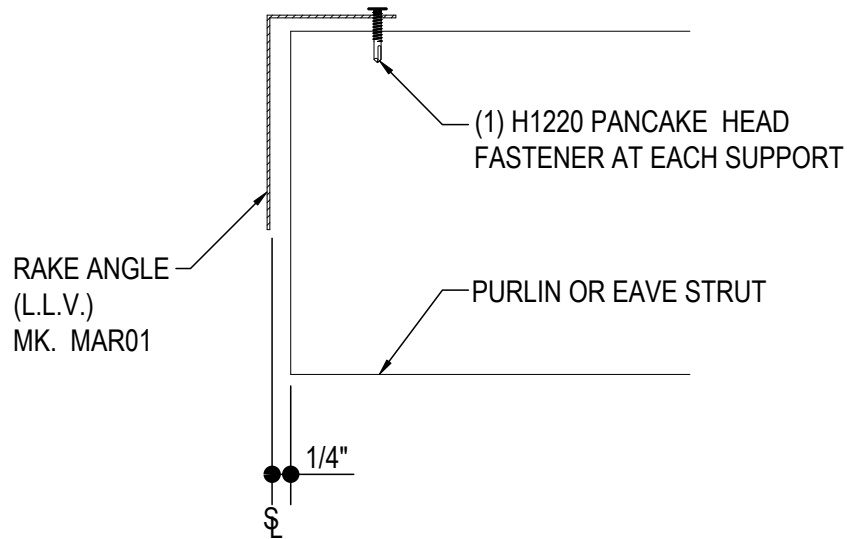

RAKE ANGLE ATTACHMENT

AT ENDWALL STEEL LINE WITH INSULATED ROOF PANEL

BD0011

Detailer Notes:

1)

BD0015 - ANGLE ATTACHMENT (MAP01)

[Download the DWG file by clicking here.](#)

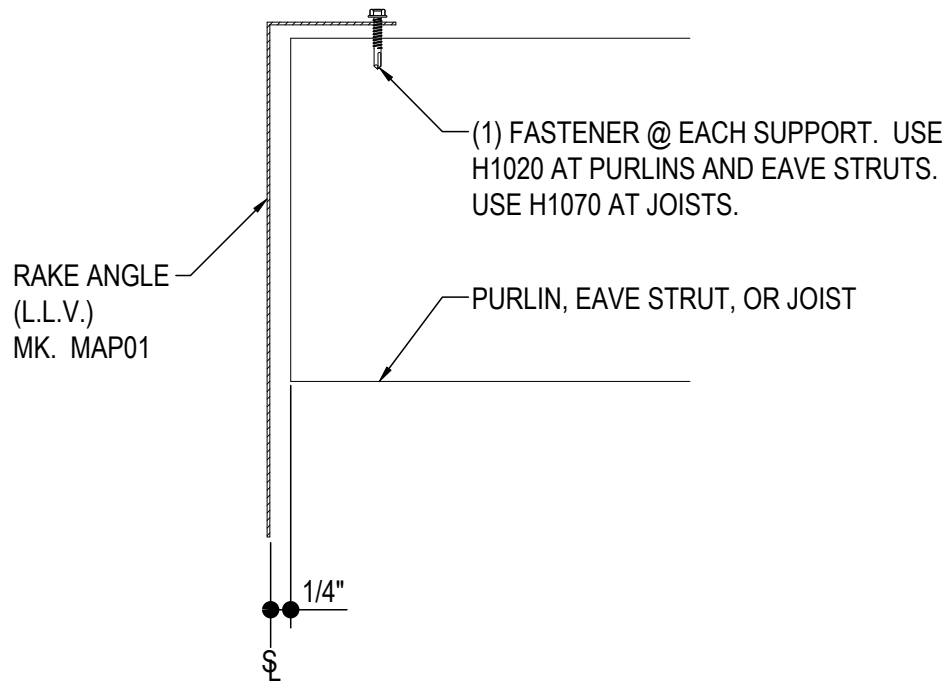

RAKE ANGLE ATTACHMENT

AT ENDWALL STEEL LINE

BD0015

Detailer Notes:

1)

BD0020 - PARAPET ANGLE ATTACHMENT

[Download the DWG file by clicking here.](#)

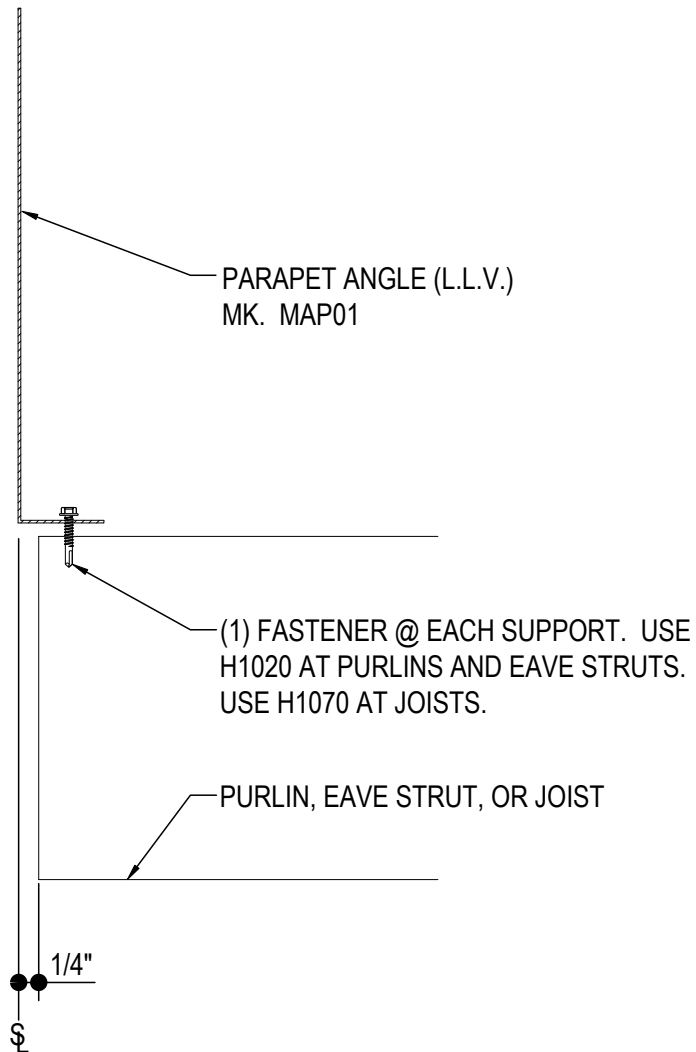

RAKE PARAPET ANGLE ATTACHMENT

BD0020

Detailer Notes:

1)

BD0021 - PARAPET ANGLE ATTACHMENT (NON-STRUCTURAL)

[Download the DWG file by clicking here.](#)

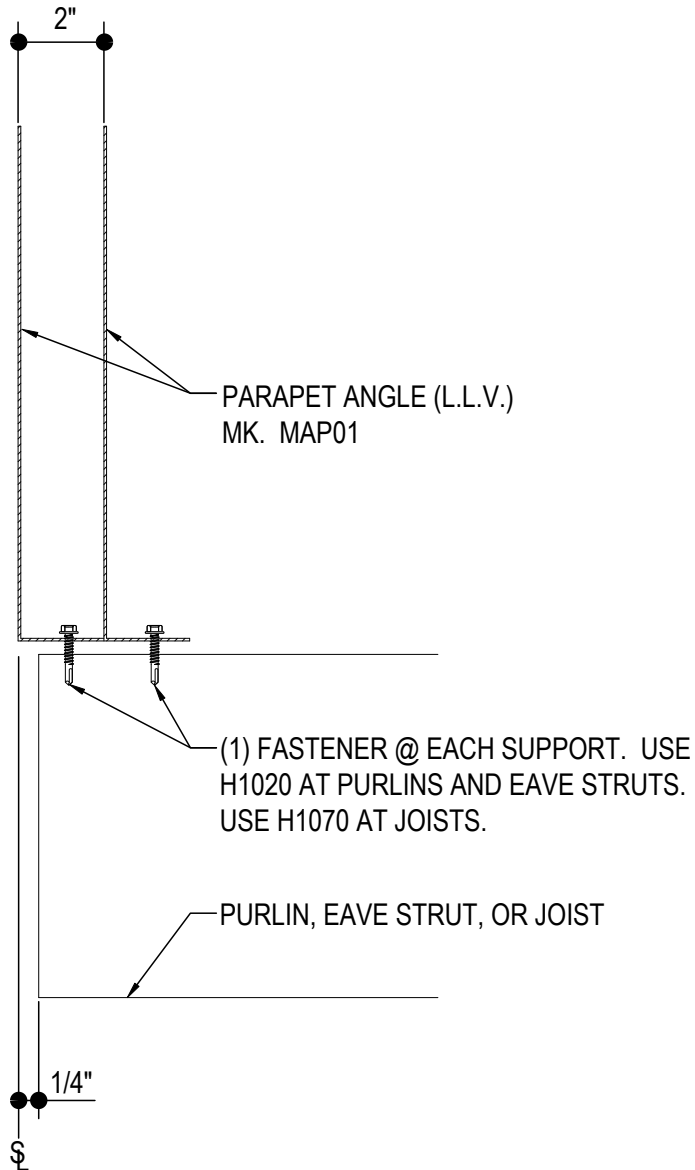

RAKE PARAPET ANGLE ATTACHMENT

AT NON-STRUCTURAL PARAPET

BD0021

Detailer Notes:

1)

BD0025 - PARAPET ANGLE ATTACHMENT (STRUCTURAL)

[Download the DWG file by clicking here.](#)

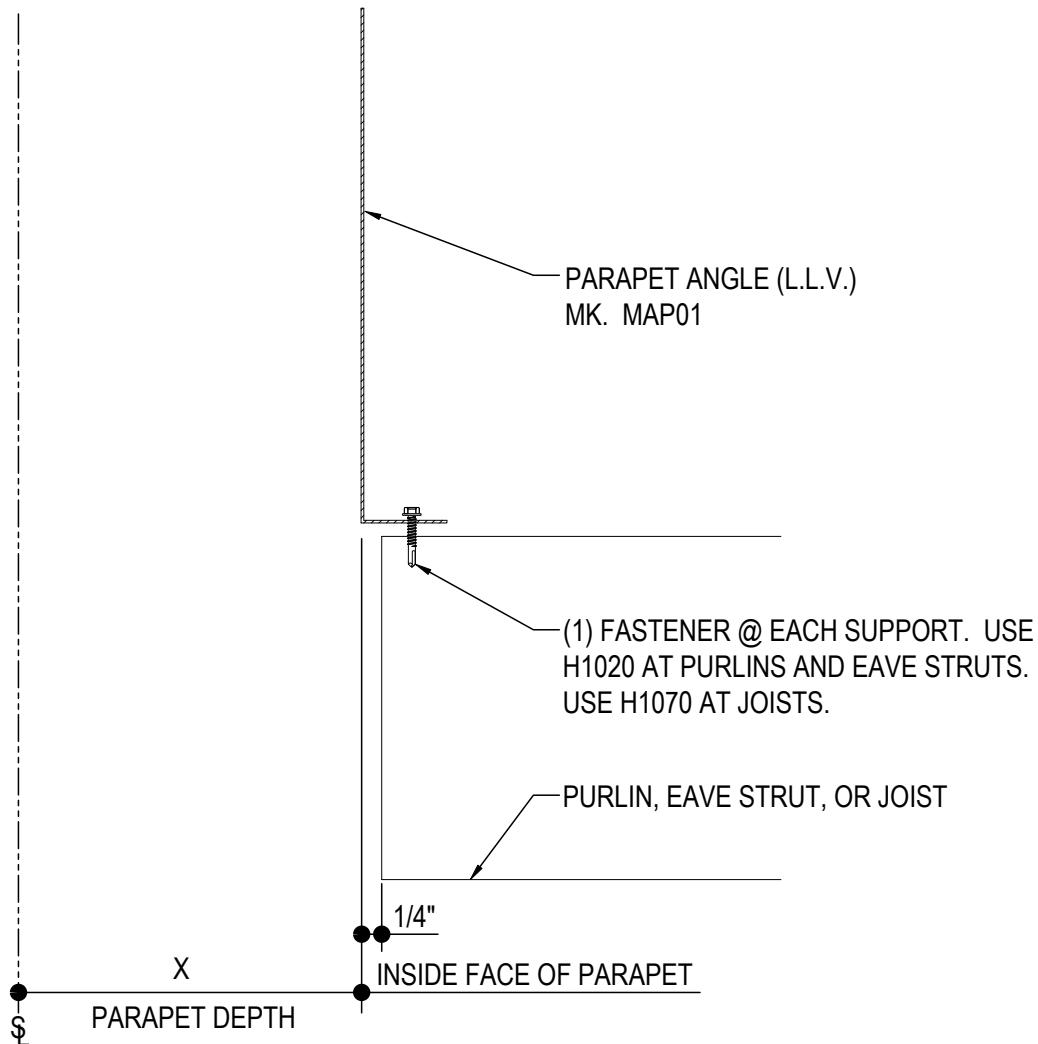

RAKE PARAPET ANGLE ATTACHMENT

AT STRUCTURAL PARAPET

BD0025

Detailer Notes:

1)

BD0030 - PARAPET ANGLE ATTACHMENT (RAFTER IN HIGH BLDG.)

[Download the DWG file by clicking here.](#)

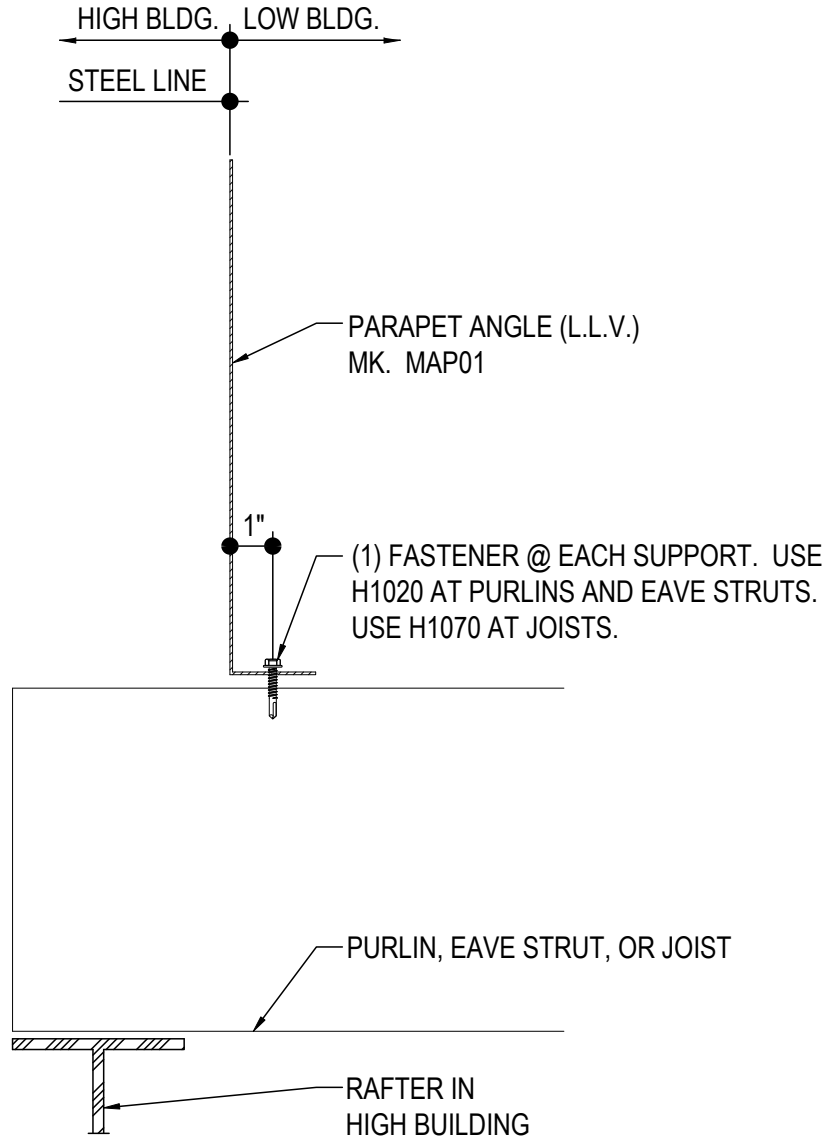

RAKE PARAPET ANGLE ATTACHMENT

RAKE PARAPET (RAFTER IN HIGH BUILDING)

BD0030

Detailer Notes:

1)

BD0031 - PARAPET ANGLE ATTACHMENT W/ WALL BELOW (RAFTER IN HIGH BLDG.)

[Download the DWG file by clicking here.](#)

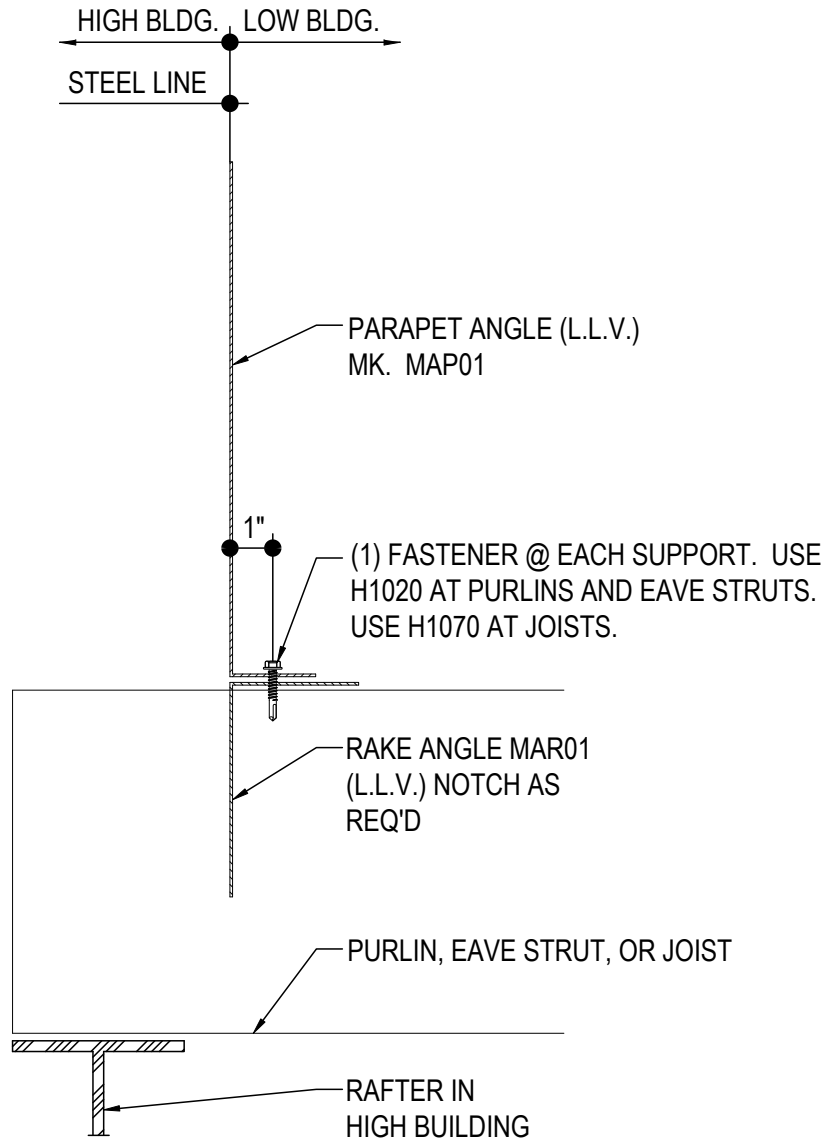

RAKE PARAPET ANGLE ATTACHMENT

RAKE PARAPET WITH WALL BELOW (RAFTER IN HIGH BUILDING)

BD0031

Detailer Notes:

1)

BD0040 - PARAPET ANGLE ATTACHMENT (RAFTER IN LOW BLDG.)

[Download the DWG file by clicking here.](#)

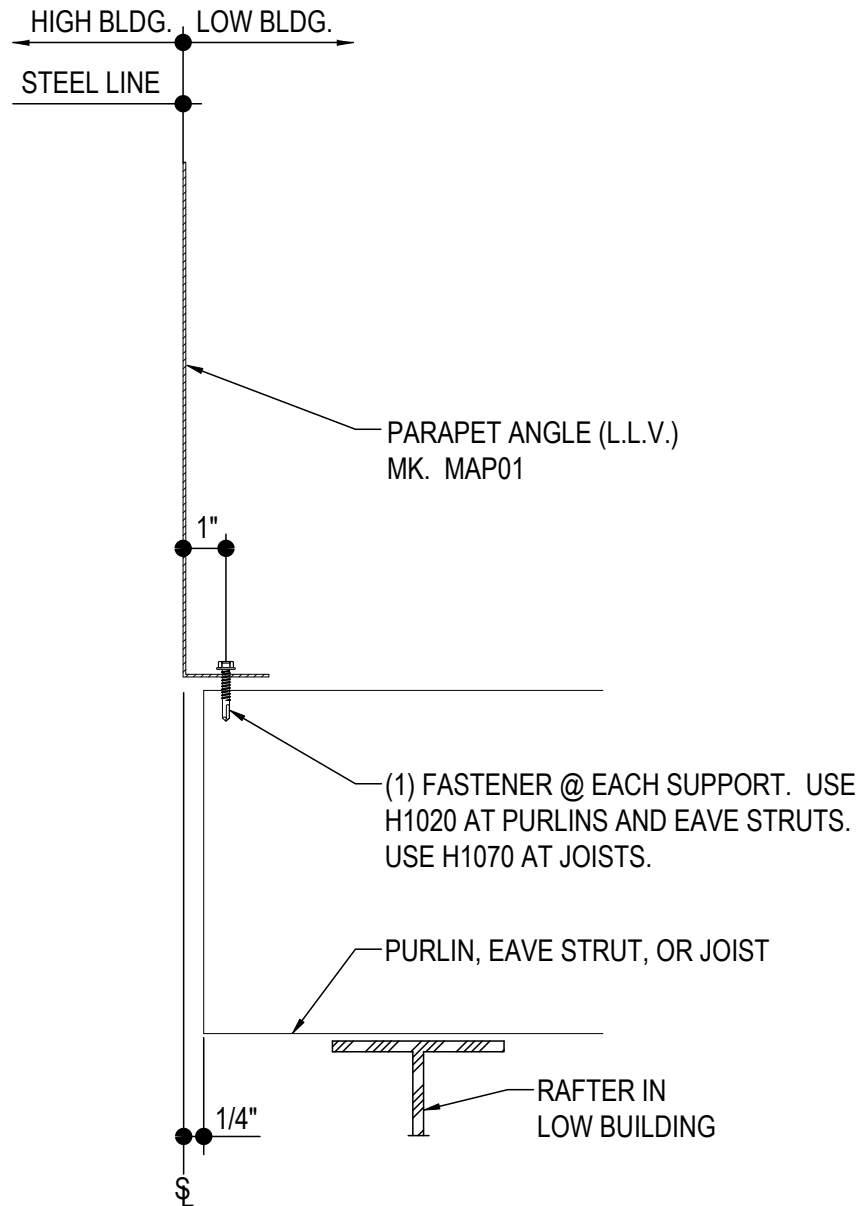

RAKE PARAPET ANGLE ATTACHMENT

RAKE PARAPET (RAFTER IN LOW BUILDING)

BD0040

Detailer Notes:

1)

BD0041 - PARAPET ANGLE ATTACHMENT W/ WALL BELOW (RAFTER IN LOW BLDG.)

[Download the DWG file by clicking here.](#)

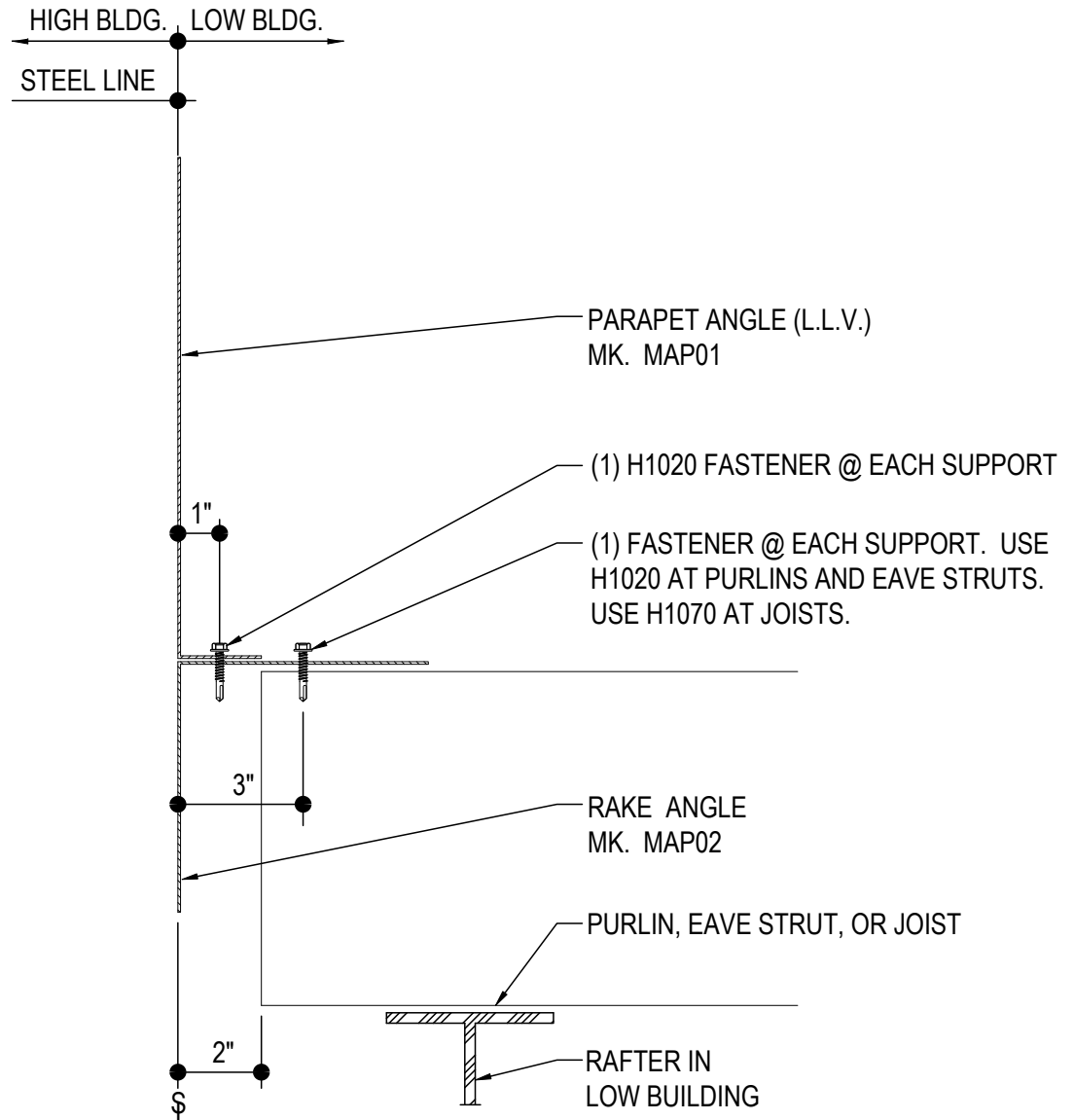

RAKE PARAPET ANGLE ATTACHMENT

RAKE PARAPET WITH WALL BELOW (RAFTER IN LOW BUILDING)

BD0041

Detailer Notes:

1)

BD0050 - ATTACHMENT AT CLOSED FASCIA

[Download the DWG file by clicking here.](#)

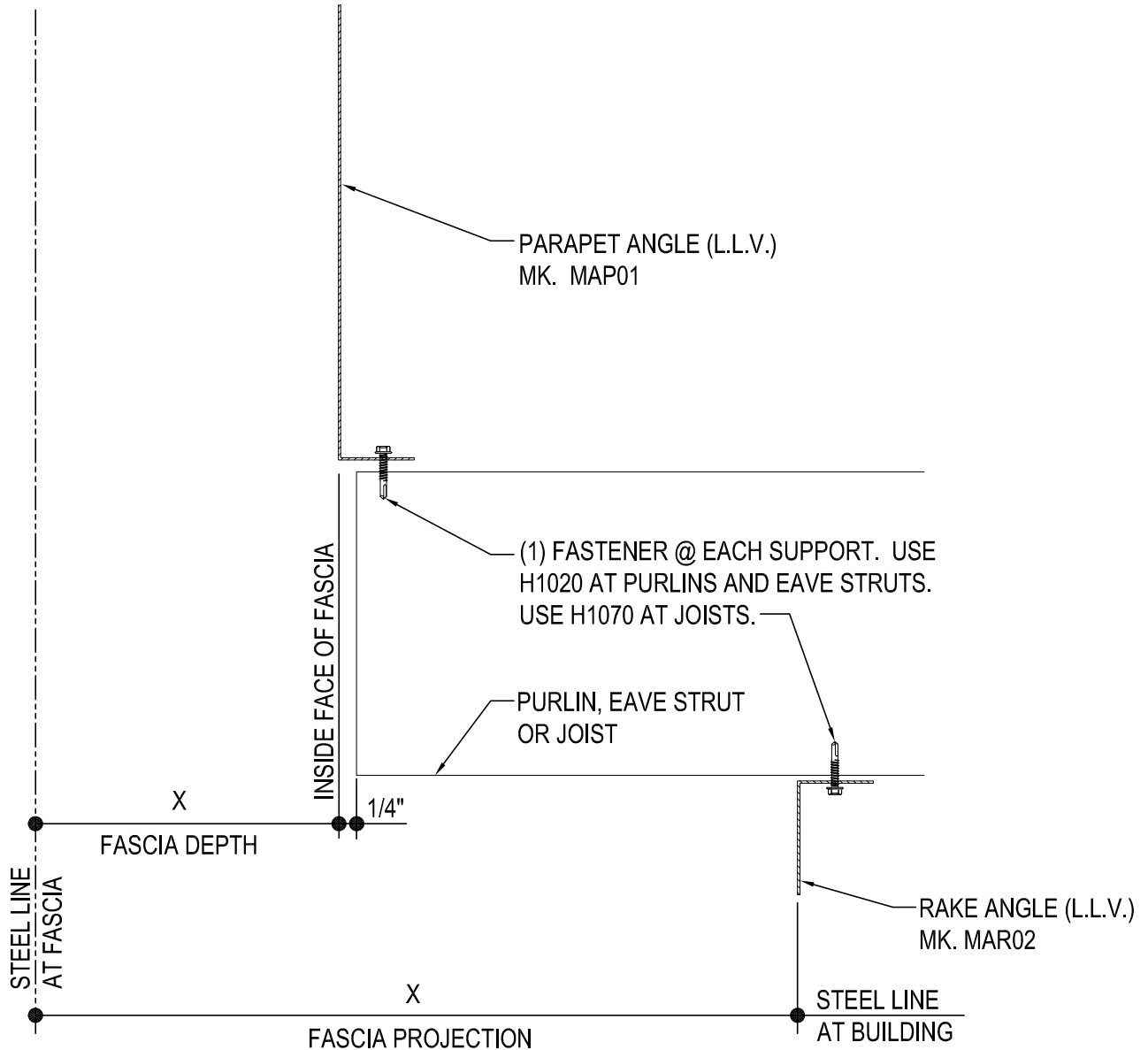

RAKE ANGLE ATTACHMENT

AT CLOSED FASCIA

BD0050

Detailer Notes:

1)

BD0060 - ANGLE ATTACHMENT W/ RAKE EXTENSION

[Download the DWG file by clicking here.](#)

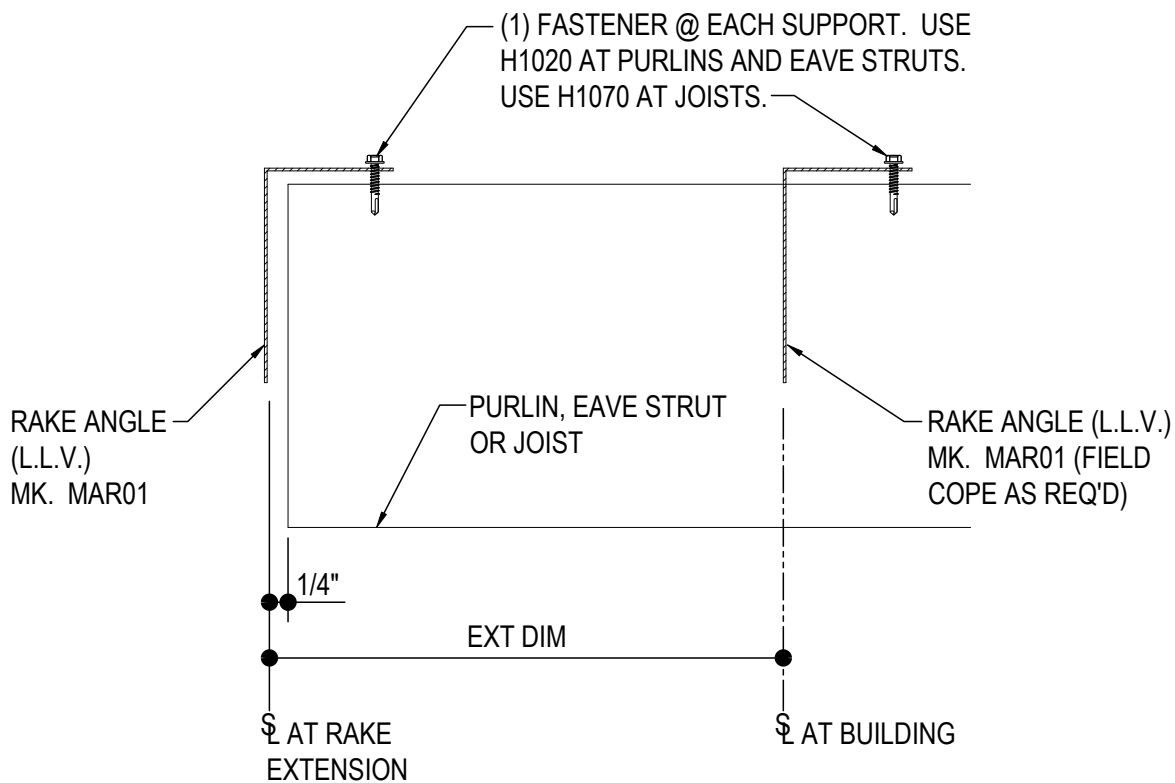

RAKE ANGLE ATTACHMENT

AT ENDWALL STEEL LINE WITH RAKE EXTENSION

BD0060

Detailer Notes:

1)

BD0070 - ANGLE / WRAP ATTACHMENT W/ RAKE EXTENSION

[Download the DWG file by clicking here.](#)

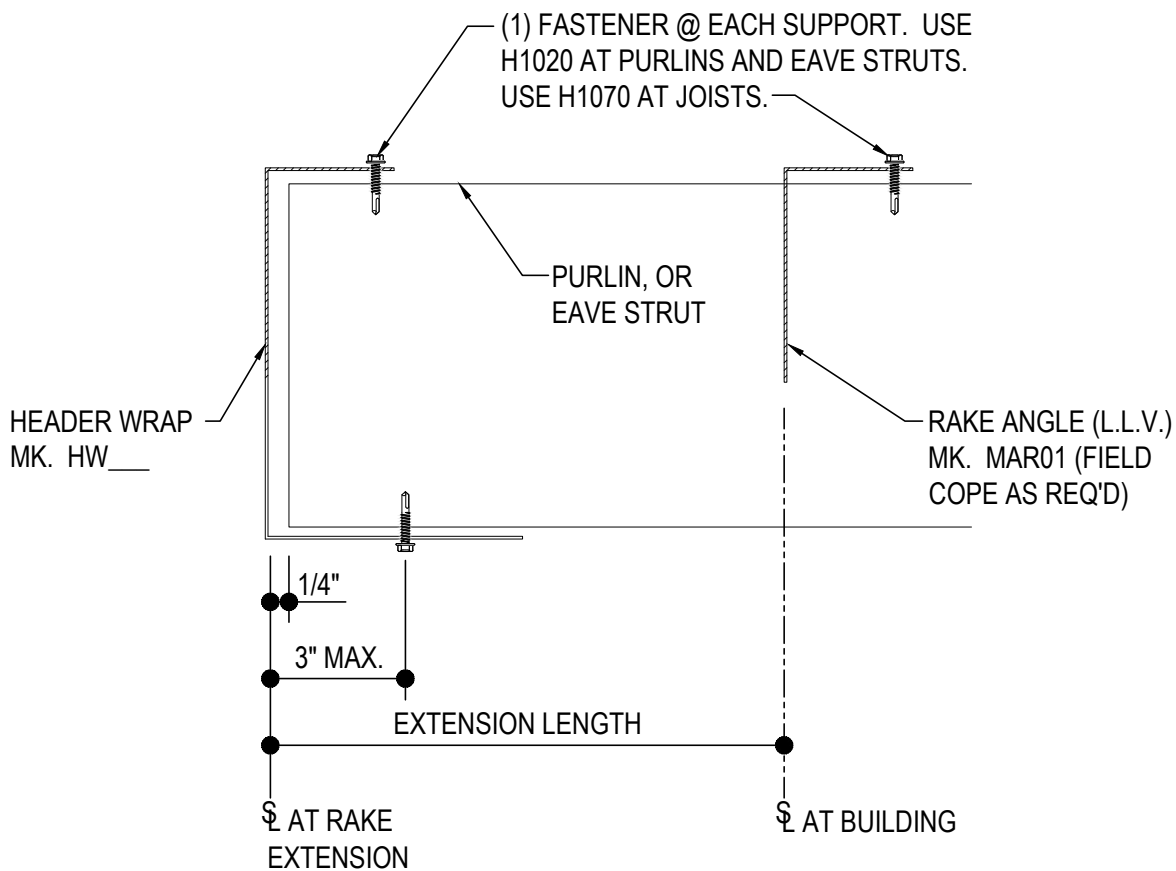

ANGLE / WRAP ATTACHMENT w / RAKE EXTENSION

AT ENDWALL STEEL LINE WITH RAKE EXTENSION
(SOFFIT PANEL PERPENDICULAR TO WALL)

BD0070

Detailer Notes:

1)

BD0100 - ROOF SECONDARY NOTCH AT MASONRY WALL

[Download the DWG file by clicking here.](#)

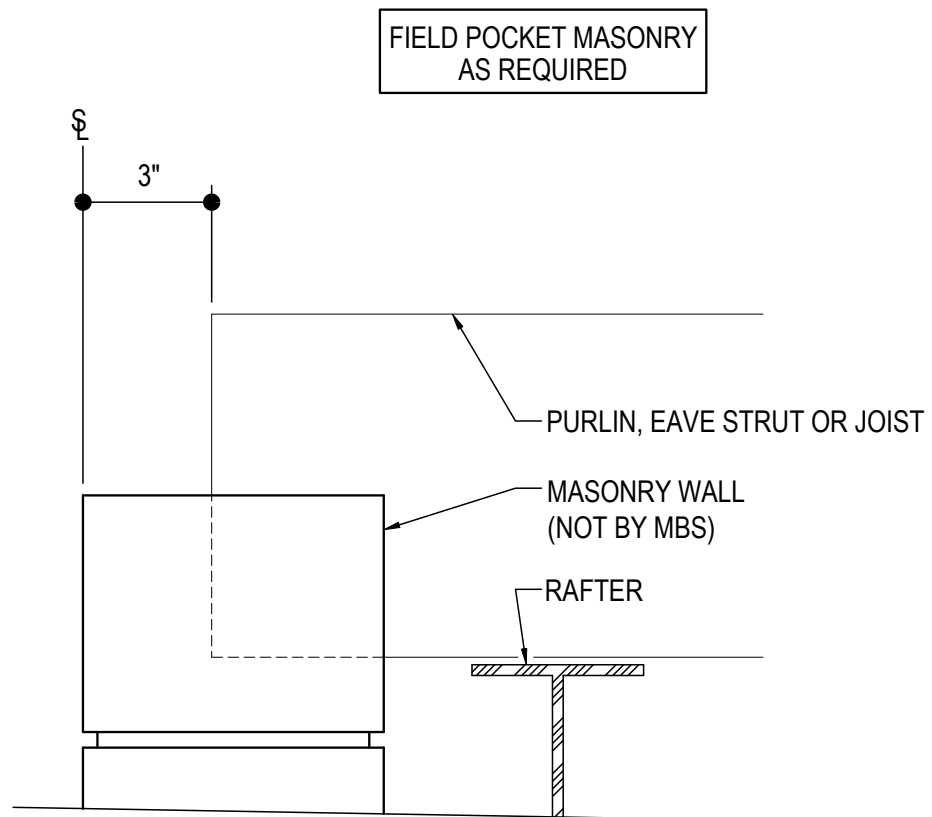

ROOF SECONDARY NOTCH DETAIL

ROOF SECONDARY AT MASONRY WALL

BD0100

Detailer Notes:

1)

BD2000 - ANGLE AND IRC MEMBER ATTACHMENT FOR R-Boost™

[Download the DWG file by clicking here.](#)

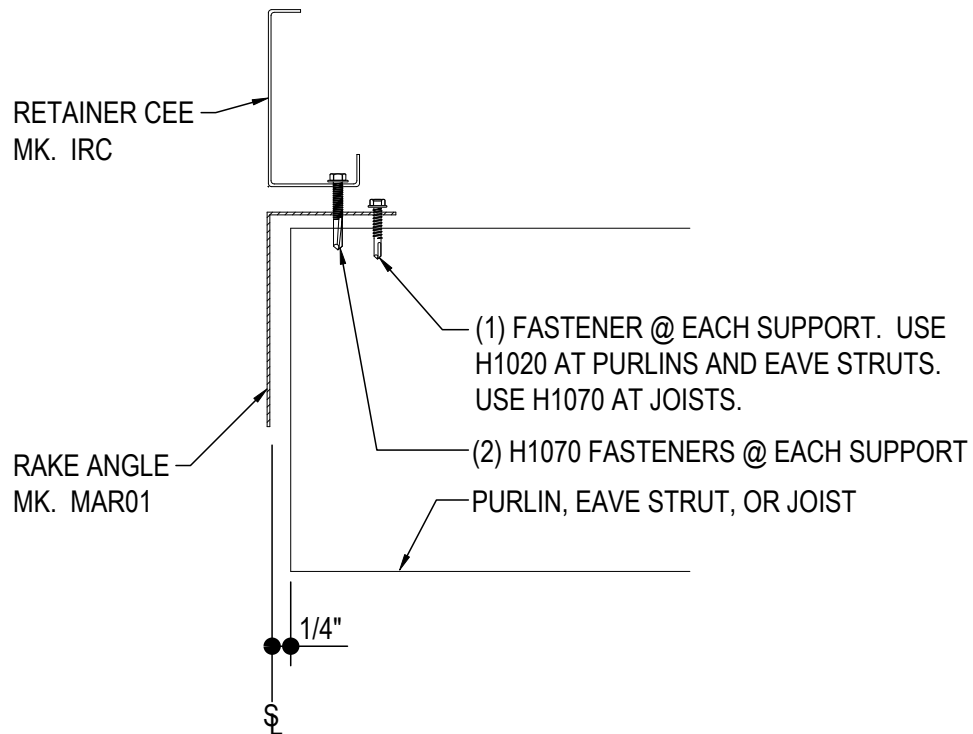

R-Boost™ RAKE ANGLE ATTACHMENT

WITH IRC ATTACHMENT

BD2000

Detailer Notes:

1) USE WITH EVERY PROJECT WITH R-Boost™ ROOF SYSTEMS. THE MAR01 AND IRC IS TO BE INSTALLED AT TIME OF PURLIN INSTALLATION.