

## RAKE (PARAPET)

EF8000-ZEE RAKE CLOSURE LAP DETAIL

EF8100-WALL PANEL ABOVE

EF8200-WALL ABOVE AND BELOW (RAFTER IN LOW BLDG.)

EF8300-WALL ABOVE AND BELOW (RAFTER IN HIGH BLDG.)

EF8400-MASONRY WALL

---

EF8000 - ZEE RAKE CLOSURE LAP DETAIL

[Download the DWG file by clicking here.](#)

**ERECTOR NOTE:**

INSTALL ZEE RAKE CLOSURE  
STARTING AT THE HIGH EAVE AND LAP  
DOWNSLOPE ZEE RAKE CLOSURE  
OVER UPSLOPE ZEE RAKE CLOSURE  
TO INSURE WATER TIGHTNESS

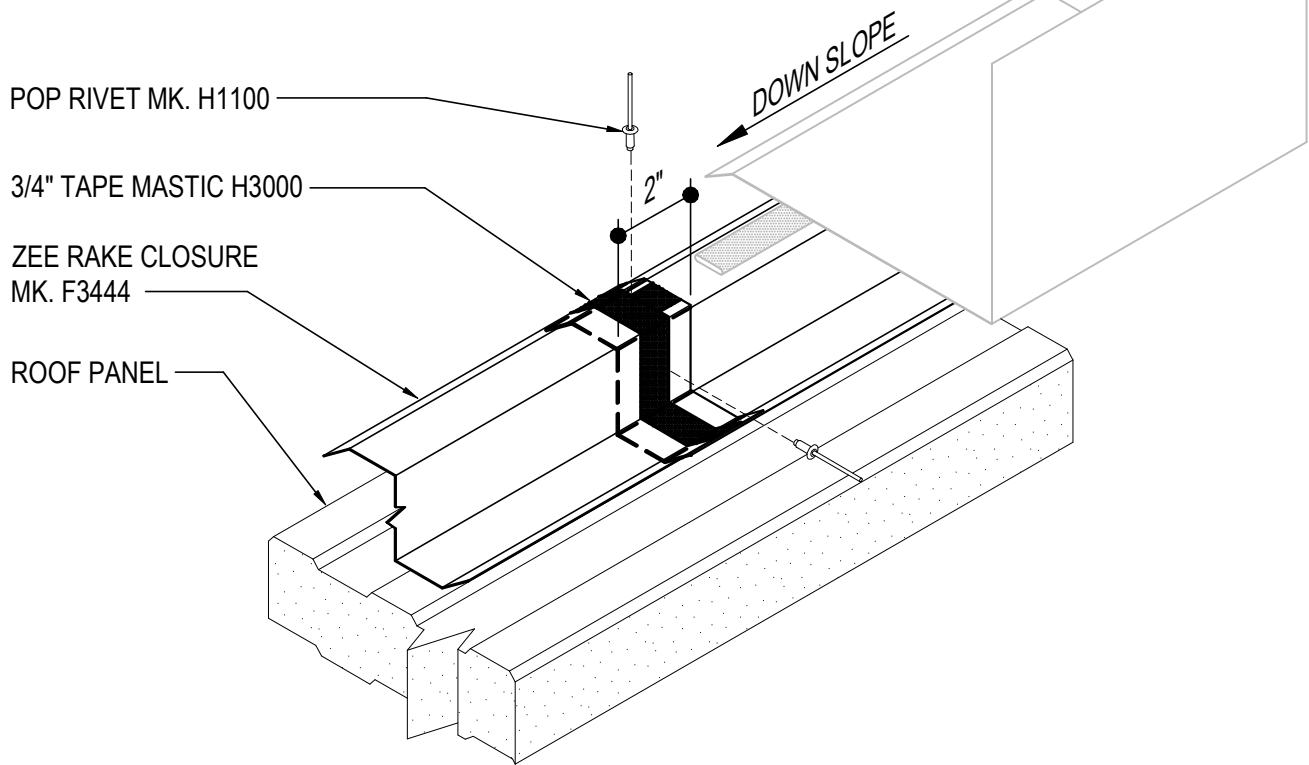

## ZEE RAKE CLOSURE LAP DETAIL

**EF8000**

Detailer Notes:

- 1) THIS DETAIL IS REQUIRED ON ALL JOBS WITH A PARAPET RAKE AND METL-SPAN ROOF.

EF8100 - RAKE PARAPET w/ WALL ABOVE

[Download the DWG file by clicking here.](#)

**PARAPET LAP & FLASHING BACKER**

SLIDE FIELD CUT SECTION OF FLASHING ENDLAP BACKER ONTO THE LOWER TRIM PIECE AS SHOWN BELOW. PLACE TAPE MASTIC NEXT TO HEM OF THE BACKER (NOT ON TOP OF HEM). FASTEN LAP WITH STITCH FASTENERS. ROOF STRUCTURAL FASTENERS SHOULD BE USED TO FASTEN THROUGH PANEL FLAT INTO RAKE ANGLE.

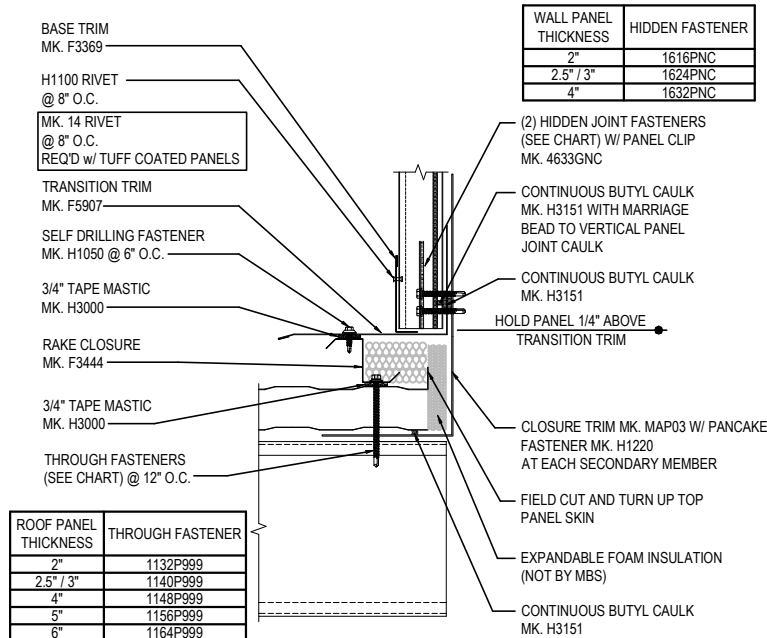
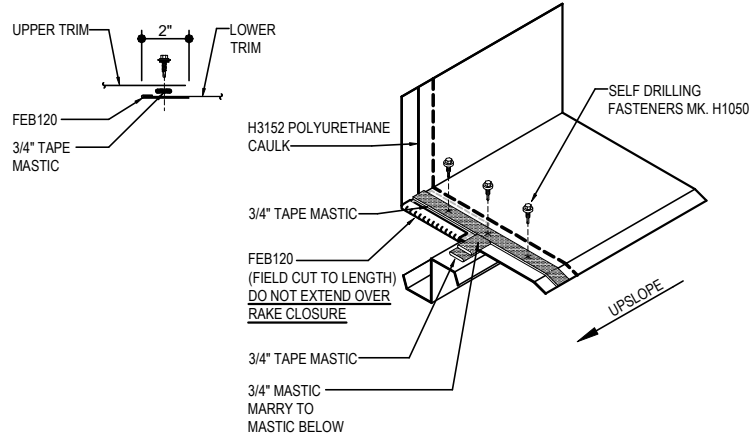

**RAKE PARAPET DETAIL**

WITH WALL PANEL ABOVE

EF8100

**Detailer Notes:**

1) N/A

EF8200 - RAKE PARAPET w/ WALL ABOVE & BELOW (RAFTER IN LOW BLDG.)

[Download the DWG file by clicking here.](#)

**PARAPET LAP & FLASHING BACKER**

SLIDE FIELD CUT SECTION OF FLASHING ENDLAP BACKER ONTO THE LOWER TRIM PIECE AS SHOWN BELOW. PLACE TAPE MASTIC NEXT TO HEM OF THE BACKER (NOT ON TOP OF HEM). FASTEN LAP WITH STITCH FASTENERS. ROOF STRUCTURAL FASTENERS SHOULD BE USED TO FASTEN THROUGH PANEL FLAT INTO RAKE ANGLE.

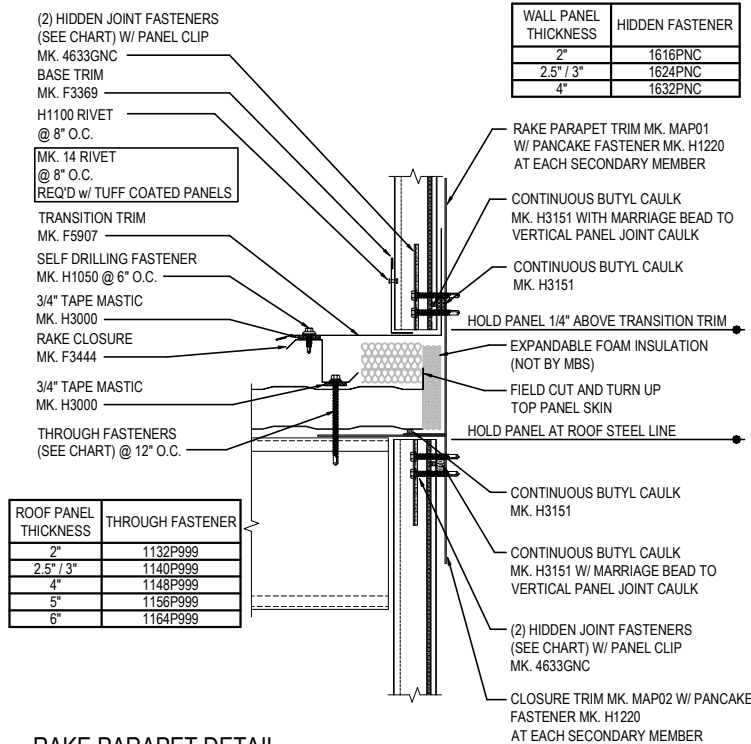
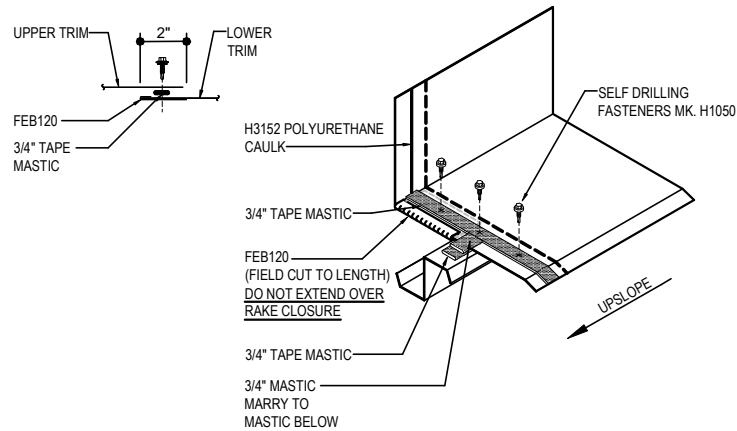

**RAKE PARAPET DETAIL**

WITH WALL PANEL ABOVE AND BELOW (RAFTER IN LOW BUILDING)

**EF8200**

**Detailer Notes:**

1) N/A

EF8300 - RAKE PARAPET w/ WALL ABOVE & BELOW (RAFTER IN HIGH BLDG.)

[Download the DWG file by clicking here.](#)

**PARAPET LAP & FLASHING BACKER**

SLIDE FIELD CUT SECTION OF FLASHING ENDLAP BACKER ONTO THE LOWER TRIM PIECE AS SHOWN BELOW. PLACE TAPE MASTIC NEXT TO HEM OF THE BACKER (NOT ON TOP OF HEM). FASTEN LAP WITH STITCH FASTENERS. ROOF STRUCTURAL FASTENERS SHOULD BE USED TO FASTEN THROUGH PANEL FLAT INTO RAKE ANGLE.

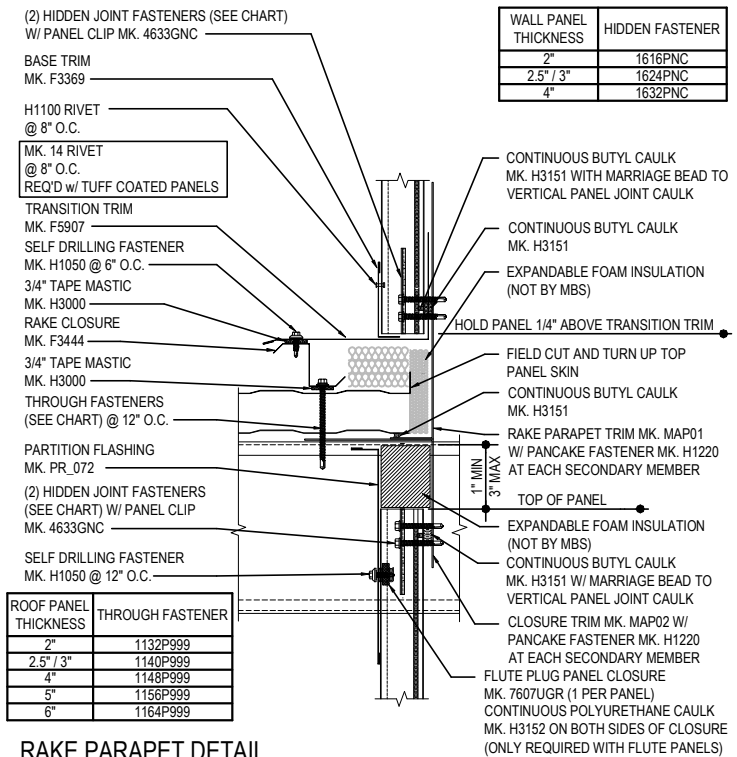
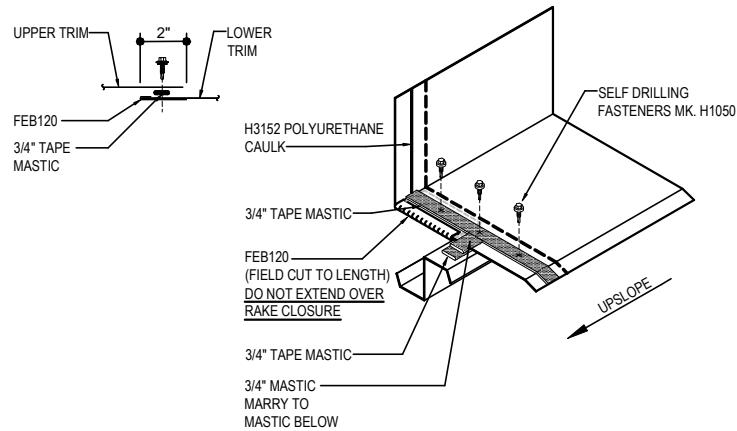

**RAKE PARAPET DETAIL**

WITH WALL PANEL ABOVE AND BELOW (RAFTER IN HIGH BUILDING)

**EF8300**

**Detailer Notes:**

1) N/A

EF8400 - RAKE PARAPET AT MASONRY WALL

[Download the DWG file by clicking here.](#)

**PARAPET LAP & FLASHING BACKER**

SLIDE FIELD CUT SECTION OF FLASHING ENDLAP BACKER ONTO THE LOWER TRIM PIECE AS SHOWN BELOW. PLACE TAPE MASTIC NEXT TO HEM OF THE BACKER (NOT ON TOP OF HEM). FASTEN LAP WITH STITCH FASTENERS. ROOF STRUCTURAL FASTENERS SHOULD BE USED TO FASTEN THROUGH PANEL FLAT INTO RAKE ANGLE.

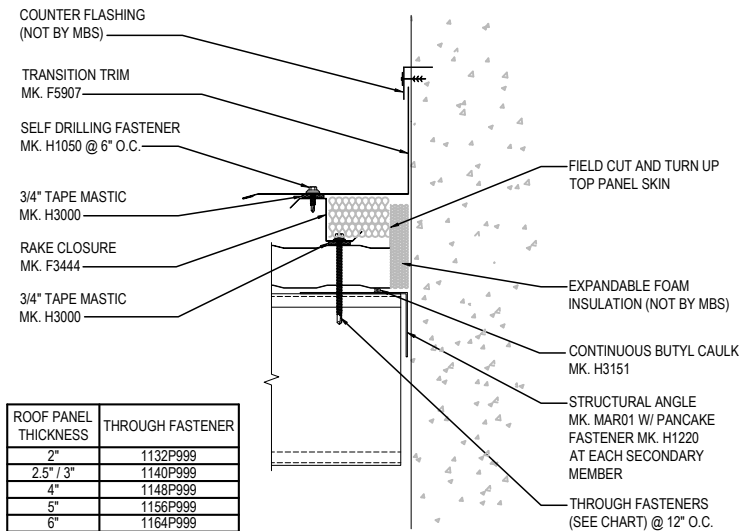
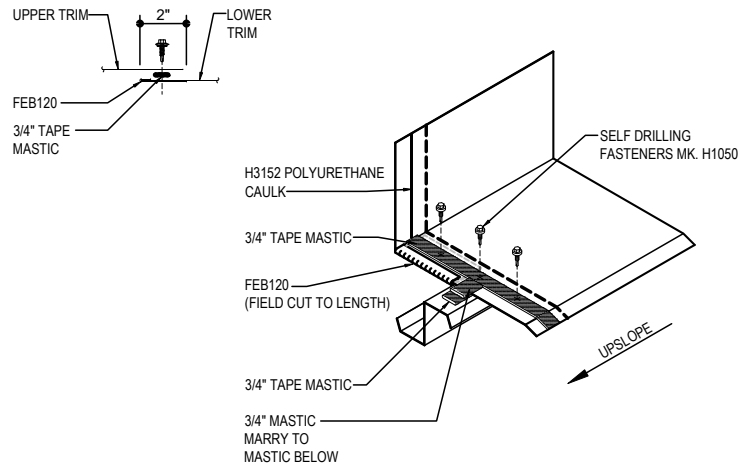

**RAKE PARAPET DETAIL**  
AT MASONRY WALL

**EF8400**

**Detailer Notes:**

1) N/A