

EM6020 - SS360/SSII ROOF

[Download the DWG file by clicking here.](#)

SS360/SS II TRANSLUCENT ROOF PANEL INSTALLATION INSTRUCTIONS

ERECTOR NOTE: THE DETAILS SHOWN ON THIS PAGE REFLECT LEFT-TO-RIGHT PANEL ERECTION SEQUENCE. IF THE PANELS ARE BEING INSTALLED FROM RIGHT-TO-LEFT, THE DETAILS ARE OPPOSITE HAND OF WHAT IS SHOWN.

TRANSLUCENT PANEL LAYOUT - PLAN VIEWS

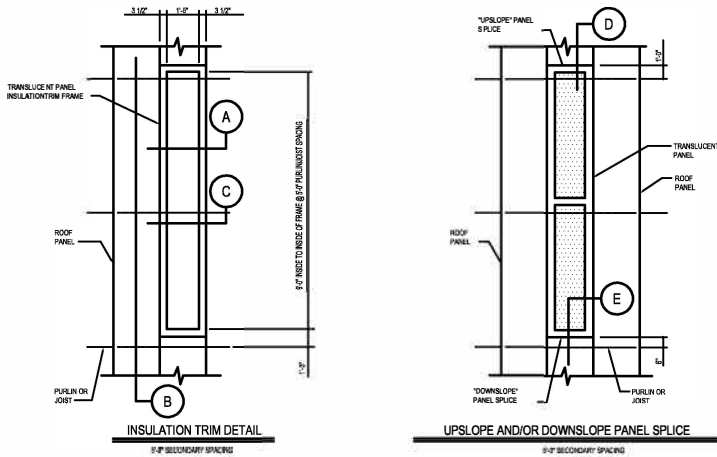

LEFT-TO-RIGHT
ERECTION SEQUENCE SHOWN

ERECTION NOTES:

- 1) INSTALL METAL ROOF PANELS UP TO THE TRANSLUCENT PANEL LOCATION.
- 2) PRE-ASSEMBLE INSULATION TRIM FRAMES SHOWN IN THE DETAILS BELOW.
- 3) PLACE FRAME ON TOP OF THE ROOF INSULATION. USE DIMENSIONS BELOW TO PROPERLY LOCATE FRAME ON THE PURLIN/JOIST.
- 4) ATTACH THE FRAME TO PURLIN WITH (4) #4 X 1 1/4 SDH4 HYD2 OR JOIST WITH (6) #3 X 1 1/4 SDH4 HY2PS.
- 5) REMOVE THE FIBERGLASS INSULATION FROM THE BACKING INSIDE THE FRAME AREA.
- 6) MAKE AN X CUT IN THE LINERS AS SHOWN.
- 7) FASTEN INSULATION BACKING TO FRAME USING DOUBLE FACED TAPE (BY OTHERS).

NEVER STEP, STAND, OR APPLY WEIGHT TO TRANSLUCENT PANELS

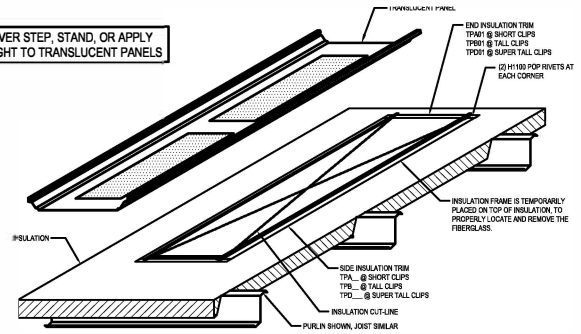

GENERAL NOTES:

- 1) END TO END TRANSLUCENT PANELS SHOULD BE SPACED SUCH THAT THE METAL PANELS ABOVE, BETWEEN AND BELOW ARE RESTING ON A MINIMUM OF (3) PURLINS, PREFERABLY (4). NO SIMPLE SPAN ROOF PANEL CONDITIONS ARE ALLOWED.
- 2) A MINIMUM OF (4) METAL PANELS IS REQUIRED BETWEEN SIDES OF MULTIPLE TRANSLUCENT PANEL LOCATIONS. TRANSLUCENT PANELS SHALL NOT BE PLACED SIDE BY SIDE.
- 3) TRANSLUCENT PANELS SHALL NOT BE PLACED FROM EAVE TO EAVE.
- 4) TRANSLUCENT PANELS SHALL NOT BE PLACED AT THE LOW EAVE OF THE BUILDING.
- 5) THE LOCATION OF THE FIRST TRANSLUCENT PANEL FROM THE LOW EAVE SHOULD BE SET SUCH THAT THE LOW EAVE METAL PANEL IS SUPPORTED BY (4) PURLINS OR APPROXIMATELY 15 FEET.
- 6) UL 96 RATING & FLORIDA APPROVAL FOR TRANSLUCENT PANELS IS ONLY AVAILABLE WITH 9-0\"/>

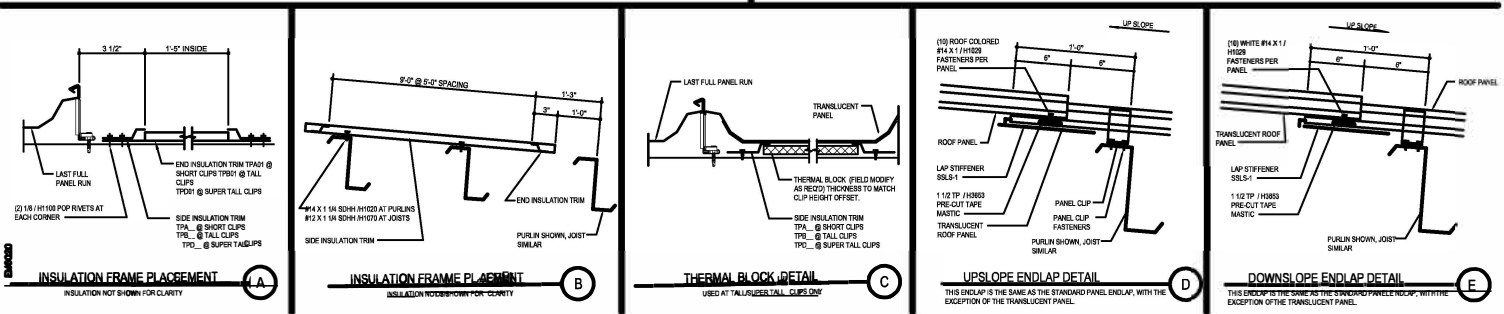

Detailer Notes:

- 1) DETAIL IS USED FOR ALL SS360/SSII RATED OR NON-RATED JOBS.