

**CURB DETAILS**

EN8000-SINGLE ROOF CURB WITH SUPPORT FRAMING

EN8010-DOUBLE ROOF CURB

EN8020-LIGHTWEIGHT ROOF CURB SUPPORT INSTALLATION

EN8030-LIGHTWEIGHT ROOF CURB

---



NUCOR®

STANDARD and LIGHTWEIGHT CURB DETAILS

BUILDINGS GROUP

INSULATED ROOF SHEETING

EN8010 - DOUBLE ROOF CURB

[Download the DWG file by clicking here.](#)

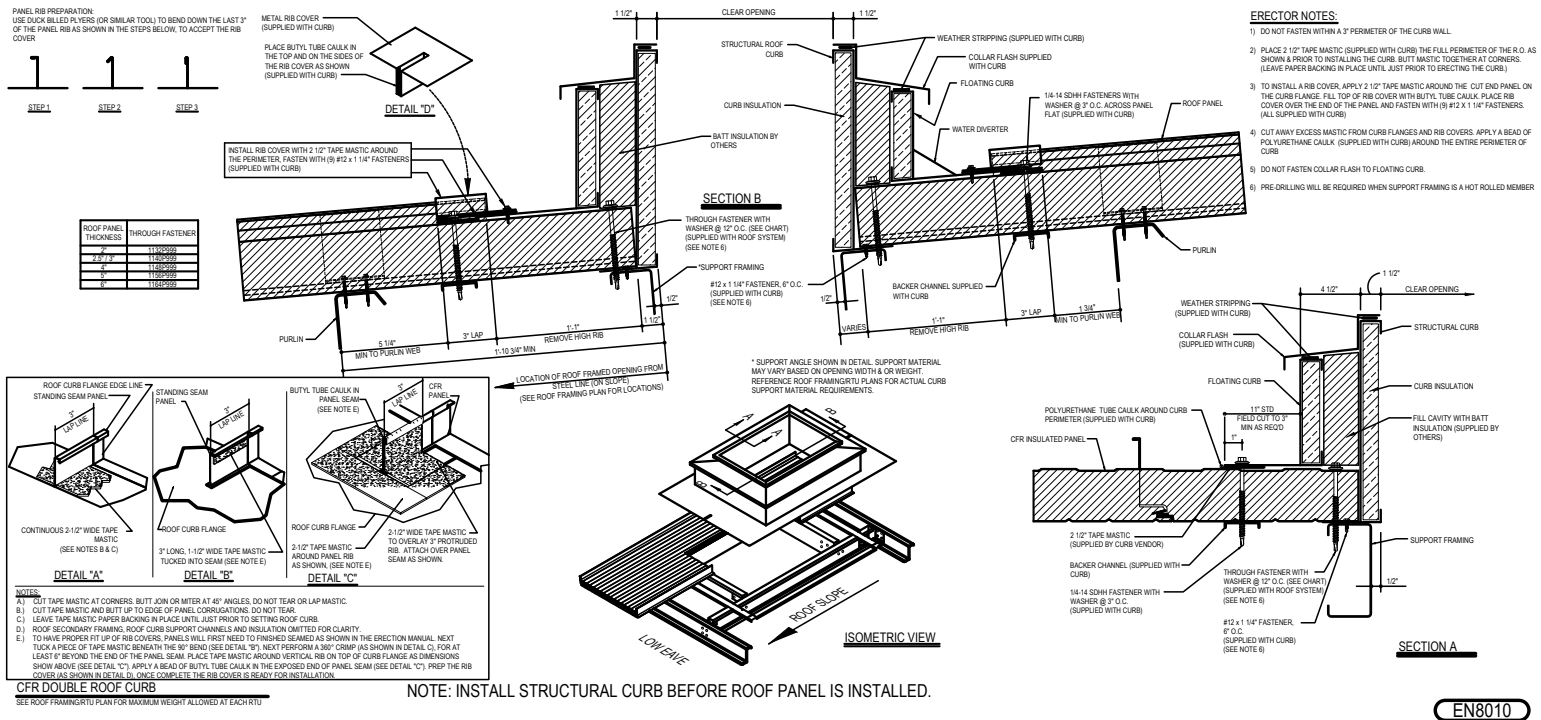

Detailer Notes:

1) N/A

EN8020 - LIGHTWEIGHT ROOF CURB SUPPORT INSTALLATION

[Download the DWG file by clicking here.](#)

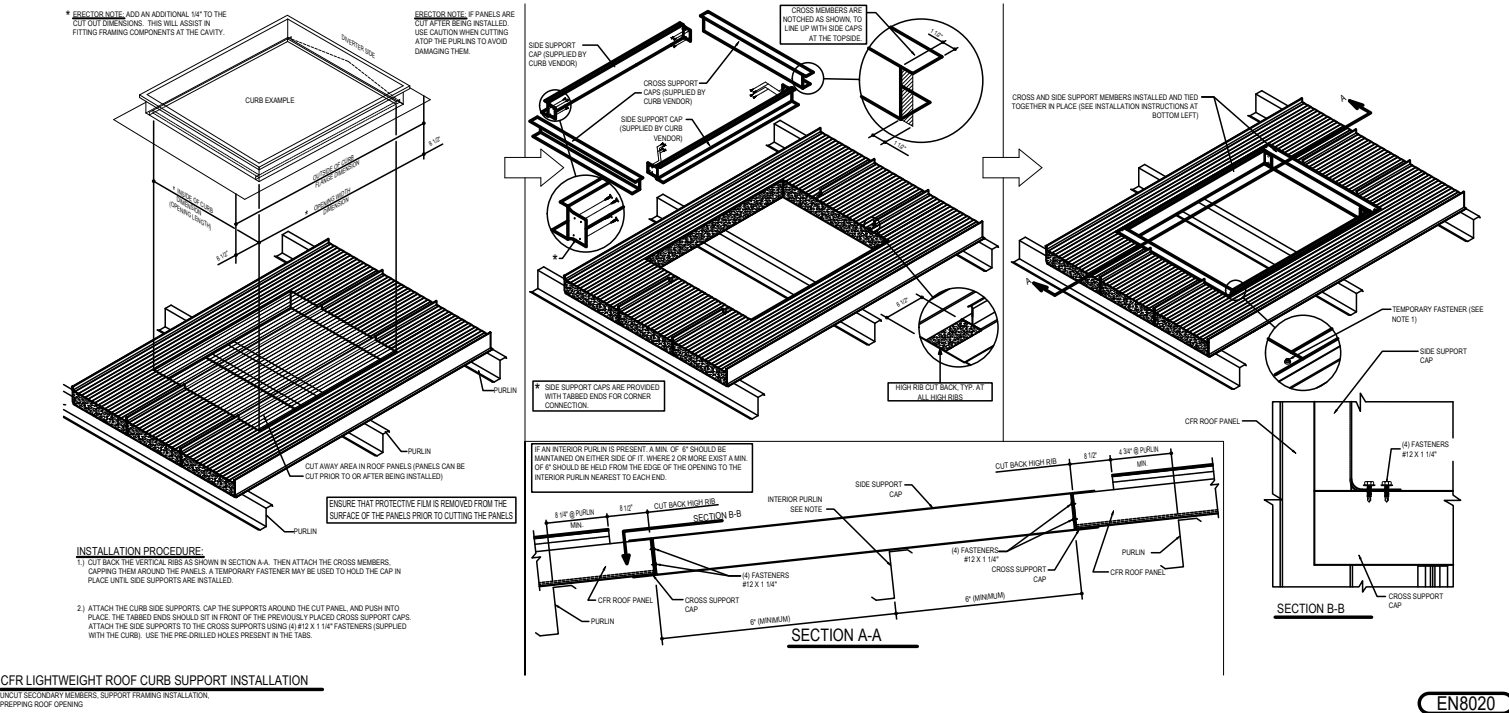

Detailer Notes:

1) N/A

### EN8030 - LIGHTWEIGHT ROOF CURB

Download the DWG file by clicking here.

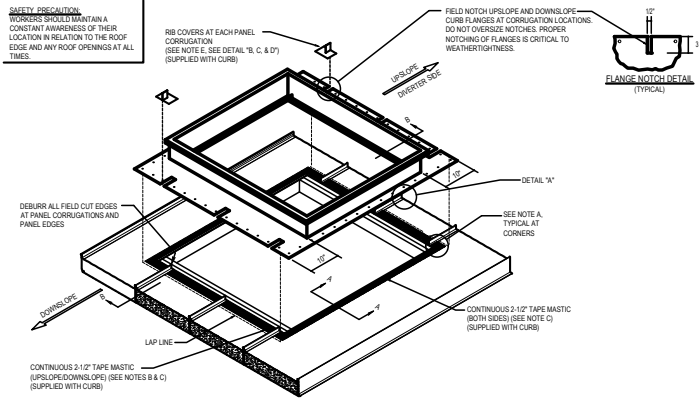

#### INSTALLATION PROCEDURES:

- 1) PRIOR TO INSTALLING CURB, MARK A 3\"/>

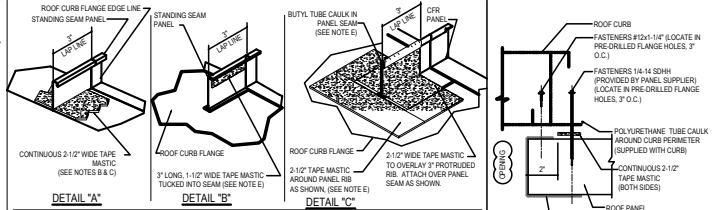

#### NOTES:

- A) CUT TAPE MASTIC AT CORNERS, BUTT JOIN OR MITER AT 45° ANGLES. DO NOT TEAR OR LAP MASTIC.
- B) CUT TAPE MASTIC AND BUTT UP TO EDGE OF PANEL CORRUGATIONS. DO NOT TEAR.
- C) LEAVE TAPE MASTIC PAPER BACKING IN PLACE UNTIL JUST PRIOR TO SETTING ROOF CURB.
- D) ROOF SECONDARY FRAMING, ROOF CURB SUPPORT CHANNELS AND INSULATION OMITTED FOR CLARITY.
- E) TO HAVE PROPER FIT UP OF RIB COVERS, PANELS WILL FIRST NEED TO BE FINISHED SEALED AS SHOWN IN THE DIRECTION MANUAL. NEXT TUCK A PIECE OF TAPE MASTIC BENEATH THE 10\"/>

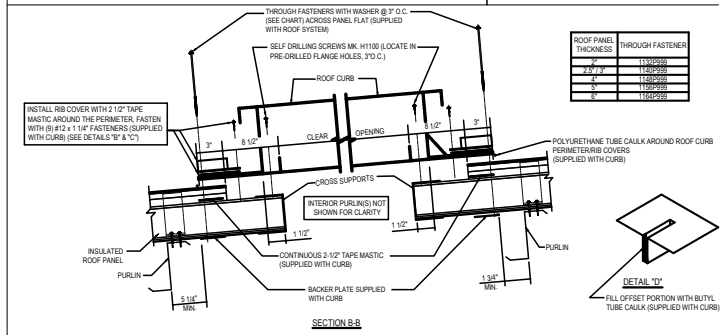

ROOF PANEL THICKNESS	THROUGH FASTENER
2"	1132P999
2 5/8"	1140P999
4"	1148P999
5"	1156P999
6"	1164P999

- INSTALL RIB COVER WITH 2 1/2\"/>

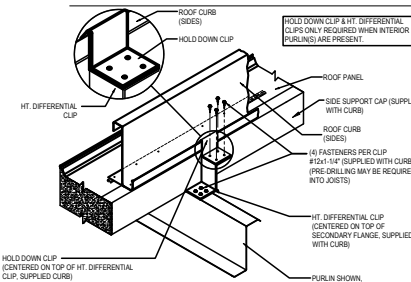

#### DETAIL 'E'

**LIGHTWEIGHT ROOF CURB INSTALLATION**  
UPPER ROOF  
FOR USE WITH PRISMATIC DOMES AND PRISMATIC SMOKE VENTS ONLY

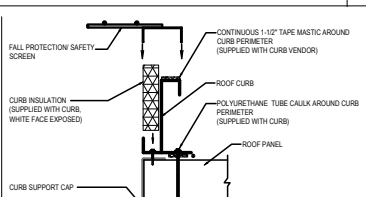

#### FALL PROTECTION / SAFETY SCREEN INSTALLATION:

- 1) AS REQUIRED, CUT CURB INSULATION TO LENGTH TO FIT AROUND THE INTERIOR PERIMETER OF ROOF CURB.
- 2) PLACE CURB INSULATION INTO BOTTOM CURB SLOT WITH WHITE FACE EXPOSED.
- 3) TAPE ANY SEAMS WITH WHITE INSULATION TAPE (BY OTHERS).
- 4) INSTALL TAPE MASTIC CONTINUOUS ALONG TOP FLANGE OF CURB.
- 5) PLACE SAFETY SCREEN OVER CURB. **DO NOT PULL AWAY SAFETY SCREEN AT THIS STEP.**
- 6) TUCK THE CURB INSULATION INTO CHANNEL OF SAFETY SCREEN.
- 7) FULLY SEAT SAFETY SCREEN TO TOP OF CURB TO NEAR INSULATION.

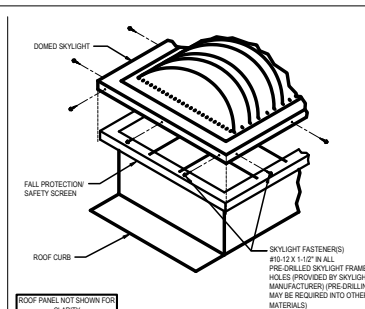

#### DOMED SKYLIGHT INSTALLATION:

- 1) HANDLE DOMED SKYLIGHT WITH CARE. INSIDE THE INSIDE OF THE UNIT IS CLEAR OF DEBRIS THROUGHOUT THE INSTALLATION PROCESS. DO NOT HIT SKYLIGHT FRAME WITH HAMMER OR ANY OTHER KIND OF Mallet. THIS MAY CAUSE THE WELDS TO SPLIT.
- 2) PROPERLY ELEVATE DOMED SKYLIGHT FROM FLAT SURFACES DURING STORAGE TO PREVENT HEAT BUILD-UP OR EXCESSIVE INTERNAL TEMPERATURES UNDER THE DOME. OTHERWISE DAMAGE CAN OCCUR TO INTERNAL COMPONENTS.
- 3) CAULKING THE TOP SIDE OF THE FALL PROTECTION/SAFETY SCREEN IS NOT REQUIRED. AN AIR SEAL TAPE IS PRE-MOUNTED TO THE UNDERSIDE OF THE SKYLIGHT.
- 4) SET DOMED SKYLIGHT OVER PREPARED CURB, MAKING SURE SKYLIGHT IS SQUARE AND EQUALLY SPACED ON ALL FOUR SIDES OF CURB.
- 5) ATTACH SKYLIGHT WITH PROVIDED SCREWS. BE SURE NOT TO DISTORT THE SKYLIGHT FRAME. DRIVE SCREWS JUST ENOUGH TO FLANGE. OVERTIGHTENING MAY CREATE FORCES WHICH MAY CRACK THE SKYLIGHT LENS.

#### DOMED SKYLIGHT CLEANING:

- 1) WHEN CLEANING LENS, USE ONLY WATER OR WATER WITH MILD SOAP. USE A SOFT BRUSH TO MINIMIZE THE SCRATCHING.
- 2) NEVER USE AMMONIA, ALCOHOL, AROMATIC OR PETROLEUM BASED PRODUCTS TO CLEAN LENS. THIS WILL CAUSE DETERIORATION AND/OR CRACKING OF THE LENS AND WILL VOID THE WARRANTY.

### Detailer Notes:

- 1) N/A