

HIGH EAVE DETAILS

FH2010 - HIGH EAVE WITH WALL PANELS

FH2612 - HIGH EAVE WITH INSULATED WALL PANELS

FH2010 - HIGH EAVE DETAIL WALL PANELS

[Download the DWG file by clicking here.](#)

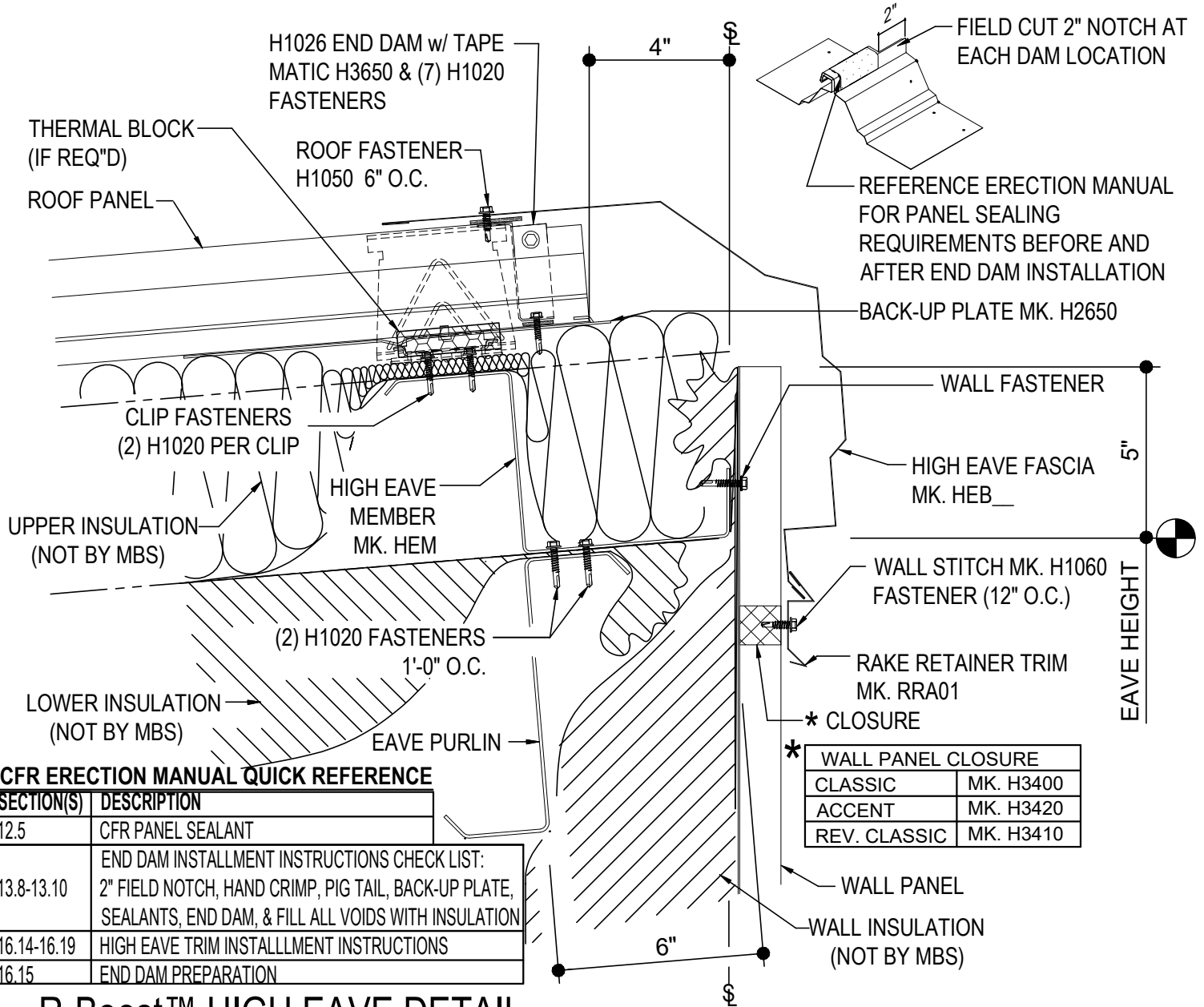

CFR ERECTION MANUAL QUICK REFERENCE

SECTION(S)	DESCRIPTION
12.5	CFR PANEL SEALANT
13.8-13.10	END DAM INSTALLMENT INSTRUCTIONS CHECK LIST: 2" FIELD NOTCH, HAND CRIMP, PIG TAIL, BACK-UP PLATE, SEALANTS, END DAM, & FILL ALL VOIDS WITH INSULATION
16.14-16.19	HIGH EAVE TRIM INSTALLMENT INSTRUCTIONS
16.15	END DAM PREPARATION

R-Boost™ HIGH EAVE DETAIL

HIGH EAVE DETAIL w/ WALL PANELS

FH2010

FH2612 - HIGH EAVE DETAIL W/ INSULATED WALL PANELS

[Download the DWG file by clicking here.](#)

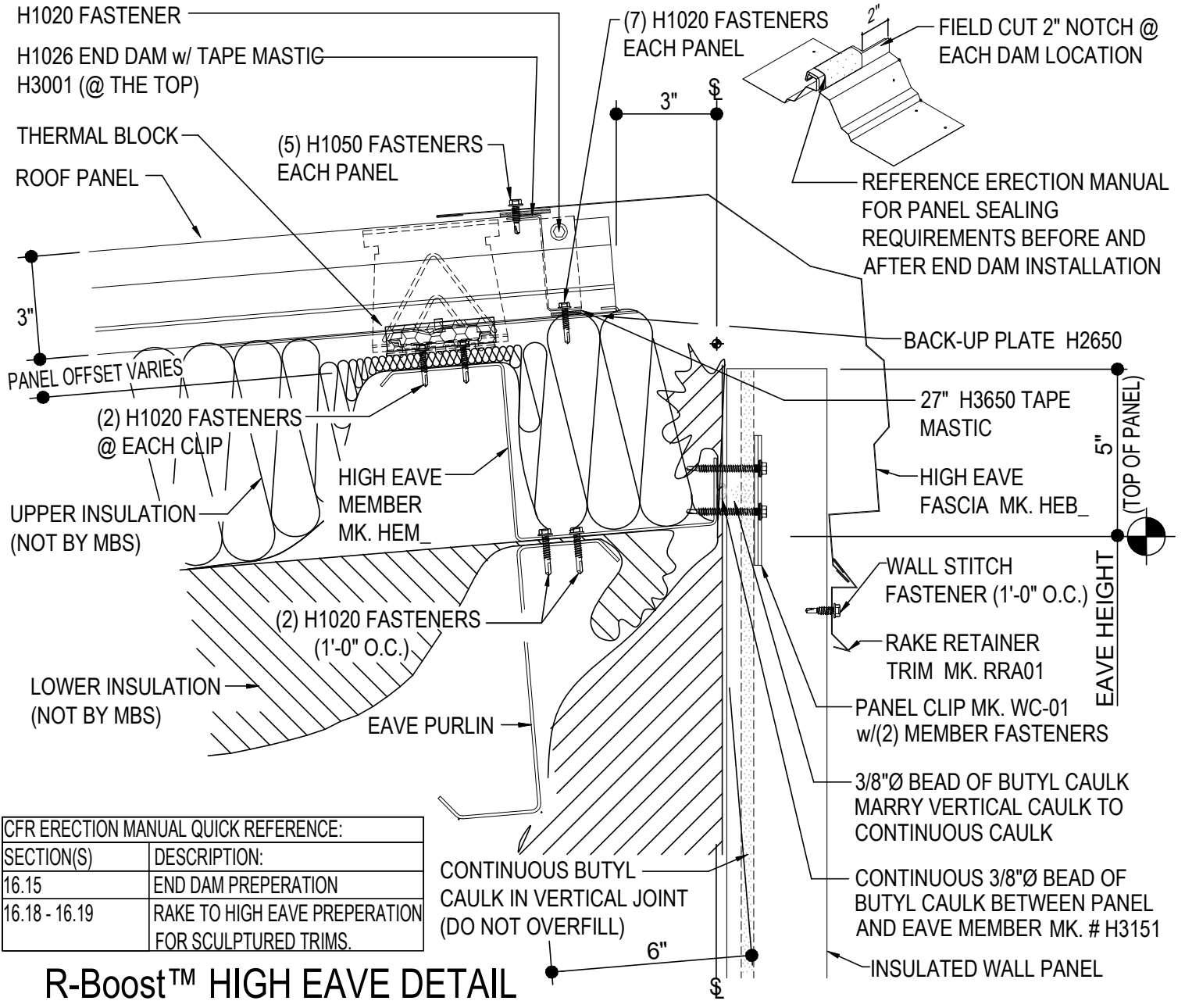

CFR ERECTION MANUAL QUICK REFERENCE:	
SECTION(S)	DESCRIPTION:
16.15	END DAM PREPERATION
16.18 - 16.19	RAKE TO HIGH EAVE PREPERATION FOR SCULPTURED TRIMS.

R-Boost™ HIGH EAVE DETAIL

HIGH EAVE DETAIL w/ INSULATED WALL PANELS

FH2612