

**GIRT BRACING**

CP0010 - GIRT BRACING ATTACHMENT METHODS

---

CP0010 - GIRT BRACING ATTACHMENT METHODS

[Download the DWG file by clicking here.](#)

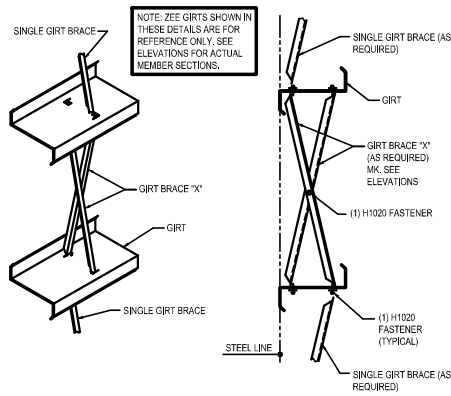

**INSTALLATION INSTRUCTIONS**

- 1) FOR SINGLE GIRT BRACE, INSERT ANGLE INTO THE FACTORY PUNCHED SLOTS, BEND TABS AS SHOWN AND FASTEN THROUGH TAB WITH (1) H1020 FASTENER PER END.
- 2) FOR GIRT BRACE "X", INSERT ANGLES "BACK-TO-BACK" INTO THE FACTORY PUNCHED SLOTS, BEND TABS AS SHOWN AND FASTEN THROUGH TAB WITH (1) H1020 FASTENER PER END.
- 3) CONNECT GIRT BRACE "X" AT THE ANGLE INTERSECTION WITH (1) H1020 FASTENER.
- 4) GIRT BRACING IS NOT TO DISTORT OR ALTER GIRTS FROM THEIR INTENDED SHAPE AND LOCATION.
- 5) SEE DETAILS BELOW FOR ADDITIONAL INFORMATION WHEN ATTACHING TO ALTERNATE FRAMING MEMBERS.

**PLAN VIEW OF (2) GIRT BRACING ROWS PER BAY**

- 1) INSTALL (2) REQUIRED ROWS OF GIRT BRACING REGARDLESS OF THE BAY LENGTH. GIRT BRACING IS SPACED AS SHOWN IN THE DETAIL BELOW.
- 2) SEE WALL ELEVATION(S) FOR GIRT BRACING MARK NUMBERS, QUANTITIES AND LOCATIONS.

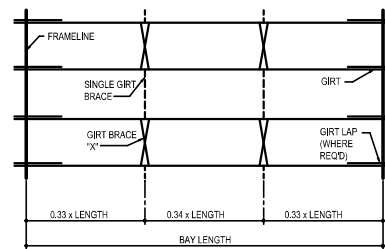

**PLAN VIEW OF (3) GIRT BRACING ROWS PER BAY**

- 1) INSTALL (3) REQUIRED ROWS OF GIRT BRACING REGARDLESS OF THE BAY LENGTH. GIRT BRACING IS SPACED AS SHOWN IN THE DETAIL BELOW.
- 2) SEE WALL ELEVATION(S) FOR GIRT BRACING MARK NUMBERS, QUANTITIES AND LOCATIONS.

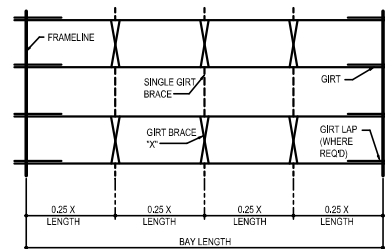

**PLAN VIEW OF (4) GIRT BRACING ROWS PER BAY**

- 1) INSTALL (4) REQUIRED ROWS OF GIRT BRACING REGARDLESS OF THE BAY LENGTH. GIRT BRACING IS SPACED AS SHOWN IN THE DETAIL BELOW.
- 2) SEE WALL ELEVATION(S) FOR GIRT BRACING MARK NUMBERS, QUANTITIES AND LOCATIONS.

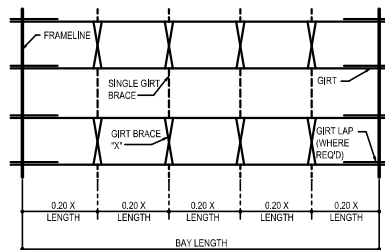

**GIRT BRACING ATTACHMENT METHODS**

CP0010

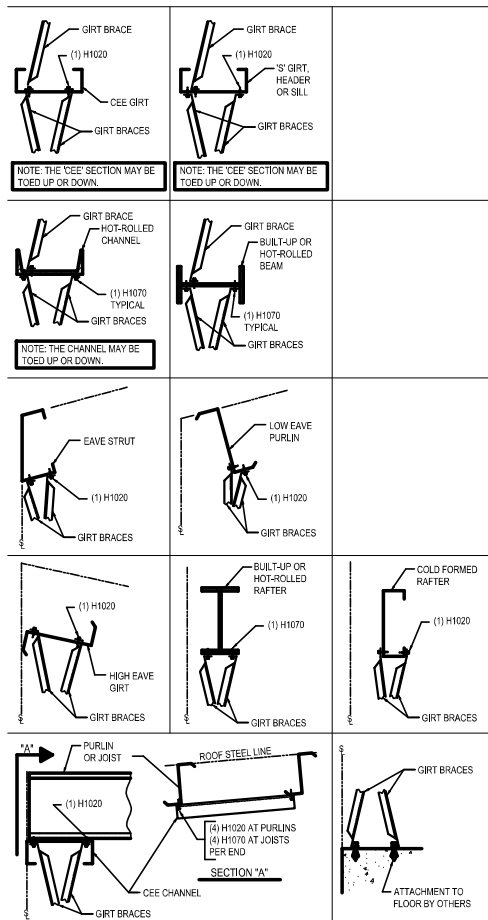

**Detailer Notes:**

- 1) N/A