

**RAKE (SCULPTURED)**

EE8000-ZEE RAKE CLOSURE LAP DETAIL

EE8100-RAKE (SCULPTURED)

---

EE8000 - ZEE RAKE CLOSURE LAP DETAIL

[Download the DWG file by clicking here.](#)

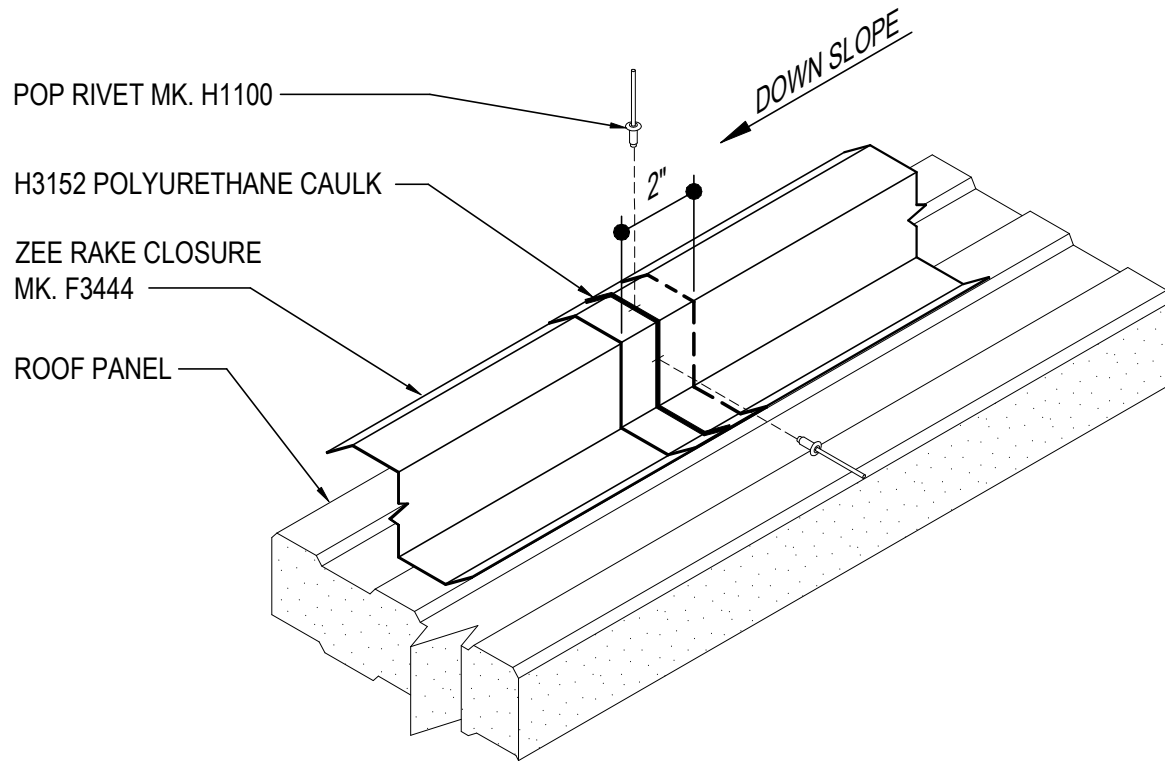

**ZEE RAKE CLOSURE LAP DETAIL**

**EE8000**

Detailer Notes:

- 1) THIS DETAIL IS REQUIRED ON ALL JOBS WITH A METL-SPAN ROOF

EE8100 - RAKE (SCULPTURED)

[Download the DWG file by clicking here.](#)

**RAKE LAP & FLASHING BACKER**

SLIDE FIELD CUT SECTION FLASHING ENDLAP BACKER ONTO THE LOWER TRIM PIECE. PLACE TAPE MASTIC NEXT TO HEM OF THE BACKER (NOT ON TOP OF HEM). APPLY CONTINUOUS BEAD OF CAULK 1" FROM END OF TRIM DOWN PROFILE OF TRIM. FASTEN LAP WITH STITCH FASTENERS AND POP RIVETS AS SHOWN.

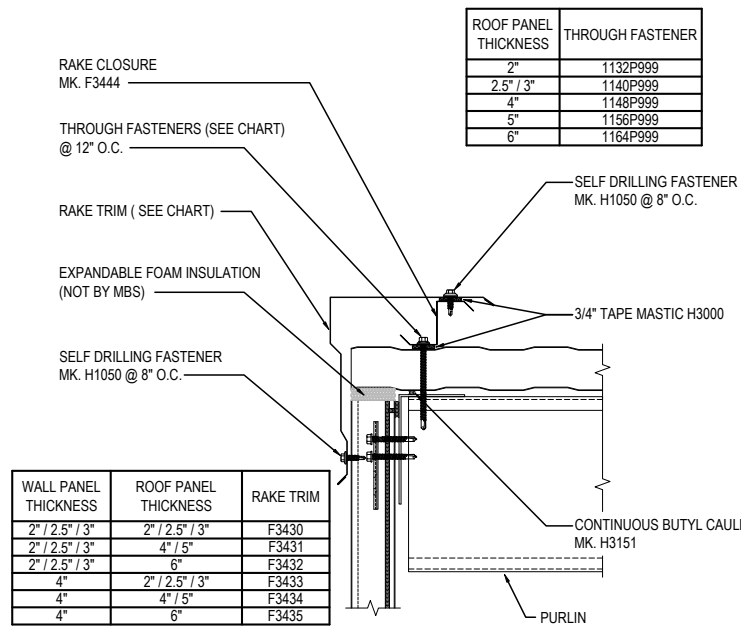
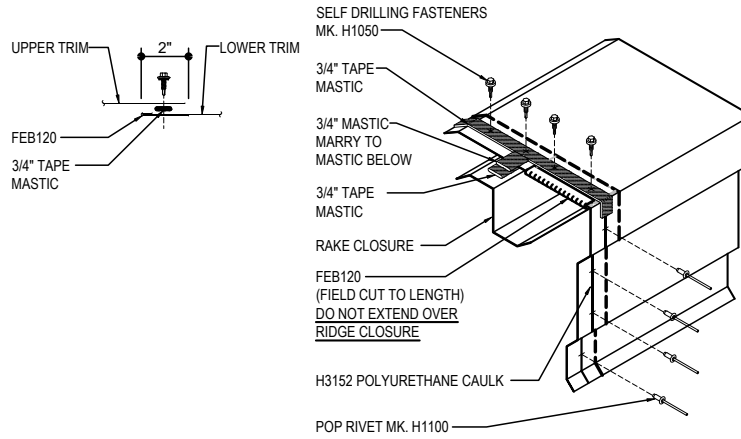

ROOF PANEL THICKNESS	THROUGH FASTENER
2"	1132P999
2.5" / 3"	1140P999
4"	1148P999
5"	1156P999
6"	1164P999

WALL PANEL THICKNESS	ROOF PANEL THICKNESS	RAKE TRIM
2" / 2.5" / 3"	2" / 2.5" / 3"	F3430
2" / 2.5" / 3"	4" / 5"	F3431
2" / 2.5" / 3"	6"	F3432
4"	2" / 2.5" / 3"	F3433
4"	4" / 5"	F3434
4"	6"	F3435

**RAKE DETAIL**

INSULATED METAL PANEL ROOF AT RAKE

**EE8100**

Detailer Notes:

- 1) N/A