

RAKE (PARAPET)

EF3010-RAKE PARAPET WALL ABOVE

EF3030-RAKE PARAPET MASONRY WALL

EF3050-RAKE PARAPET RAFTER IN HIGH BLDG

EF3060-RAKE PARAPET RAFTER IN LOW BLDG

EF3090-NON-STRUCTURAL PARAPET

EF3610-RAKE PARAPET INSULATED WALL ABOVE

EF3650-RAKE PARAPET INSULATED WALL ABOVE & BELOW

EF3690-NON-STRUCTURAL PARAPET - IMP WITH BACKER

EF3010 - RAKE PARAPET w/ WALL PANEL ABOVE

[Download the DWG file by clicking here.](#)

PARAPET LAP & FLASHING BACKER

SLIDE FIELD CUT SECTION OF FLASHING ENDLAP BACKER ONTO THE LOWER TRIM PIECE AS SHOWN BELOW. PLACE TAPE MASTIC NEXT TO HEM OF THE BACKER (NOT ON TOP OF HEM). FASTEN LAP WITH STITCH FASTENERS. ROOF STRUCTURAL FASTENERS SHOULD BE USED TO FASTEN THROUGH PANEL FLAT INTO RAKE ANGLE.

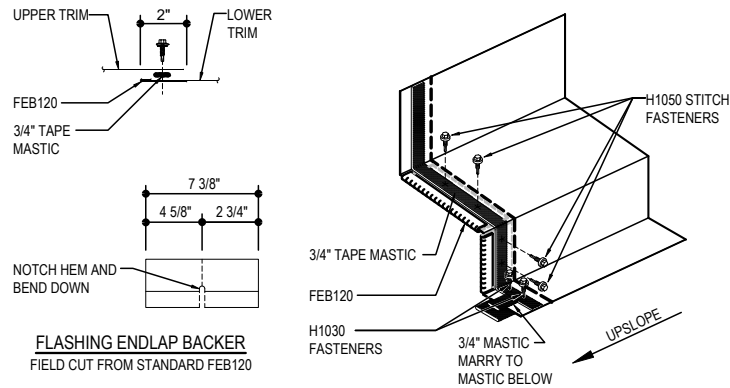

NOTE 1: KEEP FASTENERS 2" AWAY FROM RAKE CLIPS!!

NOTE 2: AS A STANDARD, PANELS WILL BE STEPPED IF ROOF SLOPE IS < 1/2:12
FIELD MITERING WILL BE REQUIRED IF ROOF SLOPE IS > 1/2:12

ERECTOR NOTE:
PLACE WALL FASTENERS THROUGH RAKE ANGLE ONLY. DO NOT PLACE WALL FASTENERS THROUGH RAKE PARAPET TRIM.

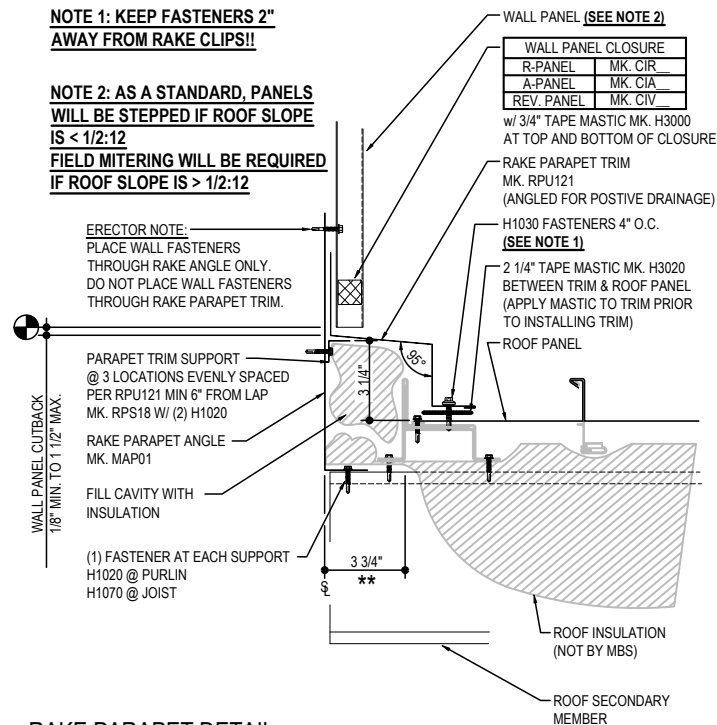

RAKE PARAPET DETAIL

RAKE PARAPET DETAIL w/ WALL PANELS
SEE WALL SHEETING ERECTION NOTES FOR WALL PANEL FASTENER LOCATIONS

EF3010

Detailer Notes:

1) N/A

EF3030 - RAKE PARAPET w/ WALL PANEL ABOVE

[Download the DWG file by clicking here.](#)

PARAPET LAP & FLASHING BACKER

SLIDE FIELD CUT SECTION OF FLASHING ENDLAP BACKER ONTO THE LOWER TRIM PIECE AS SHOWN BELOW. PLACE TAPE MASTIC NEXT TO HEM OF THE BACKER (NOT ON TOP OF HEM). FASTEN LAP WITH STITCH FASTENERS. ROOF STRUCTURAL FASTENERS SHOULD BE USED TO FASTEN THROUGH PANEL FLAT INTO RAKE ANGLE.

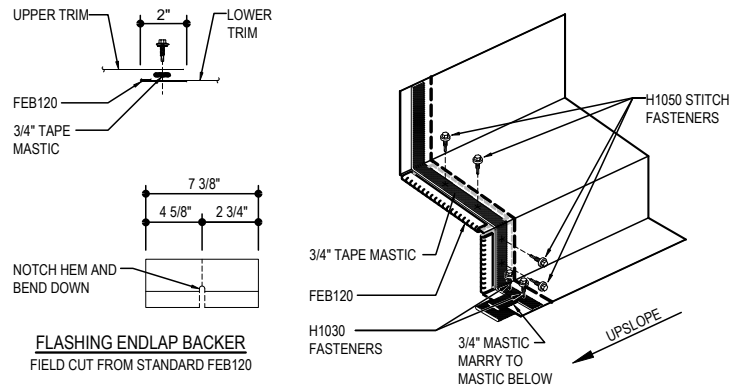

NOTE 1: KEEP FASTENERS 2" AWAY FROM RAKE CLIPS!!

ERECTOR NOTE:
DO NOT FASTEN RAKE PARAPET TRIM TO MASONRY WALL OR EXISTING BUILDING

3/4" TAPE MASTIC
MK. H3000

PARAPET TRIM SUPPORT
@ 3 LOCATIONS EVENLY SPACED
PER RPU121 MIN 6" FROM LAP
MK. RPS18 W/ (2) FASTENERS NOT
BY MBS

FILL CAVITY WITH
INSULATION

MASONRY WALL
(NOT BY MBS)

COUNTER FLASH
(NOT BY MBS)

RAKE PARAPET TRIM
MK. RPU121
(ANGLED FOR POSTIVE DRAINAGE)

H1030 FASTENERS 4" O.C.
(SEE NOTE 1)

2 1/4" TAPE MASTIC MK. H3020
BETWEEN TRIM & ROOF PANEL
(APPLY MASTIC TO TRIM PRIOR
TO INSTALLING TRIM)

ROOF PANEL

3 1/4"

3 1/4"

3 1/4"

3 1/4"

3 1/4"

3 1/4"

3 1/4"

3 1/4"

3 1/4"

3 1/4"

3 1/4"

3 1/4"

3 1/4"

3 1/4"

3 1/4"

3 1/4"

3 1/4"

3 1/4"

3 1/4"

3 1/4"

3 1/4"

3 1/4"

3 1/4"

3 1/4"

3 1/4"

3 1/4"

3 1/4"

3 1/4"

3 1/4"

3 1/4"

3 1/4"

3 1/4"

3 1/4"

3 1/4"

3 1/4"

3 1/4"

3 1/4"

3 1/4"

RAKE PARAPET DETAIL

RAKE PARAPET DETAIL w/ MASONRY WALL

EF3030

Detailer Notes:

1) N/A

EF3050 - RAKE PARAPET w/ RAFTER IN HIGH BUILDING

[Download the DWG file by clicking here.](#)

PARAPET LAP & FLASHING BACKER

SLIDE FIELD CUT SECTION OF FLASHING ENDLAP BACKER ONTO THE LOWER TRIM PIECE AS SHOWN BELOW. PLACE TAPE MASTIC NEXT TO HEM OF THE BACKER (NOT ON TOP OF HEM). FASTEN LAP WITH STITCH FASTENERS. ROOF STRUCTURAL FASTENERS SHOULD BE USED TO FASTEN THROUGH PANEL FLAT INTO RAKE ANGLE.

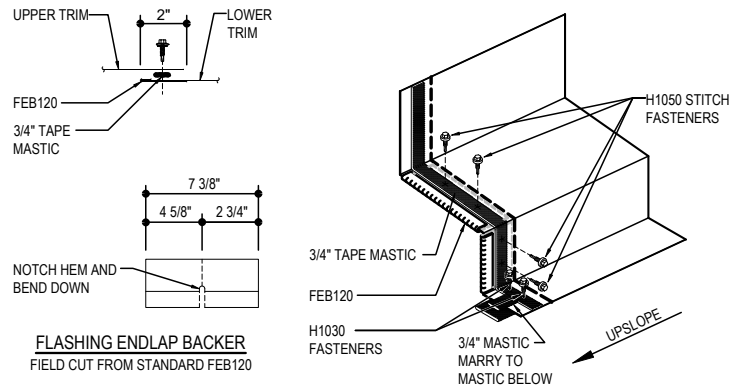

NOTE 1: KEEP FASTENERS 2" AWAY FROM RAKE CLIPS!!

NOTE 2: AS A STANDARD, PANELS WILL BE STEPPED IF ROOF SLOPE IS < 1/2:12. FIELD MITERING WILL BE REQUIRED IF ROOF SLOPE IS > 1/2:12

ERECTOR NOTE:
PLACE WALL FASTENERS THROUGH RAKE ANGLE ONLY. DO NOT PLACE WALL FASTENERS THROUGH RAKE PARAPET TRIM.

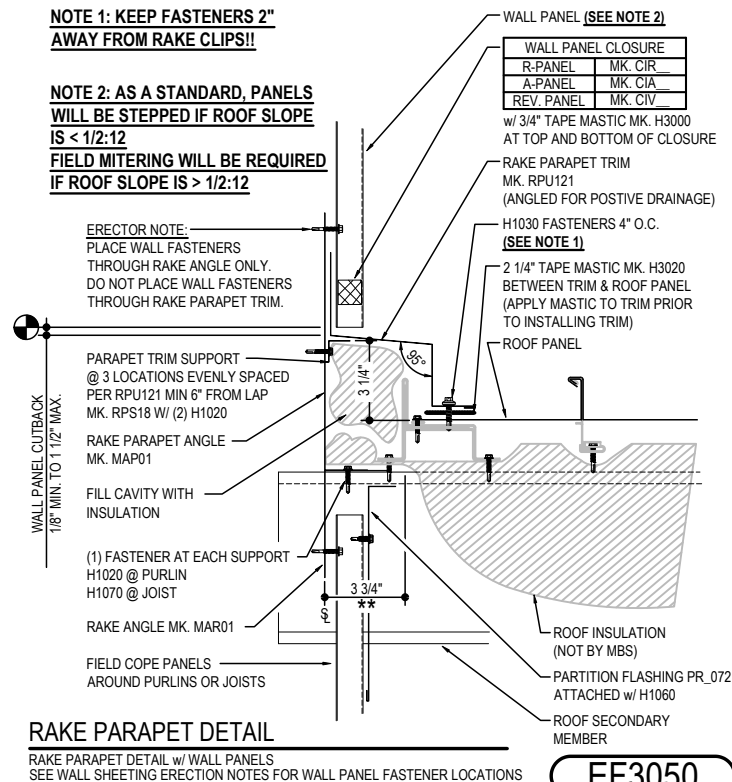

RAKE PARAPET DETAIL

RAKE PARAPET DETAIL w/ WALL PANELS
SEE WALL SHEETING ERECTION NOTES FOR WALL PANEL FASTENER LOCATIONS

EF3050

Detailer Notes:

1) N/A

EF3060 - RAKE PARAPET w/ RAFTER IN LOW BUILDING

[Download the DWG file by clicking here.](#)

PARAPET LAP & FLASHING BACKER

SLIDE FIELD CUT SECTION OF FLASHING ENDLAP BACKER ONTO THE LOWER TRIM PIECE AS SHOWN BELOW. PLACE TAPE MASTIC NEXT TO HEM OF THE BACKER (NOT ON TOP OF HEM). FASTEN LAP WITH STITCH FASTENERS. ROOF STRUCTURAL FASTENERS SHOULD BE USED TO FASTEN THROUGH PANEL FLAT INTO RAKE ANGLE.

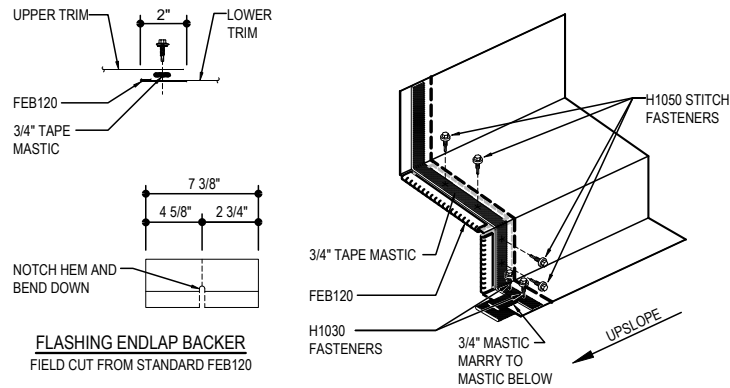

NOTE 1: KEEP FASTENERS 2" AWAY FROM RAKE CLIPS!!

NOTE 2: AS A STANDARD, PANELS WILL BE STEPPED IF ROOF SLOPE IS < 1/2:12. FIELD MITERING WILL BE REQUIRED IF ROOF SLOPE IS > 1/2:12

ERECTOR NOTE:
PLACE WALL FASTENERS THROUGH RAKE ANGLE ONLY. DO NOT PLACE WALL FASTENERS THROUGH RAKE PARAPET TRIM.

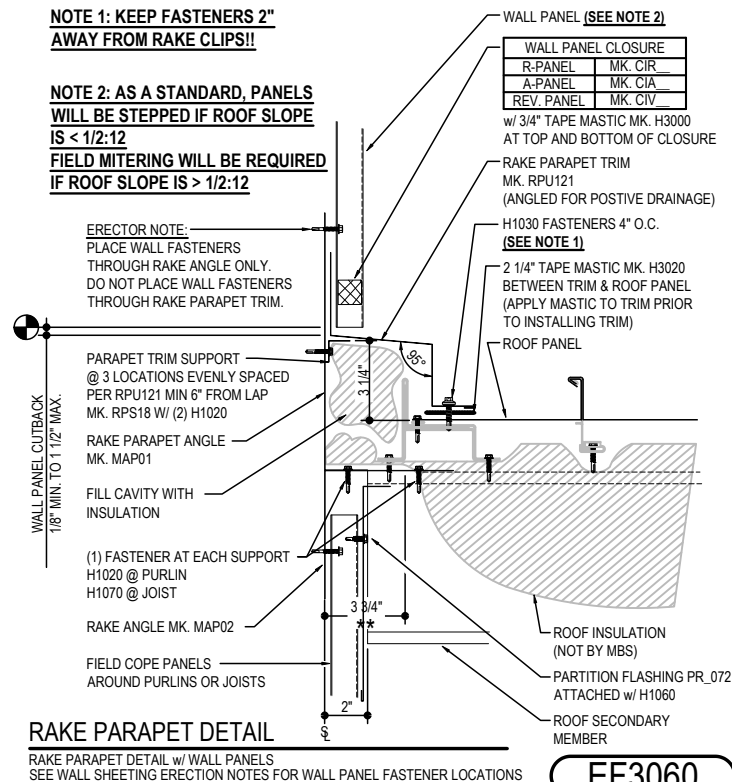

RAKE PARAPET DETAIL

RAKE PARAPET DETAIL w/ WALL PANELS
SEE WALL SHEETING ERECTION NOTES FOR WALL PANEL FASTENER LOCATIONS

EF3060

Detailer Notes:

1) N/A

EF3090 - NON-STRUCTURAL PARAPET

Download the DWG file by clicking [here](#).

PARAPET LAP & FLASHING BACKER

SLIDE FIELD CUT SECTION OF FLASHING ENDLAP BACKER ONTO THE LOWER TRIM PIECE AS SHOWN BELOW. PLACE TAPE MASTIC NEXT TO HEM OF THE BACKER (NOT ON TOP OF HEM). FASTEN LAP WITH STITCH FASTENERS. ROOF STRUCTURAL FASTENERS SHOULD BE USED TO FASTEN THROUGH PANEL FLAT INTO RAKE ANGLE.

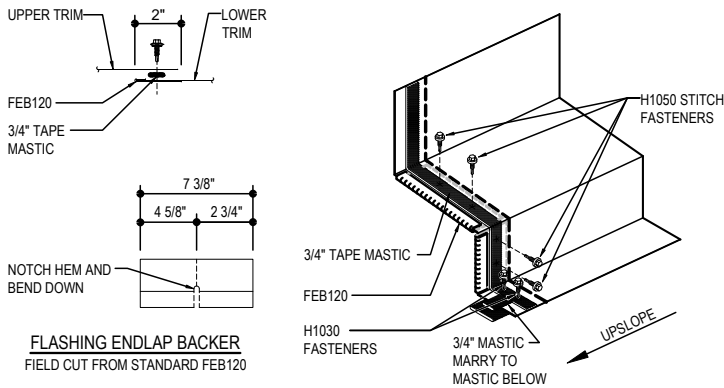

CAP TRIM LAP

APPLY CONTINUOUS BEAD OF CAULK 1" FROM END OF TRIM DOWN PROFILE OF TRIM. FASTEN LAP WITH POP RIVETS AS SHOWN.

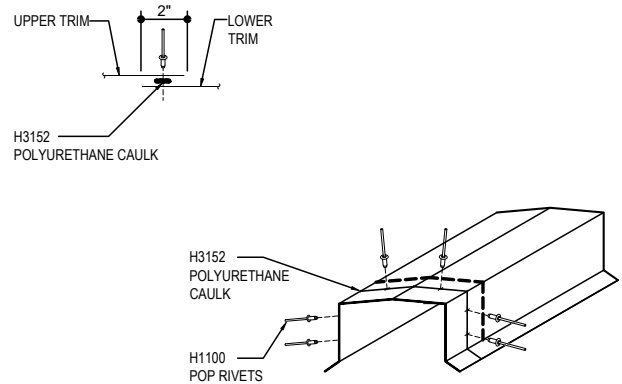

NOTE 1: KEEP FASTENERS 2" AWAY FROM RAKE CLIPS!!

NOTE 2: AS A STANDARD, PANELS WILL BE STEPPED IF ROOF SLOPE IS < 1/2:12
FIELD MITERING WILL BE REQUIRED IF ROOF SLOPE IS > 1/2:12

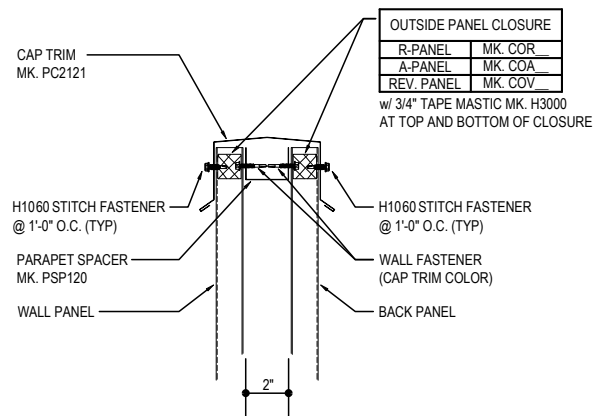
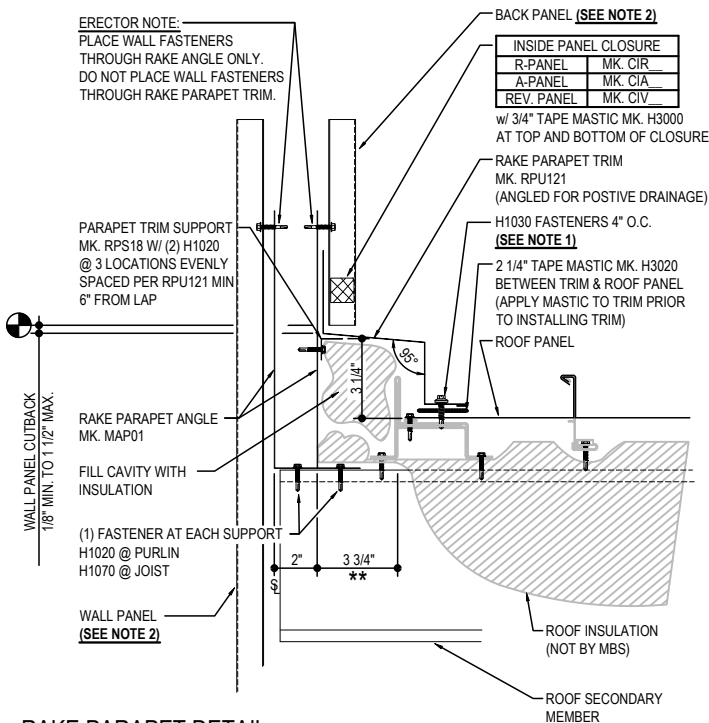

RAKE PARAPET DETAIL

RAKE PARAPET DETAIL w/ WALL PANELS
SEE WALL SHEETING ERECTION NOTES FOR WALL PANEL FASTENER LOCATIONS

EF3090

Detailer Notes:

- 1) PANEL CLOSURES ARE ALWAYS REQUIRED AS A STANDARD AT THE BACK PANEL.
- 2) OUTSIDE WALL PANEL CLOSURES ARE OPTIONAL ON EXTERIOR PANEL. TURN OFF OUTSIDE CLOSURE LAYER IF NOT REQUIRED.

EF3610 - RAKE PARAPET w/ INSULATED WALL PANEL ABOVE

[Download the DWG file by clicking here.](#)

PARAPET LAP & FLASHING BACKER

SLIDE FIELD CUT SECTION OF FLASHING ENDLAP BACKER ONTO THE LOWER TRIM PIECE AS SHOWN BELOW. PLACE TAPE MASTIC NEXT TO HEM OF THE BACKER (NOT ON TOP OF HEM). FASTEN LAP WITH STITCH FASTENERS. ROOF STRUCTURAL FASTENERS SHOULD BE USED TO FASTEN THROUGH PANEL FLAT INTO RAKE ANGLE.

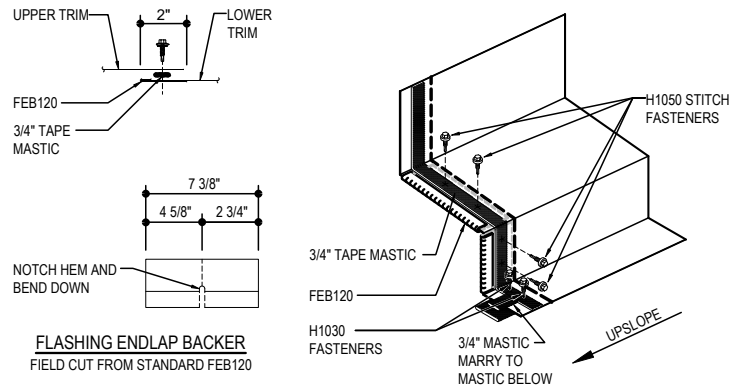

NOTE 1: KEEP FASTENERS 2" AWAY FROM RAKE CLIPS!!

NOTE 2: AS A STANDARD, PANELS WILL BE STEPPED IF ROOF SLOPE IS < 1/2:12. FIELD MITERING WILL BE REQUIRED IF ROOF SLOPE IS > 1/2:12

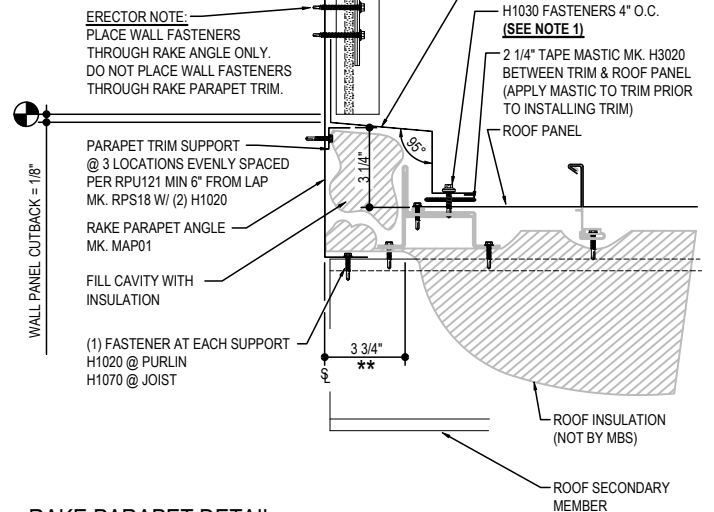

RAKE PARAPET DETAIL

RAKE PARAPET DETAIL w/ INSULATED WALL PANELS
SEE INSULATED WALL SHEETING ERECTION DETAILS FOR INSTALLATION INSTRUCTIONS.

EF3610

Detailer Notes:

- 1) N/A

EF3650 - RAKE PARAPET w/ INSULATED WALL PANEL ABOVE/BELOW

[Download the DWG file by clicking here.](#)

PARAPET LAP & FLASHING BACKER

SLIDE FIELD CUT SECTION OF FLASHING ENDLAP BACKER ONTO THE LOWER TRIM PIECE AS SHOWN BELOW. PLACE TAPE MASTIC NEXT TO HEM OF THE BACKER (NOT ON TOP OF HEM). FASTEN LAP WITH STITCH FASTENERS. ROOF STRUCTURAL FASTENERS SHOULD BE USED TO FASTEN THROUGH PANEL FLAT INTO RAKE ANGLE.

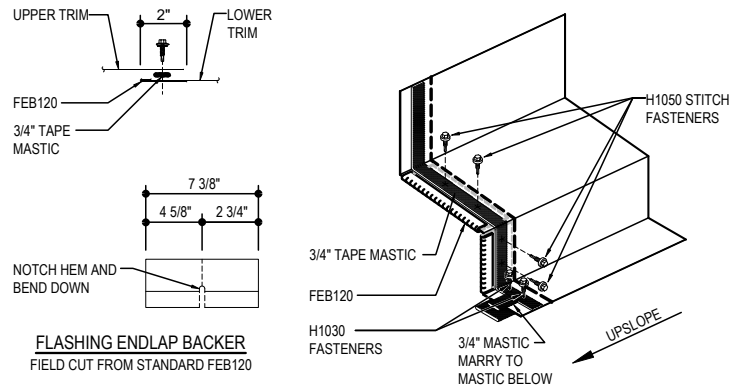

NOTE 1: KEEP FASTENERS 2" AWAY FROM RAKE CLIPS!!

NOTE 2: AS A STANDARD, PANELS WILL BE STEPPED IF ROOF SLOPE IS < 1/2:12. FIELD MITERING WILL BE REQUIRED IF ROOF SLOPE IS > 1/2:12

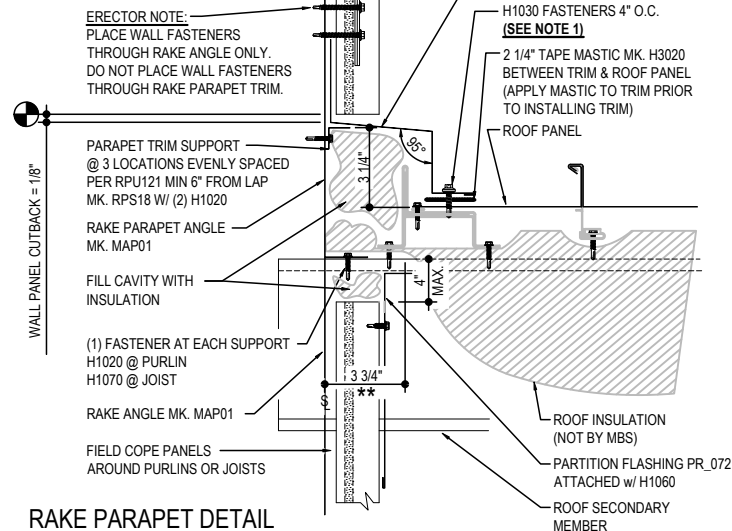

RAKE PARAPET DETAIL

RAKE PARAPET DETAIL w/ INSULATED WALL PANELS
SEE INSULATED WALL SHEETING ERECTION DETAILS FOR INSTALLATION INSTRUCTIONS.

EF3650

Detailer Notes:

1) N/A

EF3690 - NON-STRUCTURAL PARAPET - IMP WITH BACKER

[Download the DWG file by clicking here.](#)

PARAPET LAP & FLASHING BACKER

SLIDE FIELD CUT SECTION OF FLASHING ENLAP BACKER ONTO THE LOWER TRIM PIECE AS SHOWN BELOW. PLACE TAPE MASTIC NEXT TO HEM OF THE BACKER (NOT ON TOP OF HEM). FASTEN LAP WITH STITCH FASTENERS. ROOF STRUCTURAL FASTENERS SHOULD BE USED TO FASTEN THROUGH PANEL FLAT INTO RAKE ANGLE.

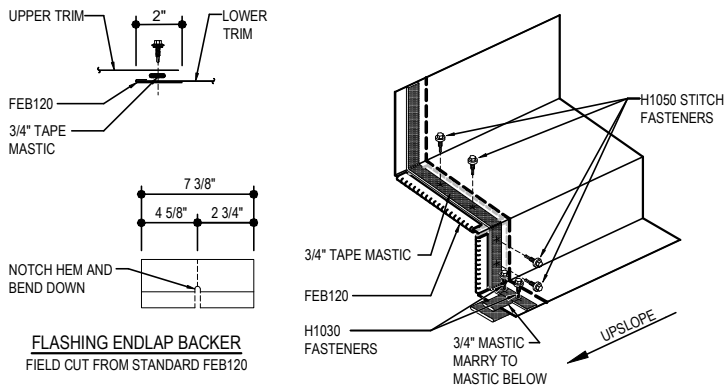

CAP TRIM LAP

APPLY CONTINUOUS BEAD OF CAULK 1" FROM END OF TRIM DOWN PROFILE OF TRIM. FASTEN LAP WITH STITCH FASTENERS AND POP RIVETS AS SHOWN.

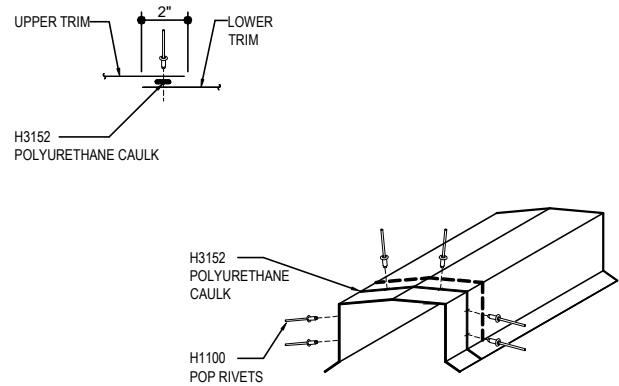

NOTE 1: KEEP FASTENERS 2" AWAY FROM RAKE CLIPS!!

NOTE 2: AS A STANDARD, PANELS WILL BE STEPPED IF ROOF SLOPE IS < 1/2:12. FIELD MITERING WILL BE REQUIRED IF ROOF SLOPE IS > 1/2:12

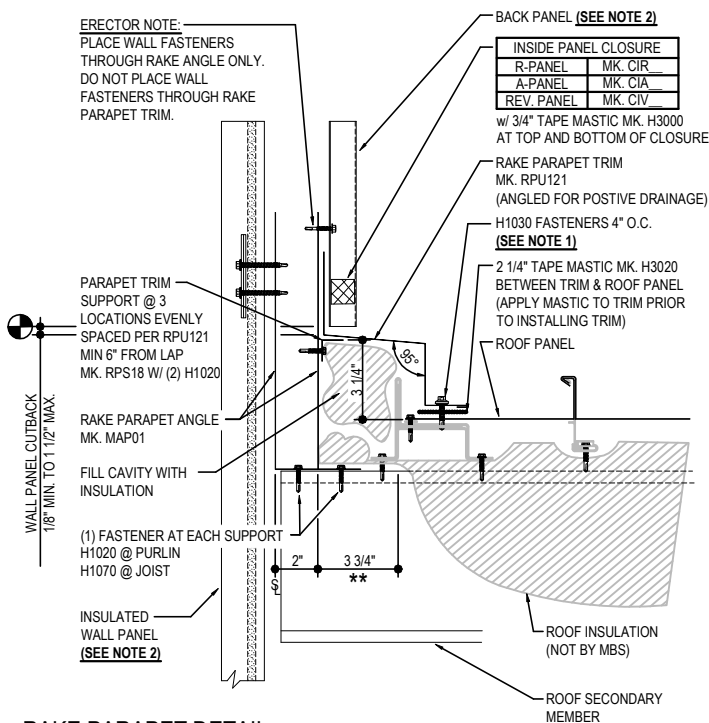

RAKE PARAPET DETAIL

RAKE PARAPET DETAIL w/ WALL PANELS
SEE WALL SHEETING ERECTION NOTES FOR WALL PANEL FASTENER LOCATIONS

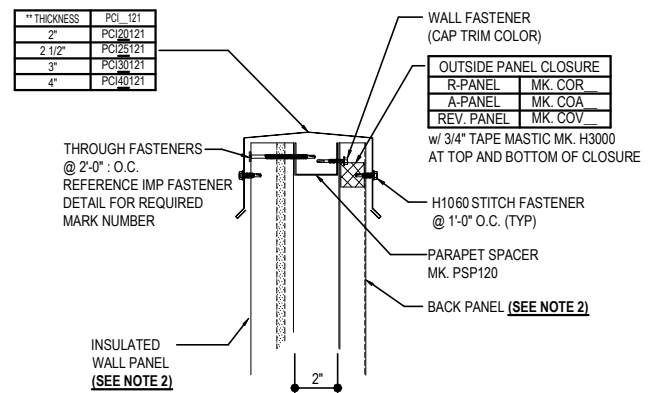

EF3690

Detailer Notes:

- 1) PANEL CLOSURES ARE ALWAYS REQUIRED AS A STANDARD AT THE BACK PANEL.
- 2) OUTSIDE WALL PANEL CLOSURES ARE OPTIONAL ON EXTERIOR PANEL. TURN OFF OUTSIDE CLOSURE LAYER IF NOT REQUIRED.