

**RAKE (PARAPET)**

EF6010-RAKE PARAPET WALL ABOVE

EF6030-RAKE PARAPET MASONRY WALL

EF6050-RAKE PARAPET RAFTER IN HIGH BLDG

EF6060-RAKE PARAPET RAFTER IN LOW BLDG

EF6090-NON-STRUCTURAL PARAPET

EF6610-RAKE PARAPET INSULATED WALL ABOVE

EF6650-RAKE PARAPET INSULATED WALL ABOVE & BELOW

EF6690-NON-STRUCTURAL PARAPET - IMP WITH BACKER

---

EF6010 - RAKE PARAPET w/ WALL PANEL ABOVE

[Download the DWG file by clicking here.](#)

## PARAPET LAP & FLASHING BACKER

SLIDE FIELD CUT SECTION OF FLASHING ENDLAP BACKER ONTO THE LOWER TRIM PIECE AS SHOWN BELOW. PLACE TAPE MASTIC NEXT TO HEM OF THE BACKER (NOT ON TOP OF HEM). FASTEN LAP WITH STITCH FASTENERS. ROOF STRUCTURAL FASTENERS SHOULD BE USED TO FASTEN THROUGH PANEL FLAT INTO RAKE ANGLE.

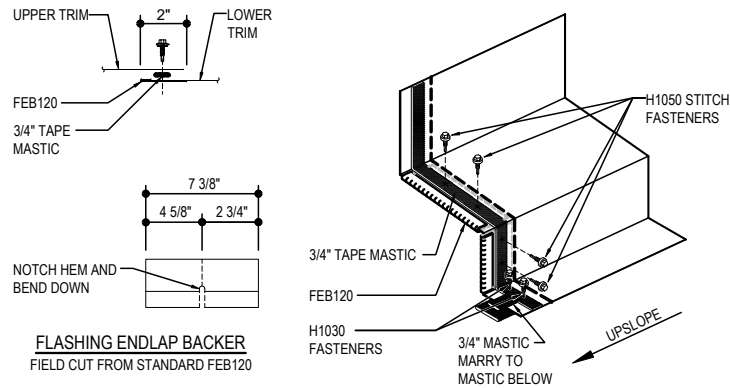

**NOTE 1: KEEP FASTENERS 2" AWAY FROM RAKE CLIPS!!**

**NOTE 2: AS A STANDARD, PANELS  
WILL BE STEPPED IF ROOF SLOPE  
IS < 1/2:12**  
**FIELD MITERING WILL BE REQUIRED  
IF ROOF SLOPE IS > 1/2:12**

**ERECTOR NOTE:** \_\_\_\_\_  
PLACE WALL FASTENERS THROUGH  
RAKE ANGLE ONLY.  
DO NOT PLACE WALL FASTENERS  
THROUGH RAKE PARAPET TRIM.

PARAPET TRIM SUPPORT \_\_\_\_\_  
@ 3 LOCATIONS EVENLY SPACED  
PER RPU121 MIN 6" FROM LAP  
MK RPS18 W/ (2) H1020

RAKE PARAM  
MK MAP01

FILL CAVITY  
INSULATION

(1) FASTENER AT EACH SUPPORT  
H1020 @ PURLIN  
H1070 @ JOIST

— WALL PANEL (SEE NOTE 2)

WALL PANEL CLOSURE	
R-PANEL	MK. CIR__
A-PANEL	MK. CIA__
REV. PANEL	MK. CIV__

w/ 3/4" TAPE MASTIC MK. H3000  
AT TOP AND BOTTOM OF CLOSURE

—RAKE PARAPET TRIM  
MK. RPU121  
(ANGLED FOR POSTIVE DRAINAGE)

— H1030 FASTENERS 4" O.C.

(SEE NOTE 1)

2 1/4" TAPE MASTIC MK. H3020  
BETWEEN TRIM & ROOF PANEL  
(APPLY MASTIC TO TRIM PRIOR  
TO INSTALLING TRIM)

— ROOF PANEL

ROOF INSULATION  
(NOT BY MBS)

— ROOF SECONDARY MEMBER

### RAKE PARAPET DETAIL

RAKE PARAPET DETAIL w/ WALL PANELS  
SEE WALL SHEETING ERECTION NOTES FOR WALL PANEL FASTENER LOCATIONS

EF6010

## Detailer Notes:

1) N/A

EF6030 - RAKE PARAPET w/ MASONRY WALL

[Download the DWG file by clicking here.](#)

**PARAPET LAP & FLASHING BACKER**

SLIDE FIELD CUT SECTION OF FLASHING ENDLAP BACKER ONTO THE LOWER TRIM PIECE AS SHOWN BELOW. PLACE TAPE MASTIC NEXT TO HEM OF THE BACKER (NOT ON TOP OF HEM). FASTEN LAP WITH STITCH FASTENERS. ROOF STRUCTURAL FASTENERS SHOULD BE USED TO FASTEN THROUGH PANEL FLAT INTO RAKE ANGLE.

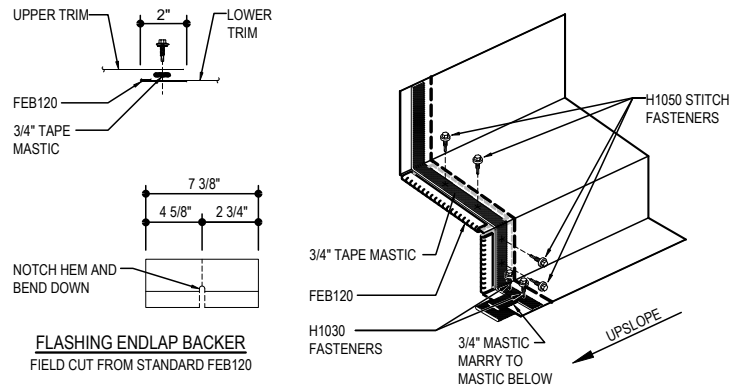

**NOTE 1: KEEP FASTENERS 2" AWAY FROM RAKE CLIPS!!**

**ERECTOR NOTE:**  
DO NOT FASTEN RAKE PARAPET TRIM TO MASONRY WALL OR EXISTING BUILDING

3/4" TAPE MASTIC  
MK. H3000

PARAPET TRIM SUPPORT  
@ 3 LOCATIONS EVENLY SPACED  
PER RPU121 MIN 6" FROM LAP  
MK. RPS18 W/ (2) FASTENERS NOT  
BY MBS

FILL CAVITY WITH  
INSULATION

MASONRY WALL  
(NOT BY MBS)

COUNTER FLASH  
(NOT BY MBS)

RAKE PARAPET TRIM  
MK. RPU121  
(ANGLED FOR POSTIVE DRAINAGE)

H1030 FASTENERS 4" O.C.  
(SEE NOTE 1)

2 1/4" TAPE MASTIC MK. H3020  
BETWEEN TRIM & ROOF PANEL  
(APPLY MASTIC TO TRIM PRIOR  
TO INSTALLING TRIM)

ROOF PANEL

3 1/4"

8%

3 3/4"

\*\*

§

ROOF INSULATION  
(NOT BY MBS)

ROOF SECONDARY  
MEMBER

**RAKE PARAPET DETAIL**

RAKE PARAPET DETAIL w/ MASONRY WALL

EF6030

Detailer Notes:

1) N/A

## EF6050 - RAKE PARAPET w/ RAFTER IN HIGH BUILDING

[Download the DWG file by clicking here.](#)

### PARAPET LAP & FLASHING BACKER

SLIDE FIELD CUT SECTION OF FLASHING ENDLAP BACKER ONTO THE LOWER TRIM PIECE AS SHOWN BELOW. PLACE TAPE MASTIC NEXT TO HEM OF THE BACKER (NOT ON TOP OF HEM). FASTEN LAP WITH STITCH FASTENERS. ROOF STRUCTURAL FASTENERS SHOULD BE USED TO FASTEN THROUGH PANEL FLAT INTO RAKE ANGLE.

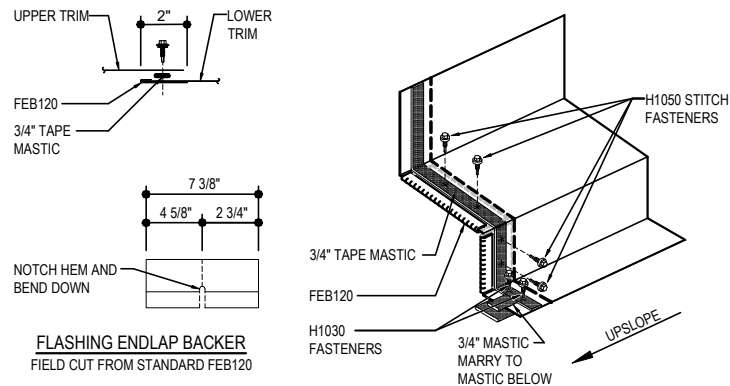

**NOTE 1: KEEP FASTENERS 2"  
AWAY FROM RAKE CLIPS!!**

**NOTE 2: AS A STANDARD, PANELS  
WILL BE STEPPED IF ROOF SLOPE  
IS < 1/2:12**  
**FIELD MITERING WILL BE REQUIRED  
IF ROOF SLOPE IS > 1/2:12**

**ERECTOR NOTE:** \_\_\_\_\_  
PLACE WALL FASTENERS  
THROUGH RAKE ANGLE ONLY.  
DO NOT PLACE WALL FASTENERS  
THROUGH RAKE PARAPET TRIM.

PARAPET TRIM SUPPORT  
@ 3 LOCATIONS EVENLY SPACED  
PER RPU121 MIN 6" FROM LAP  
MK. RPS18 W/ (2) H1020

RAKE PARAPET ANGLE -  
MK. MAP01

FILL CAVITY WITH INSULATION

(1) FASTENER AT EACH SUPPORT  
H1020 @ PURLIN

RAKE ANGLE MK. MAR01

TO BE WHOLE WITH HIM/HER

FIELD COPE PANELS —  
AROUND PURLINS OR JOISTS

— WALL PANEL (SEE NOTE 2)

WALL PANEL CLOSURE	
R-PANEL	MK. CIR__
A-PANEL	MK. CIA__
REV. PANEL	MK. CIV__

w/ 3/4" TAPE MASTIC MK. H3000  
AT TOP AND BOTTOM OF CLOSURE

- RAKE PARAPET TRIM  
MK. RPU121  
(ANGLED FOR POSTIVE DRAINAGE)
- H1030 FASTENERS 4" O.C.  
(SEE NOTE 1)

— 2 1/4" TAPE MASTIC MK. H3020  
BETWEEN TRIM & ROOF PANEL  
(APPLY MASTIC TO TRIM PRIOR  
TO INSTALLING TRIM)

ROOF PANEL

- ROOF INSULATION  
(NOT BY MBS)
- PARTITION FLASHING PR\_072  
ATTACHED w/ H1060
- ROOF SECONDARY  
MEMBER

### RAKE PARAPET DETAIL

RAKE PARAPET DETAIL w/ WALL PANELS  
SEE WALL SHEETING ERECTION NOTES FOR WALL PANEL FASTENER LOCATIONS

EF6050

## Detailer Notes:

- 1) Closure Interior layer should be turned OFF/ON depending if the order documents request them.

EF6060 - RAKE PARAPET w/ RAFTER IN LOW BUILDING

[Download the DWG file by clicking here.](#)

**PARAPET LAP & FLASHING BACKER**

SLIDE FIELD CUT SECTION OF FLASHING ENDLAP BACKER ONTO THE LOWER TRIM PIECE AS SHOWN BELOW. PLACE TAPE MASTIC NEXT TO HEM OF THE BACKER (NOT ON TOP OF HEM). FASTEN LAP WITH STITCH FASTENERS. ROOF STRUCTURAL FASTENERS SHOULD BE USED TO FASTEN THROUGH PANEL FLAT INTO RAKE ANGLE.

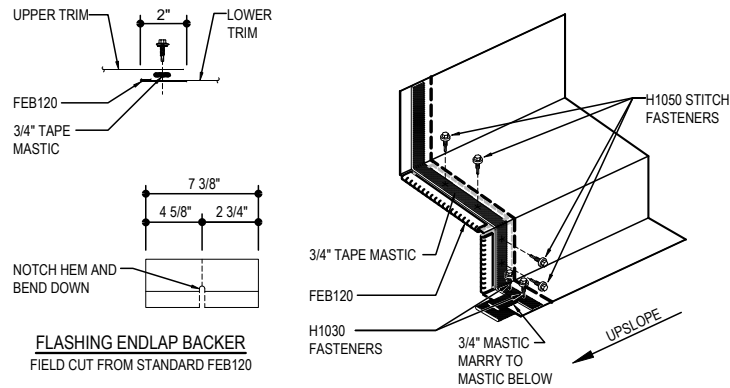

**NOTE 1: KEEP FASTENERS 2" AWAY FROM RAKE CLIPS!!**

**NOTE 2: AS A STANDARD, PANELS WILL BE STEPPED IF ROOF SLOPE IS < 1/2:12. FIELD MITERING WILL BE REQUIRED IF ROOF SLOPE IS > 1/2:12**

**ERECTOR NOTE:**  
PLACE WALL FASTENERS THROUGH RAKE ANGLE ONLY. DO NOT PLACE WALL FASTENERS THROUGH RAKE PARAPET TRIM.

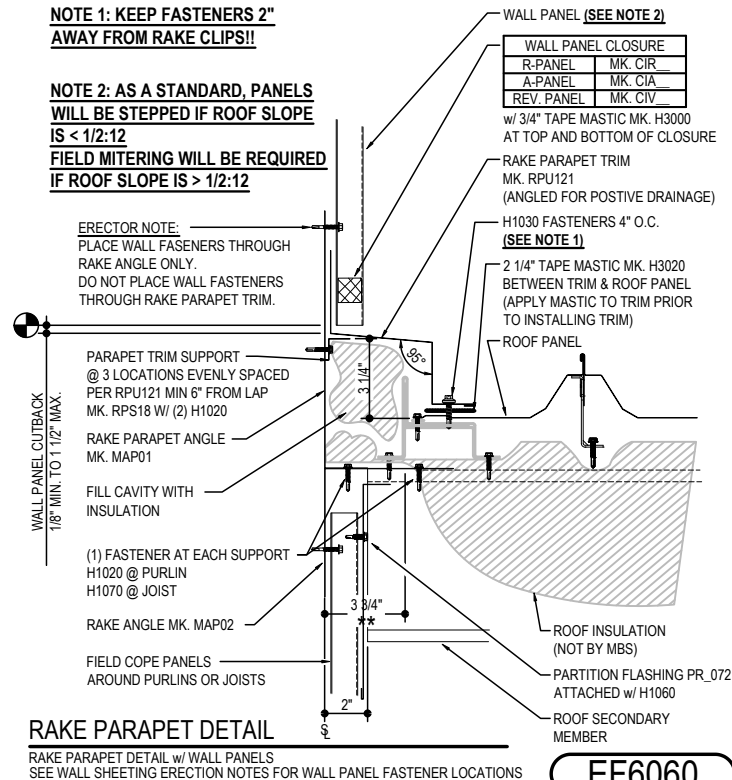

**RAKE PARAPET DETAIL**

RAKE PARAPET DETAIL w/ WALL PANELS  
SEE WALL SHEETING ERECTION NOTES FOR WALL PANEL FASTENER LOCATIONS

**EF6060**

**Detailer Notes:**

1) N/A

**EF6090 - NON-STRUCTURAL PARAPET**

[Download the DWG file by clicking here.](#)

**PARAPET LAP & FLASHING BACKER**

SLIDE FIELD CUT SECTION OF FLASHING ENDLAP BACKER ONTO THE LOWER TRIM PIECE AS SHOWN BELOW. PLACE TAPE MASTIC NEXT TO HEM OF THE BACKER (NOT ON TOP OF HEM). FASTEN LAP WITH STITCH FASTENERS. ROOF STRUCTURAL FASTENERS SHOULD BE USED TO FASTEN THROUGH PANEL FLAT INTO RAKE ANGLE.

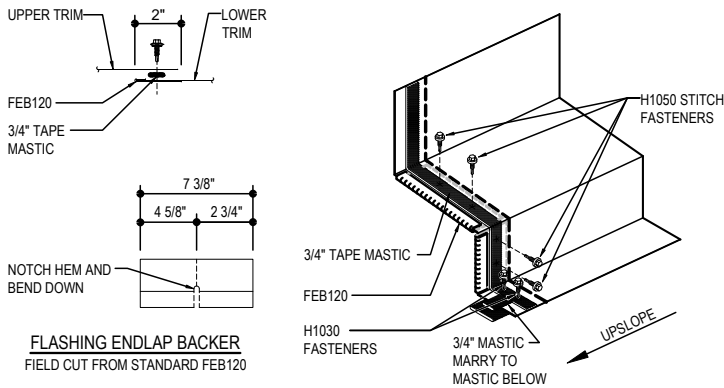

**CAP TRIM LAP**

APPLY CONTINUOUS BEAD OF CAULK 1" FROM END OF TRIM DOWN PROFILE OF TRIM. FASTEN LAP WITH POP RIVETS AS SHOWN.

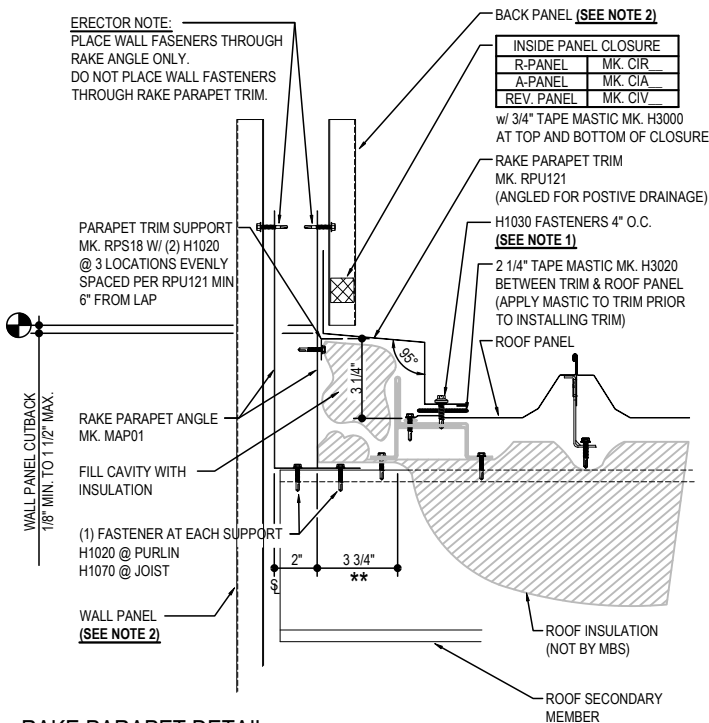
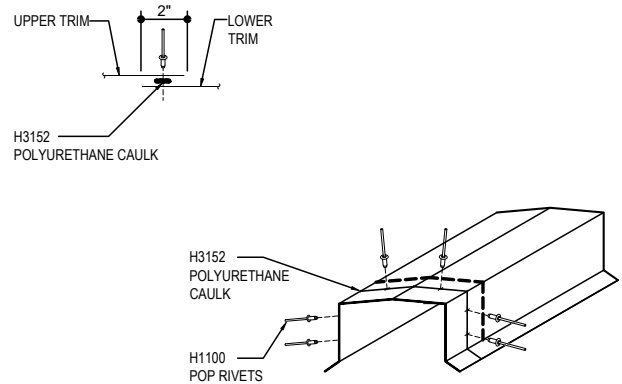

**NOTE 1: KEEP FASTENERS 2" AWAY FROM RAKE CLIPS!!**

**NOTE 2: AS A STANDARD, PANELS WILL BE STEPPED IF ROOF SLOPE IS < 1/2:12. FIELD MITERING WILL BE REQUIRED IF ROOF SLOPE IS > 1/2:12**

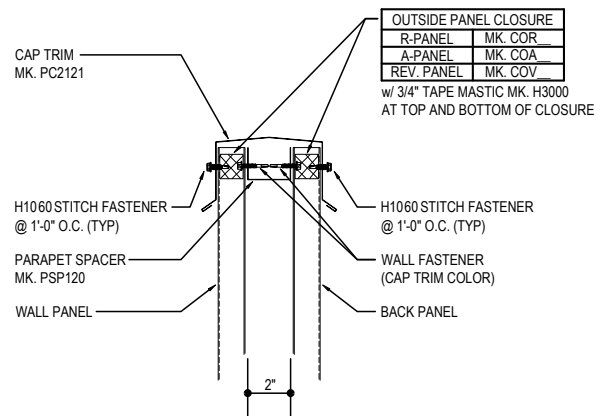

**RAKE PARAPET DETAIL**

RAKE PARAPET DETAIL w/ WALL PANELS  
SEE WALL SHEETING ERECTION NOTES FOR WALL PANEL FASTENER LOCATIONS

**EF6090**

**Detailer Notes:**

- 1) PANEL CLOSURES ARE ALWAYS REQUIRED AS A STANDARD AT THE BACK PANEL.
- 2) OUTSIDE WALL PANEL CLOSURES ARE OPTIONAL ON EXTERIOR PANEL. TURN OFF OUTSIDE CLOSURE LAYER IF NOT REQUIRED.

EF6610 - RAKE PARAPET w/ INSULATED WALL PANEL ABOVE

[Download the DWG file by clicking here.](#)

**PARAPET LAP & FLASHING BACKER**

SLIDE FIELD CUT SECTION OF FLASHING ENDLAP BACKER ONTO THE LOWER TRIM PIECE AS SHOWN BELOW. PLACE TAPE MASTIC NEXT TO HEM OF THE BACKER (NOT ON TOP OF HEM). FASTEN LAP WITH STITCH FASTENERS. ROOF STRUCTURAL FASTENERS SHOULD BE USED TO FASTEN THROUGH PANEL FLAT INTO RAKE ANGLE.

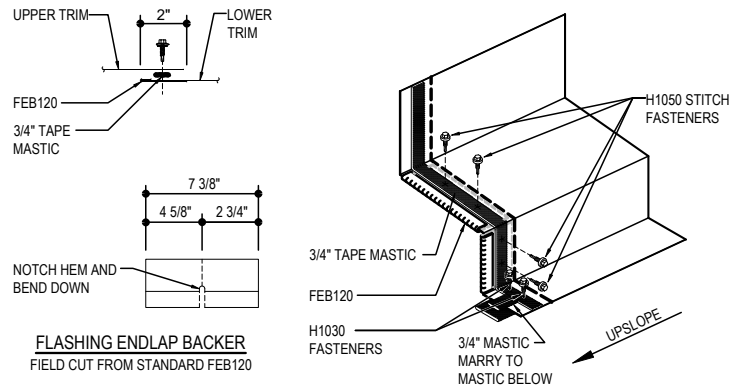

**NOTE 1: KEEP FASTENERS 2" AWAY FROM RAKE CLIPS!!**

**NOTE 2: AS A STANDARD, PANELS WILL BE STEPPED IF ROOF SLOPE IS < 1/2:12. FIELD MITERING WILL BE REQUIRED IF ROOF SLOPE IS > 1/2:12**

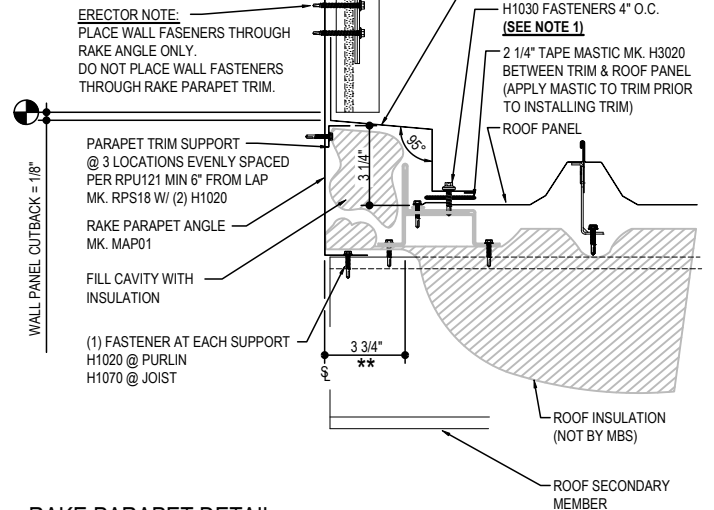

**RAKE PARAPET DETAIL**

RAKE PARAPET DETAIL w/ INSULATED WALL PANELS  
SEE INSULATED WALL SHEETING ERECTION DETAILS FOR INSTALLATION INSTRUCTIONS.

EF6610

Detailer Notes:

1) N/A

EF6650 - RAKE PARAPET w/ INSULATED WALL PANEL ABOVE/BELOW

[Download the DWG file by clicking here.](#)

## PARAPET LAP & FLASHING BACKER

SLIDE FIELD CUT SECTION OF FLASHING ENDLAP BACKER ONTO THE LOWER TRIM PIECE AS SHOWN BELOW. PLACE TAPE MASTIC NEXT TO HEM OF THE BACKER (NOT ON TOP OF HEM). FASTEN LAP WITH STITCH FASTENERS. ROOF STRUCTURAL FASTENERS SHOULD BE USED TO FASTEN THROUGH PANEL FLAT INTO RAKE ANGLE.

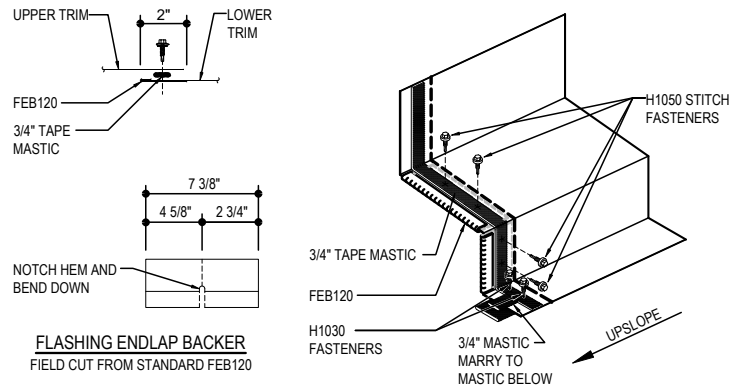

**NOTE 1: KEEP FASTENERS 2"**  
**AWAY FROM RAKE CLIPS!!**

**NOTE 2: AS A STANDARD, PANELS  
WILL BE STEPPED IF ROOF SLOPE  
IS < 1/2:12**  
**FIELD MITERING WILL BE REQUIRED  
IF ROOF SLOPE IS > 1/2:12**

**ERECTOR NOTE:** \_\_\_\_\_  
PLACE WALL FASTENERS THROUGH  
RAKE ANGLE ONLY.  
DO NOT PLACE WALL FASTENERS  
THROUGH RAKE PARAPET TRIM.

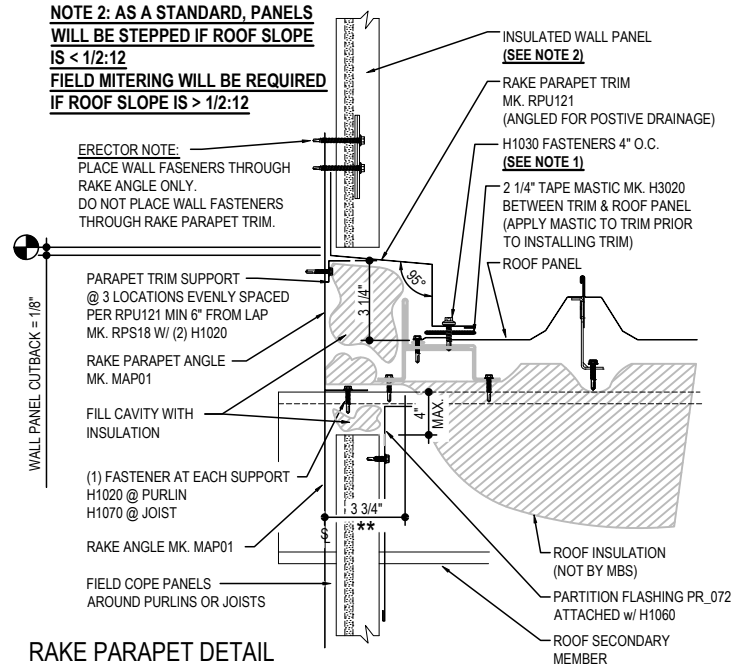

### RAKE PARAPET DETAIL

RAKE PARAPET DETAIL w/ INSULATED WALL PANELS  
SEE INSULATED WALL SHEETING ERECTION DETAILS FOR INSTALLATION  
INSTRUCTIONS.

EF6650

## Detailer Notes:

1) N/A



**EF6690 - NON-STRUCTURAL PARAPET - IMP WITH BACKER**

[Download the DWG file by clicking here.](#)

**PARAPET LAP & FLASHING BACKER**

SLIDE FIELD CUT SECTION OF FLASHING ENDLAP BACKER ONTO THE LOWER TRIM PIECE AS SHOWN BELOW. PLACE TAPE MASTIC NEXT TO HEM OF THE BACKER (NOT ON TOP OF HEM). FASTEN LAP WITH STITCH FASTENERS. ROOF STRUCTURAL FASTENERS SHOULD BE USED TO FASTEN THROUGH PANEL FLAT INTO RAKE ANGLE.

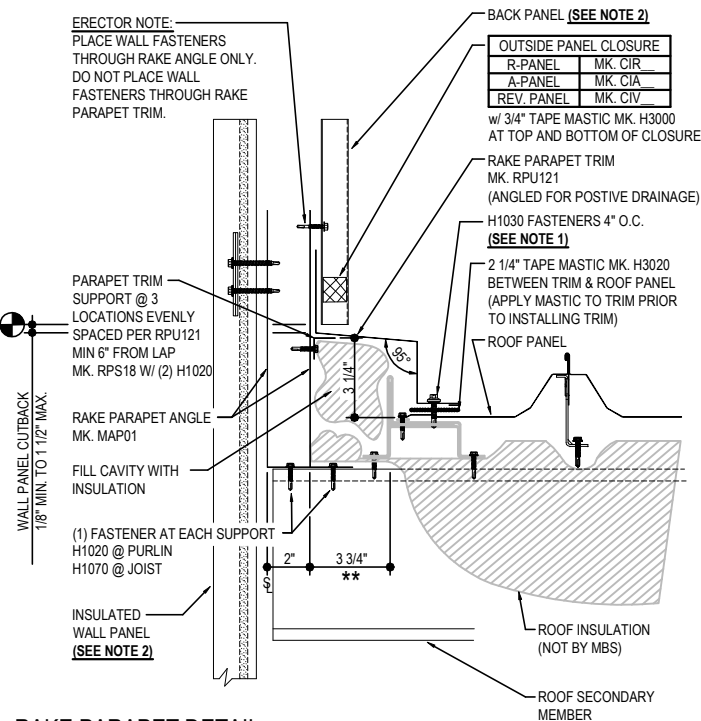
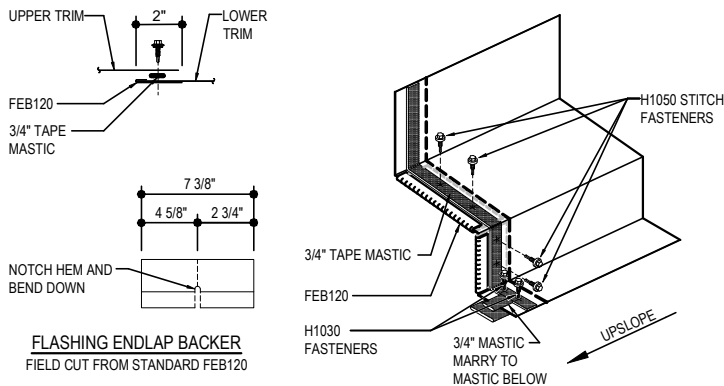

**RAKE PARAPET DETAIL**

RAKE PARAPET DETAIL w/ WALL PANELS  
SEE WALL SHEETING ERECTION NOTES FOR WALL PANEL FASTENER LOCATIONS

**CAP TRIM LAP**

APPLY CONTINUOUS BEAD OF CAULK 1" FROM END OF TRIM DOWN PROFILE OF TRIM. FASTEN LAP WITH POP RIVETS AS SHOWN.

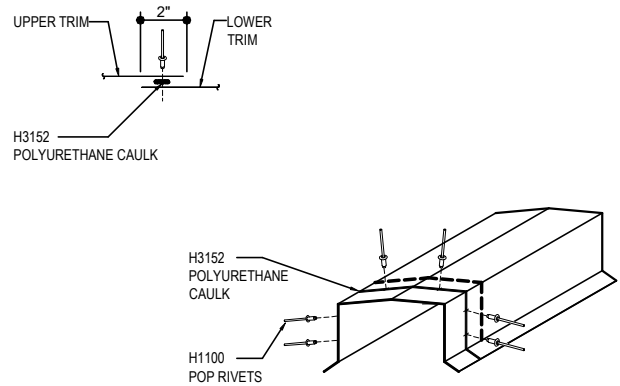

**NOTE 1: KEEP FASTENERS 2" AWAY FROM RAKE CLIPS!!**

**NOTE 2: AS A STANDARD, PANELS WILL BE STEPPED IF ROOF SLOPE IS < 1/2:12 FIELD MITERING WILL BE REQUIRED IF ROOF SLOPE IS > 1/2:12**

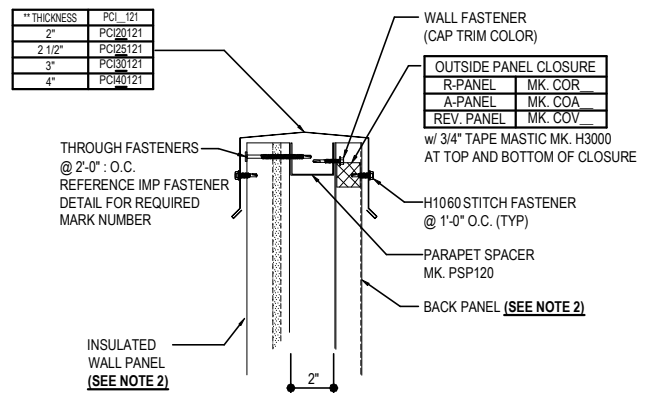

**EF6690**

**Detailer Notes:**

- 1) PANEL CLOSURES ARE ALWAYS REQUIRED AS A STANDARD AT THE BACK PANEL.
- 2) OUTSIDE WALL PANEL CLOSURES ARE OPTIONAL ON EXTERIOR PANEL. TURN OFF OUTSIDE CLOSURE LAYER IF NOT REQUIRED.