

HIP AND VALLEY

- EP3021 - LOC SEAM HIP - STD. CLIPS (FRAMING BY MBS)
 - EP3040 - LOC SEAM VALLEY - STD. CLIPS (FRAMING BY MBS)
 - EP3421 - LOC SEAM HIP - UTILITY CLIPS (FRAMING BY MBS)
 - EP3422 - LOC SEAM HIP - UTILITY CLIPS (SUB-STRUCTURE BY OTHERS)
 - EP3440 - LOC SEAM VALLEY - UTILITY CLIPS (FRAMING BY MBS)
 - EP3441 - LOC SEAM VALLEY - UTILITY CLIPS (SUB-STRUCTURE BY OTHERS)
-

EP3021 - LOC SEAM HIP CONDITION - STD. CLIPS (FRAMING BY MBS)

Download the DWG file by clicking here.

HIP CONDITION ERECTION NOTES:

- 1) INSTALL THE EAVE PLATES AS SHOWN AT RIGHT. MITER CORNERS AND CAULK THE EAVE PLATES AT THE CORNER WITH H1152 TUBE CAULK.
- 2) AFTER THE INSTALLATION OF THE EAVE PLATES AND BEFORE ROOF PANEL INSTALLATION, START AT THE LOW EAVE AND RUN MAR1 ANGLE ALONG BOTH SIDES OF THE HIP AS SHOWN IN EAVE PLATE AND ANGLE DETAIL. COPE THE VERTICAL LEG OF THE ANGLE AT EACH PURLIN LOCATION. FASTEN ANGLE TO PURLINS WITH (2) H1100 FASTENERS AT EACH PURLIN LOCATION.
- 3) IF THE INSULATION PAN (HP-120) IS SUPPLIED, INSTALL INSULATION PAN OVER PURLINS AND FASTEN AT EACH SUPPORT WITH (3) H1020 FASTENERS. DRAPE THE INSULATION OVER THE INSULATION PAN AND FASTEN WITH H1020 SCREWS AND H2020 INSULATION WASHERS. IF INSULATION PAN IS NOT SUPPLIED, DRAPE INSULATION OVER MAR1 ANGLES AND FASTEN WITH H1020 SCREWS AND H2020 INSULATION WASHERS.
- 4) INSTALL THE ROOF PANELS. FIELD CUT THE PANELS AT THE REQUIRED ANGLE, 4" DOWN FROM THE HIP CENTERLINE. NOTE: KEEP SHIMMINGS OUT OF THE SIDLAP. ON THE PANELS WILL NOT SEAM PROPERLY. APPLY 3" TAPE PAD AND 1" LONG BEAD OF CAULK ALONG THE MALE RIB, AS SHOWN IN DETAIL TO THE RIGHT OF THESE NOTES.
- 5) INSTALL THE ZEE CLOSURE. INSTALL ZEE CLOSURE COVER FLASH ONTO ZEE CLOSURE AT THIS TIME IF YOU HAVE A PAINTED ROOF.
- 6) APPLY 2 1/4" TAPE MASTIC (H2020) TO THE BOTTOM LEG OF THE ZEE CLOSURES, THEN PLACE THE VERTICAL LEG OF THE ZEE CLOSURE UP AGAINST THE END OF THE SKIDDY CUT PANELS. FASTEN INTO THE ZEE WITH H1030 SCREWS (3" O.C.). INSPECT FOR WEATHERTIGHTNESS AND APPLY TUBE CAULK (H1101) AS REQUIRED.
- 7) APPLY 1 1/2" TAPE MASTIC (H3001) TO THE TOP LEG OF THE ZEE CLOSURE.
- 8) INSTALL THE HIP FLASH BY CENTERING IT OVER THE ZEE CLOSURES AND FASTEN WITH H1030 SCREWS AT 4" ON CENTER.
- 9) FIELD WORK: THE HIP FLASH IS REQUIRED AT THE LOW EAVE OF THE HIP TO ENSURE WEATHERTIGHTNESS.

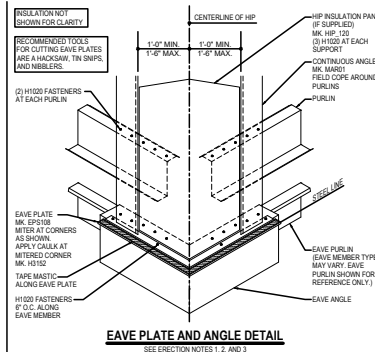

EAVE PLATE AND ANGLE DETAIL

SEE ERECTION NOTES 1, 2, AND 3

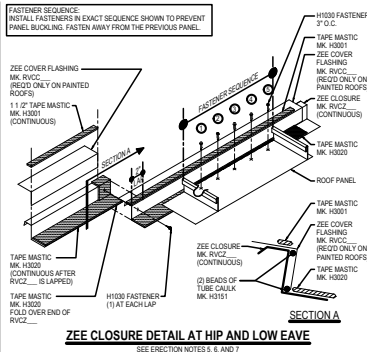

ZEE CLOSURE DETAIL AT HIP AND LOW EAVE

SEE ERECTION NOTES 5, 6, AND 7

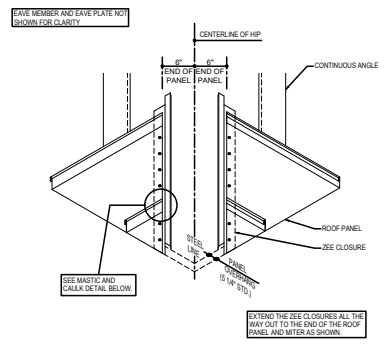

EXTEND THE ZEE CLOSURES ALL THE WAY OUT TO THE END OF THE ROOF PANEL AND MITER AS SHOWN.

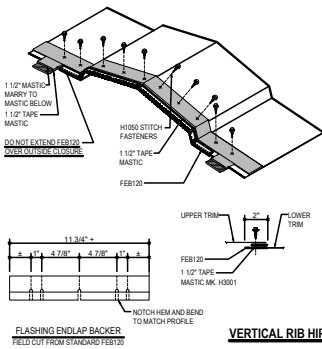

FLASHING ENLAP BACKER

FIELD CUT FROM STANDARD FEB120

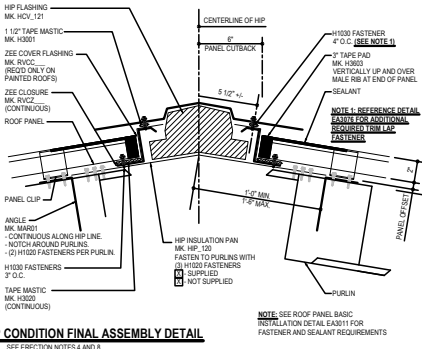

VERTICAL RIB HIP CONDITION FINAL ASSEMBLY DETAIL

SEE ERECTION NOTES 4 AND 8

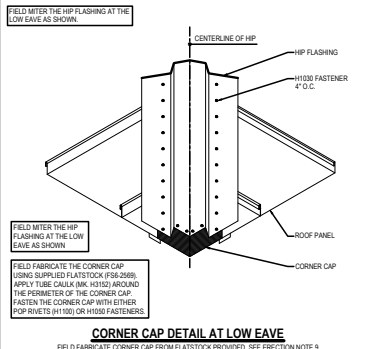

CORNER CAP DETAIL AT LOW EAVE

FIELD FABRICATE CORNER CAP FROM PLATSTOCK PROVIDED. SEE ERECTION NOTE 9

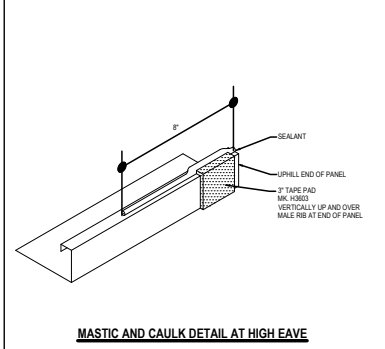

MASTIC AND CAULK DETAIL AT HIGH EAVE

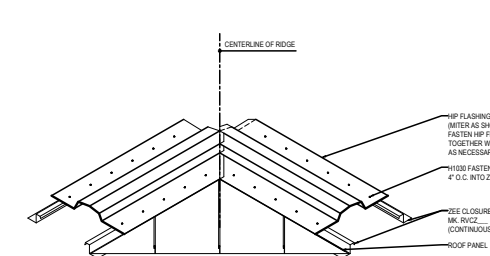

SUGGESTED HIP FLASHING TRANSITION INTO THE RIDGE CAP

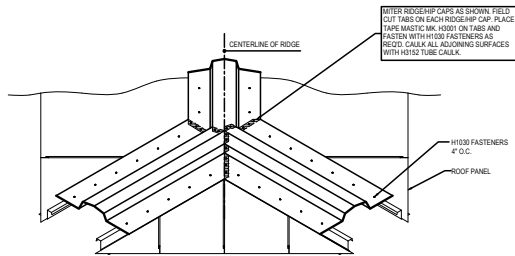

LOC SEAM HIP CONDITION - STD. CLIPS
FRAMING BY METAL BUILDING SUPPLIES

EP3021

Detailer Notes:

- 1) N/A

[Download the DWG file by clicking here.](#)

VALLEY CONDITION ERECTION NOTES

- [illegible]

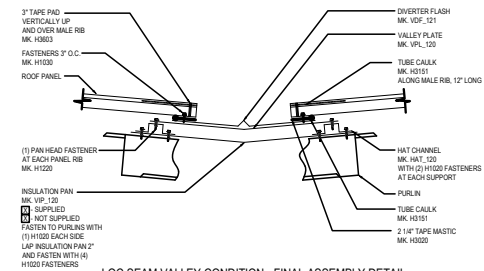

LOC SEAM VALLEY CONDITION - FINAL ASSEMBLY DETAIL

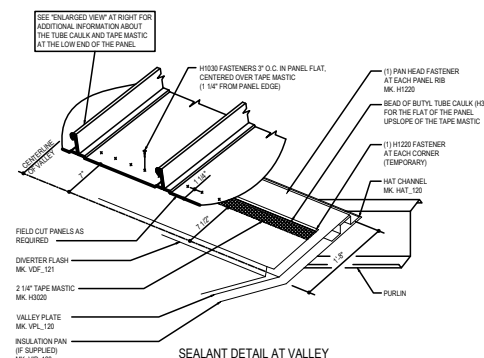

SEALANT DETAIL AT VALLEY

SEE ERECTION NOTES 4, 5, 6, 7 AND 9

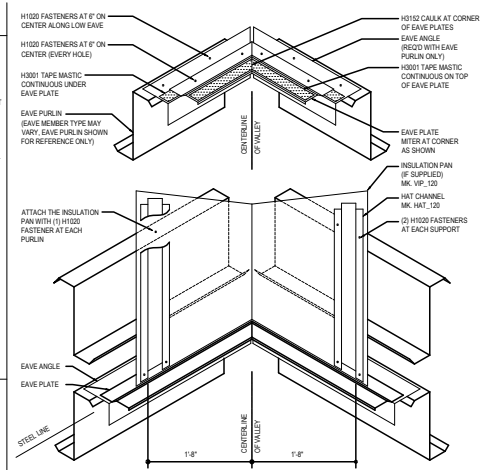

INSULATION PAN, EAVE PLATE, AND HAT CHANNEL DETAIL AT LOW EAVE CORNER

SEE ERECTION NOTES 1, 2 AND 3

NOTE:
FIELD TAB VALLEY DIVERTER FLASHING
TO CLOSE OFF VALLEY AT LOW EAVE.

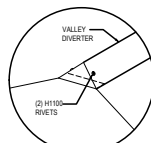

DETAIL "A"

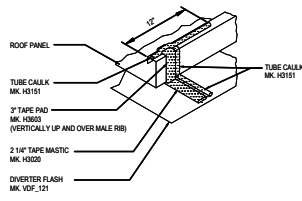

SEALANT DETAIL AT LOW END OF PANELS

SEE ERECTION NOTE 8

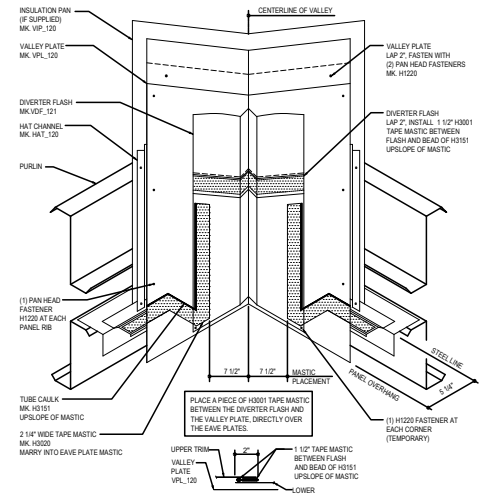

VALLEY PLATE AND DIVERTER FLASH DETAIL AT LOW EAVE CORNER

SEE ERECTION NOTES 4, 5 AND 6

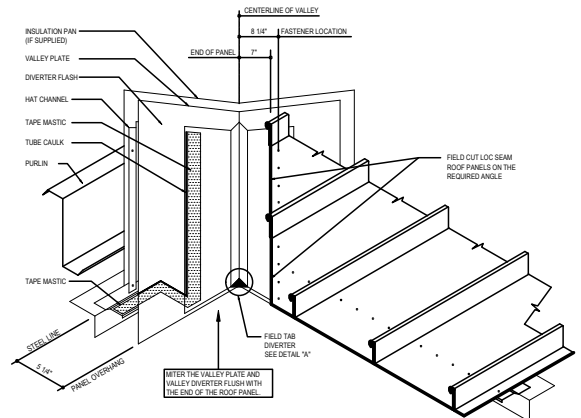

LOC SEAM VALLEY CONDITION - STD. CLIPS

FRAMING BY METAL BUILDING SUPPLIER

EP3040

Detailer Notes:

1) N/A

EP3421 - LOC SEAM HIP CONDITION - UTILITY CLIPS (FRAMING BY MBS)

Download the DWG file by clicking here.

HIP CONDITION ERECTION NOTES:

- 1) BEFORE ROOF PANEL INSTALLATION, START AT THE LOW EAVE AND RUN MARRY ANGLE ALONG BOTH SIDES OF THE HP AS SHOWN IN EAVE AND HP ANGLE DETAIL. COPE THE VERTICAL LEG OF THE ANGLE AT EACH PURLIN LOCATION. FASTEN ANGLE TO PURLINS WITH (2) H1030 FASTENERS AT EACH PURLIN LOCATION.
- 2) INSTALL THE ROOF PANELS. FIELD CUT THE PANELS AT THE REQUIRED ANGLE, 8" DOWN FROM THE HP CENTERLINE. (NOTE: KEEP SHAVINGS OUT OF THE SIDELAP, OR THE PANELS WILL NOT SEAM PROPERLY.) APPLY 3" TAPE PAD (H3080) AND IF LONG BEAD OF CAULK (H1015) ALONG THE MALE RIB, AS SHOWN IN DETAIL TO THE RIGHT OF THESE NOTES.
- 3) INSTALL THE ZEE CLOSURE (RVCCZ...). INSTALL ZEE CLOSURE COVER FLASH (RVCCZ...) ONTO ZEE CLOSURE AT THIS TIME IF YOU HAVE A PAINTED ROOF.
- 4) APPLY 2 1/4" TAPE MASTIC (H3020) TO THE BOTTOM LEG OF THE ZEE CLOSURES. THEN PLACE THE VERTICAL LEG OF THE ZEE CLOSURE UP AGAINST THE END OF THE SKEW OUT PANELS. FASTEN INTO THE ZEE WITH H1030 SCREWS (8" O.C.). INSPECT FOR WEATHERTIGHTNESS AND APPLY TUBE CAULK (H1015) AS REQUIRED.
- 5) APPLY 1 1/2" TAPE MASTIC (H3001) TO THE TOP LEG OF THE ZEE CLOSURE.
- 6) INSTALL THE HIP FLASH BY CENTERING IT OVER THE ZEE CLOSURES AND FASTEN WITH H1030 SCREWS AT 4" ON CENTER.
- 7) FIELD WORK THE HIP FLASH AS REQUIRED AT THE LOW EAVE OF THE HP TO ENSURE WEATHERTIGHTNESS.

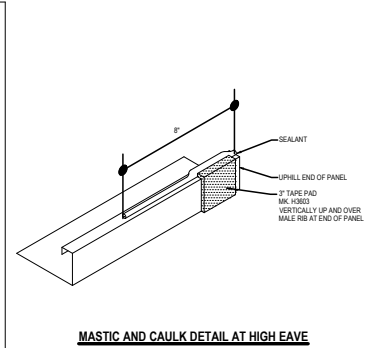
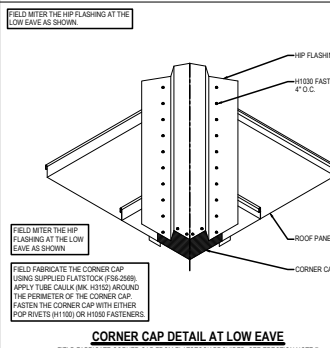
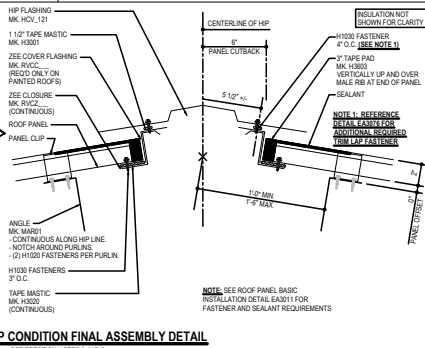
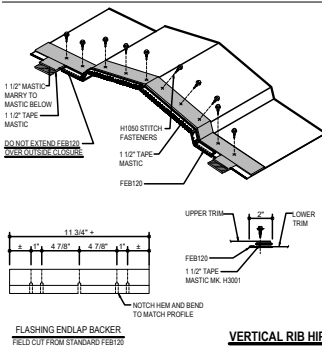
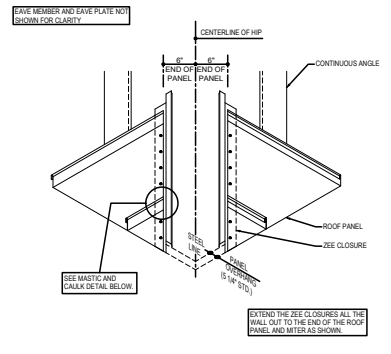
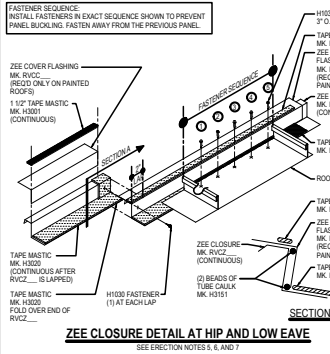
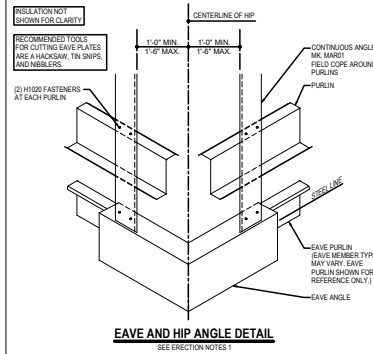

Detailer Notes:

- 1) N/A

EP3422 - LOC SEAM HIP CONDITION - UTILITY CLIPS (SUB-STRUCTURE BY OTHERS)

[Download the DWG file by clicking here.](#)

HIP CONDITION ERECTION NOTES:

- 1) INSTALL THE ROOF PANELS FIELD CUT THE PANELS AT THE REQUIRED ANGLE, 6" DOWN FROM THE HIP CENTERLINE. (NOTE: KEEP SHAVINGS OUT OF THE SIDELAP, OR THE PANELS WILL NOT SEAM PROPERLY). APPLY 3" TAPE PAD (H080) AND IF LONG BEAD OF CAULK (H101) ALONG THE MALE RIB AS SHOWN IN DETAIL TO THE RIGHT OF THESE NOTES.
- 2) INSTALL THE ZEE CLOSURE (RVCC...) INSTALL ZEE CLOSURE COVER FLASH (RVCC...) ONTO ZEE CLOSURE AT THIS TIME IF YOU HAVE A PAINTED ROOF.
- 3) APPLY 2 1/2" TAPE MASTIC (H020) TO THE BOTTOM LEG OF THE ZEE CLOSURES, THEN PLACE THE VERTICAL LEG OF THE ZEE CLOSURE UP AGAINST THE END OF THE SKEW CUT PANELS. FASTEN INTO THE ZEE WITH H1030 SCREWS (7" O.C.). INSPECT FOR WEATHERTIGHTNESS AND APPLY TUBE CAULK (H101) AS REQUIRED.
- 4) APPLY 1 1/2" TAPE MASTIC (H001) TO THE TOP LEG OF THE ZEE CLOSURE.
- 5) INSTALL THE HIP FLASH BY CENTERING IT OVER THE ZEE CLOSURES AND FASTEN WITH H1030 SCREWS AT 4" ON CENTER.
- 6) FIELD WORK: THE HIP FLASH AS REQUIRED AT THE LOW EAVE OF THE HIP TO ENSURE WEATHERTIGHTNESS.

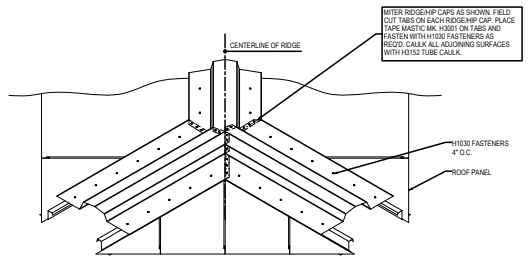
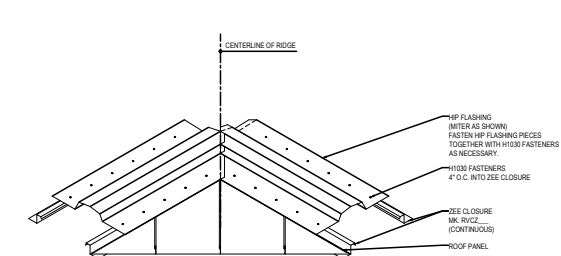
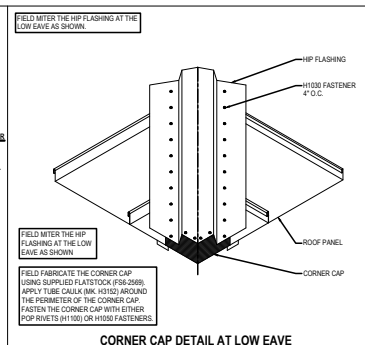
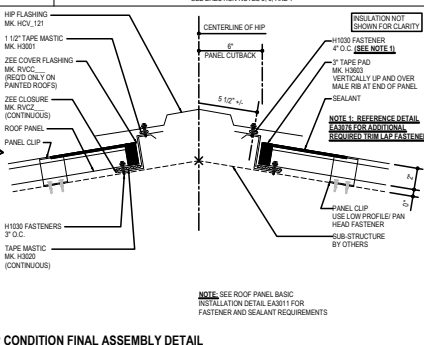
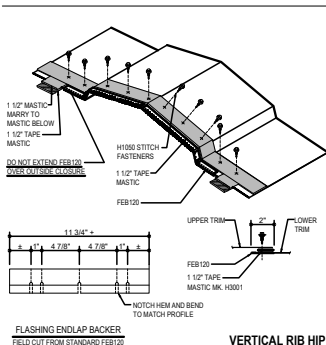
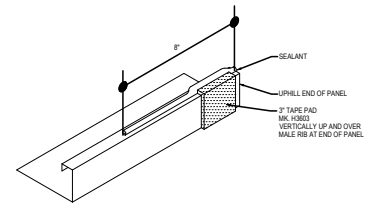
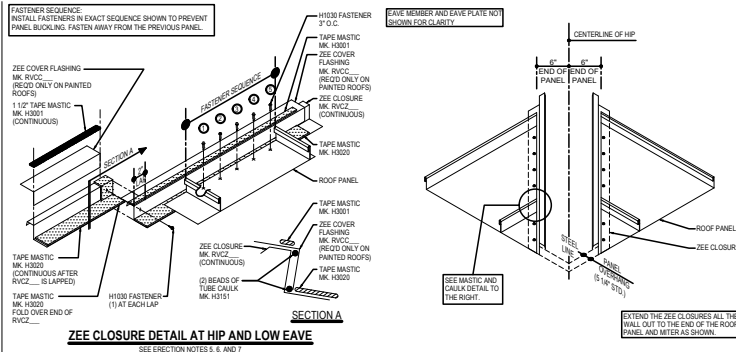

LOC SEAM HIP CONDITION - UTILITY CLIPS
SUB-STRUCTURE BY OTHERS

EP3422

Detailer Notes:

- 1) N/A

EP3440 - LOC SEAM VALLEY CONDITION - UTILITY CLIPS (FRAMING BY MBS)

[Download the DWG file by clicking here.](#)

VALLEY CONDITION ERECTION NOTES

- 1) BEFORE THE ROOF PANEL INSTALLATION, START AT THE LOW EAVE AND CENTER THE VALLEY PLATE IN THE VALLEY. EXTEND THE PLATE TO THE EDGE OF THE ROOF PANEL. FIELD CUTTING AS REQUIRED. FASTEN VALLEY PLATE WITH (3) H1220 FASTENERS AT EACH PURLIN ON BOTH SIDES OF VALLEY. LAP THE VALLEY PLATES 2" AND FASTEN WITH (2) H1220 FASTENERS.
- 2) PLACE THE DIVERTER FLASH OVER THE VALLEY PLATE AND TEMPORARILY FASTEN WITH (1) H1220 FASTENERS AT THE OUTSIDE CORNERS OF THE DIVERTER FLASH. **DO NOT** USE THE VALLEY AS A WALKWAY OR A WORK PLATFORM.
- 3) INSTALL 2 1/4" TAPE MASTIC MK H0200 ON THE DIVERTER FLASH 7 1/2" FROM THE CENTER OF THE VALLEY AS SHOWN. DO NOT REMOVE PAPER BACKING UNTIL READY TO SET PANEL. ALSO APPLY A BEAD OF BUTYL TUBE CAULK MK H0151 FOR THE FLAT OF THE PANEL UPSLOPE OF THE TAPE MASTIC.
- 4) INSTALL THE ROOF PANELS- CUTTING ENDS AT THE REQUIRED ANGLE. CUT PANELS 7" FROM THE CENTER OF THE VALLEY PLATE. (NOTE: KEEP METAL SHAVINGS OUT OF MASTIC AND CAULK).
- 5) BEFORE THE NEXT PANEL IS INSTALLED, APPLY A 3" PIECE OF TAPE PAD (H080) AND A BEAD OF TUBE CAULK MK H0151 TO THE MALE SIDE OF THE PANEL FROM THE LOW END OF THE PANEL UP 12" TO ENSURE WEATHERTIGHTNESS AS SHOWN IN THE SEALANT DETAIL.
- 6) FASTEN PANELS WITH H1030 FASTENERS, 3" O.C. OVER THE TAPE MASTIC. (8 1/4" FROM THE CENTER OF THE DIVERTER FLASH TO THE CENTER OF THE FASTENERS). TAKE SPECIAL CARE AT THIS POINT TO MAINTAIN PANEL MODULARITY.
- 7) FIELD WORK THE HIGH AND LOW ENDS OF THE VALLEY AS REQUIRED TO ENSURE WEATHERTIGHTNESS.

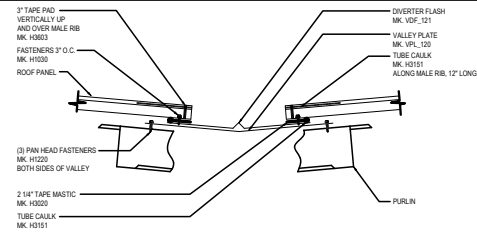

LOC SEAM VALLEY CONDITION - FINAL ASSEMBLY DETAIL

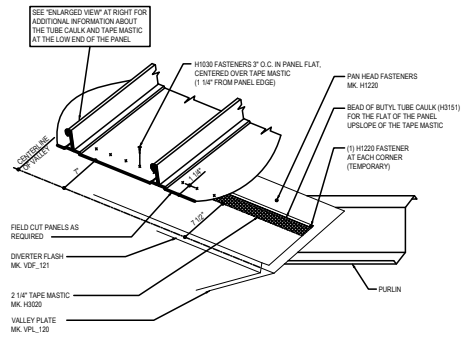

SEALANT DETAIL AT VALLEY
SEE ERECTION NOTES 2, 3, 4 AND 6

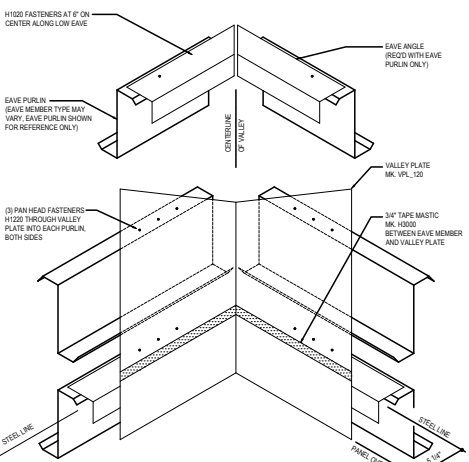

VALLEY PLATE DETAIL AT LOW EAVE CORNER
SEE ERECTION NOTE 1

NOTE:
FIELD TAB VALLEY DIVERTER FLASHING
TO CLOSE OFF VALLEY AT LOW EAVE.

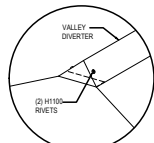

DETAIL "A"

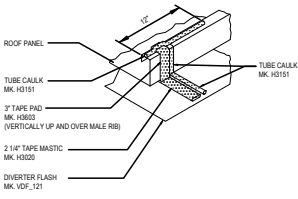

SEALANT DETAIL AT LOW END OF PANELS
SEE ERECTION NOTE 5

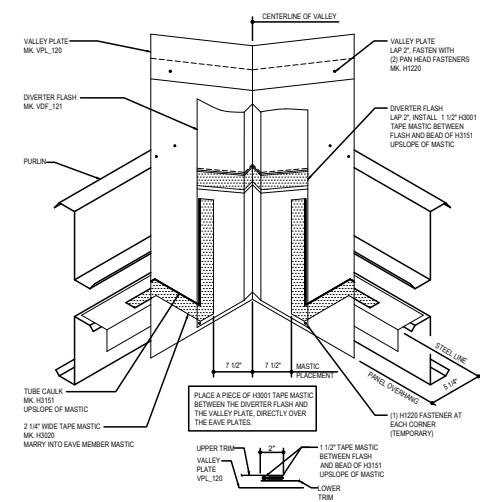

VALLEY PLATE AND DIVERTER FLASH DETAIL AT LOW EAVE CORNER
SEE ERECTION NOTES 1, 2 AND 3

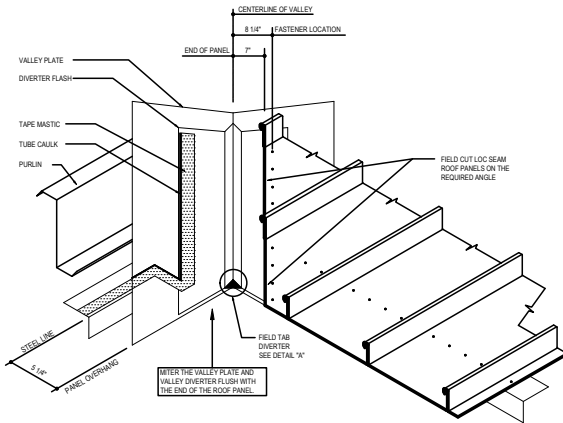

LOC SEAM VALLEY CONDITION - UTILITY CLIPS
FORMING BY METAL BUILDING SUPPLIER

EP3440

Detailer Notes:

1) N/A

EP3441 - LOC SEAM VALLEY CONDITION - UTILITY CLIPS (SUB-STRUCTURE BY OTHERS)

Download the DWG file by clicking here.

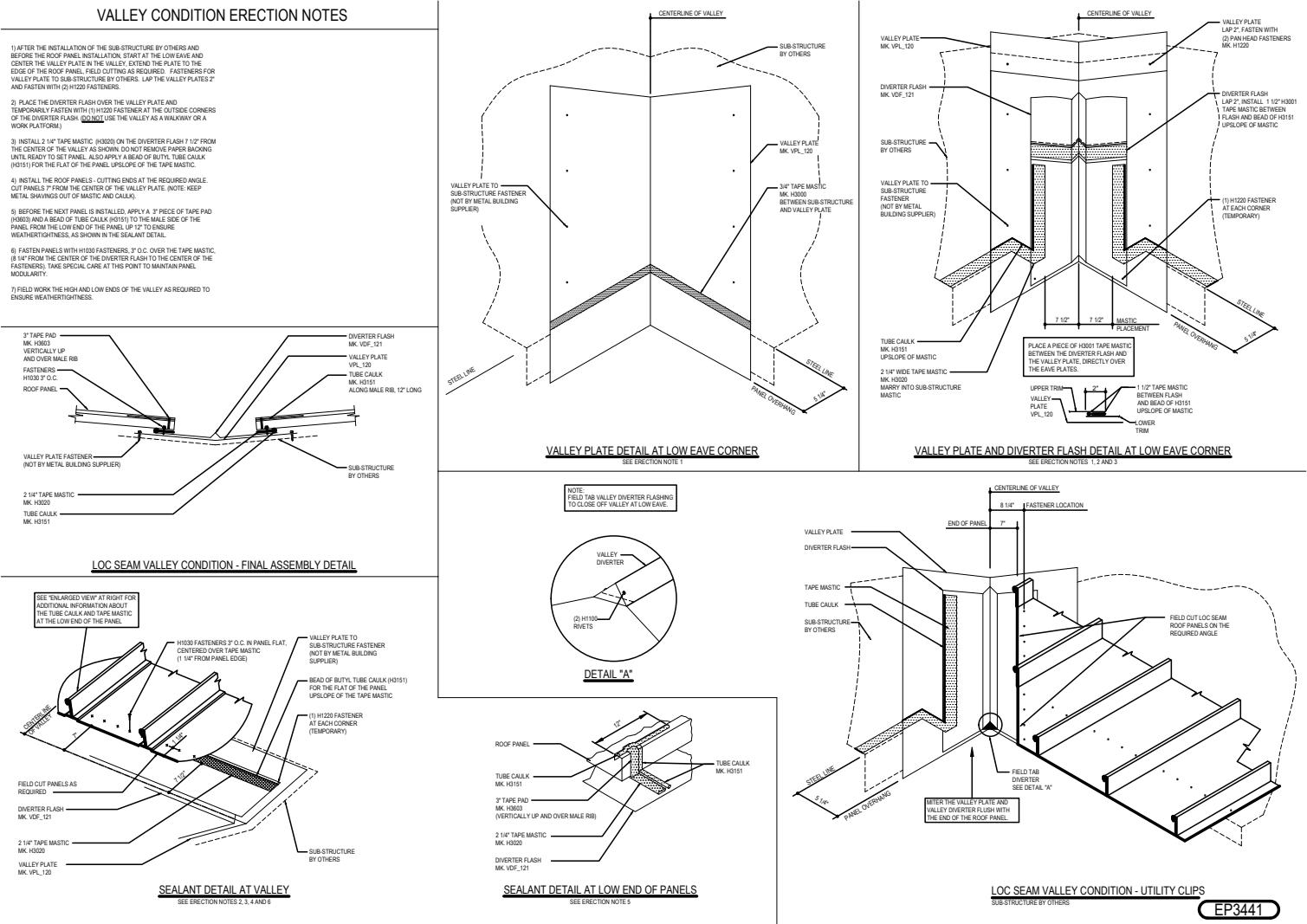

Detailer Notes:

1) N/A