

HIP AND VALLEY

EP6020 - SS360 HIP

EP6020 - SSII HIP

EP6040 - SS360 VALLEY

EP6040 - SSII VALLEY

EP6020 - SS360 HIP CONDITION

Download the DWG file by clicking [here](#).

HIP CONDITION ERECTION NOTES (INSULATED CONDITION)

- 1) INSTALL THE EAVE PLATES AS SHOWN AT RIGHT. MITER CORNERS AND CAULK THE EAVE PLATES AT THE CORNER WITH H1012 TUBE CAULK.
- 2) AFTER THE INSTALLATION OF THE EAVE PLATES AND BEFORE ROOF PANEL INSTALLATION, START AT THE LOW EAVE AND RUN PARALLEL ANGLE ALONG BOTH SIDES OF THE HP AS SHOWN IN EAVE PLATE AND ANGLE DETAIL. COPE THE VERTICAL LEG OF THE ANGLE AT EACH PURLIN LOCATION. FASTEN ANGLE TO PURLINS WITH (2) H1020 FASTENERS AT EACH PURLIN LOCATION.
- 3) IF THE INSULATION PAN (HP-120) IS SUPPLIED, INSTALL INSULATION PAN OVER PURLINS AND FASTEN AT EACH SUPPORT WITH (2) H1020 FASTENERS. DRAPE THE INSULATION OVER THE INSULATION PAN AND FASTEN WITH H1020 SCREWS AND H220 INSULATION WASHERS. IF INSULATION PAN NOT SUPPLIED, DRAPE INSULATION OVER (H1020) ANGLES AND FASTEN WITH H1020 SCREWS AND H220 INSULATION WASHERS.
- 4) INSTALL THE ROOF PANELS. FIELD CUT THE PANELS AT THE REQUIRED ANGLE. 2" DOWN FROM THE HP CENTERLINE. THEN INSTALL THE HBT120 AT THE END OF THE PANEL CUT EDGE. FASTEN WITH (1) H1020 FASTENER PER PANEL.
- 5) INSTALL THE OUTSIDE CLOSURES, ALONG WITH THE FOLLOWING NOTES 6 AND 7 BELOW. REFER TO THE OUTSIDE CLOSURE MODIFICATION METHOD DETAILS BELOW FOR FURTHER INSTRUCTIONS OF HOW TO MODIFY AND INSTALL THE OUTSIDE CLOSURES.
- 6) APPLY 1 1/2" TAPE MASTIC (H3001) TO THE BOTTOM OF THE MODIFIED OUTSIDE CLOSURES. THEN PLACE THE VERTICAL LEG OF THE OUTSIDE CLOSURES 3" FROM THE EDGE OF THE HBT120. FASTEN CLOSURES INTO PANEL AND THROUGH THE HBT120 BACKER WITH (2) H1020 SCREWS, AND (1) AT EACH SHOULDER. INSPECT FOR WEATHERTIGHTNESS AND APPLY TUBE CAULK (H1012) AS REQUIRED.
- 7) APPLY 1 1/2" TAPE MASTIC (H3001) TO THE TOP OF THE MODIFIED OUTSIDE CLOSURES. AT THE GAP BETWEEN THE OUTSIDE CLOSURES, APPLY A SECTION OF THE RIB JAY (H1012) WITH (2) H1020 FASTENERS AND (2) LAYERS OF 1 1/2" TAPE MASTIC (H3001) ON THE PANEL RIB ACROSS THE RIB JAY. SEE RIB JAY AND MASTIC INSTALLATION SECTION FOR GUIDANCE.
- 8) INSTALL THE HP FLASH BY CENTERING IT OVER THE MODIFIED OUTSIDE CLOSURES AND FASTEN WITH H1020 SCREWS AT 16" ON CENTER.
- 9) FIELD WORK THE HP FLASH AS REQUIRED AT THE ENDS TO ENSURE WEATHERTIGHTNESS. REFER TO THE DETAILS AT FAR RIGHT FOR A SUGGESTED METHOD OF TRANSITIONING THE HP FLASH INTO THE RIDGE CAP.

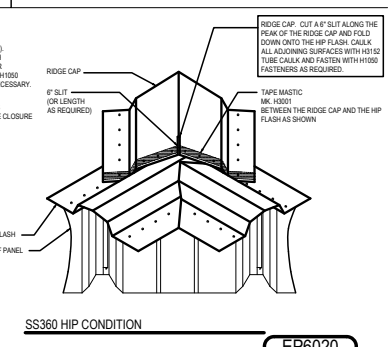
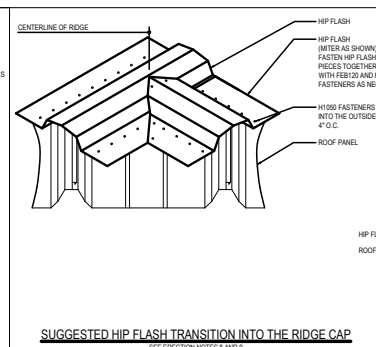
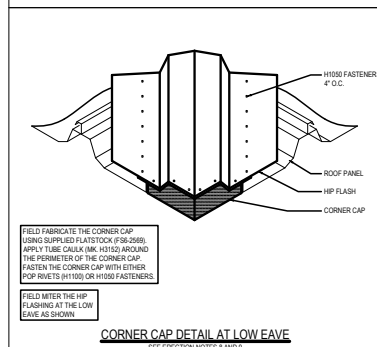
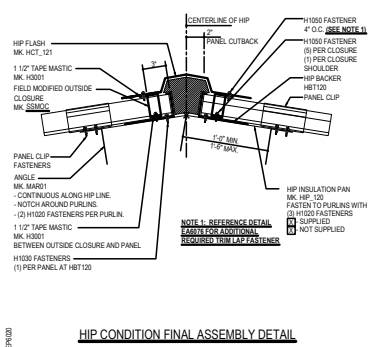
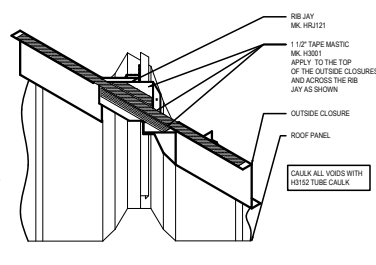
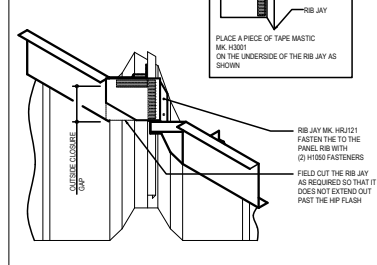
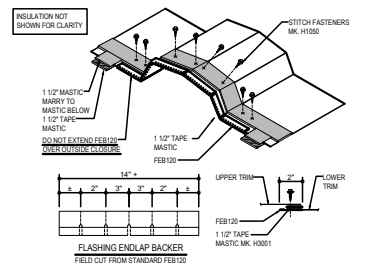
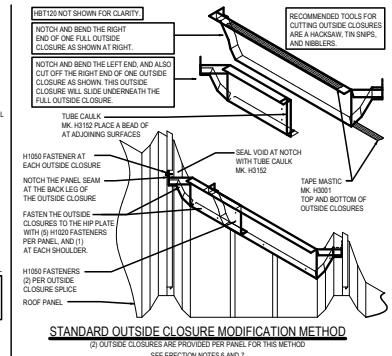
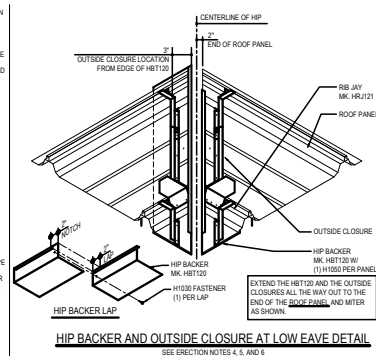
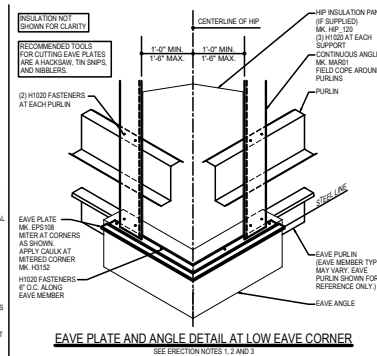

Detailer Notes:

- 1) N/A

EP6020 - SSII HIP CONDITION

Download the DWG file by clicking [here](#).

HIP CONDITION ERECTION NOTES (INSULATED CONDITION)

- 1) INSTALL THE EAVE PLATES AS SHOWN AT RIGHT. MITER CORNERS AND CAULK THE EAVE PLATES AT THE CORNER WITH H1012 TUBE CAULK.
- 2) AFTER THE INSTALLATION OF THE EAVE PLATES AND BEFORE ROOF PANEL INSTALLATION, START AT THE LOW EAVE AND RUN PARALLEL ANGLE ALONG BOTH SIDES OF THE HIP AS SHOWN IN EAVE PLATE AND ANGLE DETAIL. COPE THE VERTICAL LEG OF THE ANGLE AT EACH PURLINE LOCATION. FASTEN ANGLE TO PURLINS WITH (2) H1020 FASTENERS AT EACH PURLINE LOCATION.
- 3) IF THE INSULATION PAN (HP-120) IS SUPPLIED, INSTALL INSULATION PAN OVER PURLINE AND FASTEN AT EACH SUPPORT WITH (2) H1020 FASTENERS. DRAPE THE INSULATION PAN OVER THE INSULATION PAN AND FASTEN WITH H1020 SCREWS AND H200 INSULATION WASHERS. IF INSULATION PAN NOT SUPPLIED, DRAPE INSULATION (MARI) ANGLE AND FASTEN WITH H1020 SCREWS AND H200 INSULATION WASHERS.
- 4) INSTALL THE ROOF PANELS. FIELD CUT THE PANELS AT THE REQUIRED ANGLE. 2" DOWN FROM THE HIP CENTERLINE. THEN INSTALL THE HBT120 AT THE END OF THE PANEL CUT EDGE. FASTEN WITH (1) H1020 FASTENER PER PANEL.
- 5) INSTALL THE OUTSIDE CLOSURES, ALONG WITH THE FOLLOWING NOTES 6 AND 7 BELOW. REFER TO THE OUTSIDE CLOSURE MODIFICATION METHOD DETAILS BELOW FOR FURTHER INSTRUCTIONS OF HOW TO MODIFY AND INSTALL THE OUTSIDE CLOSURES.
- 6) APPLY 1 1/2" TAPE MASTIC (H3001) TO THE BOTTOM OF THE MODIFIED OUTSIDE CLOSURES. THEN PLACE THE VERTICAL LEG OF THE OUTSIDE CLOSURES 3" FROM THE EDGE OF THE HBT120. FASTEN CLOSURES INTO PANEL AND THROUGH THE HBT120 BACKER WITH (2) H1020 SCREWS, AND (1) AT EACH SHOULDER. INSPECT FOR WEATHERTIGHTNESS AND APPLY TUBE CAULK (H1012) AS REQUIRED.
- 7) APPLY 1 1/2" TAPE MASTIC (H3001) TO THE TOP OF THE MODIFIED OUTSIDE CLOSURES. AT THE GAP BETWEEN THE OUTSIDE CLOSURES, APPLY A SECTION OF THE RIB JAY (H1012) WITH (2) H1020 FASTENERS AND (2) LAYERS OF 1 1/2" TAPE MASTIC (H3001) ON THE PANEL RIB ACROSS THE RIB JAY. SEE RIB JAY AND MASTIC INSTALLATION SECTION FOR GUIDANCE.
- 8) INSTALL THE HIP FLASH BY CENTERING IT OVER THE MODIFIED OUTSIDE CLOSURES AND FASTEN WITH H1020 SCREWS AT 16" ON CENTER.
- 9) FIELD WORK THE HIP FLASH AS REQUIRED AT THE ENDS TO ENSURE WEATHERTIGHTNESS. REFER TO THE DETAILS AT FAR RIGHT FOR A SUGGESTED METHOD OF TRANSITIONING THE HIP FLASH INTO THE RIDGE CAP.

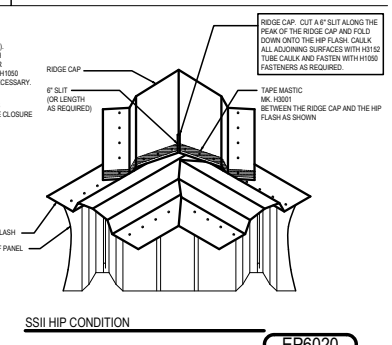
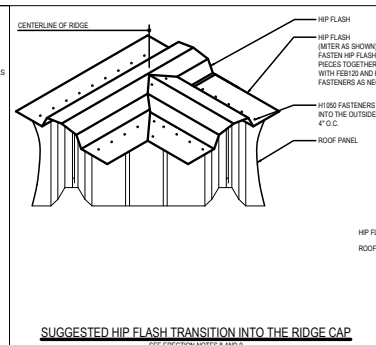
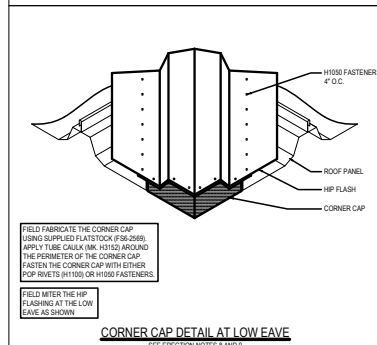
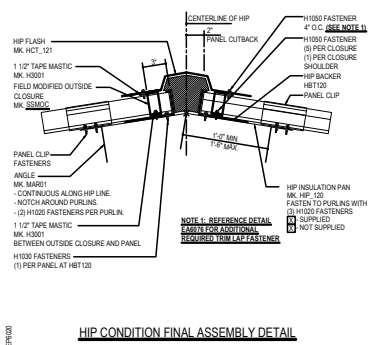
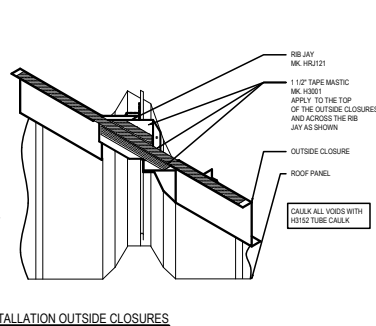
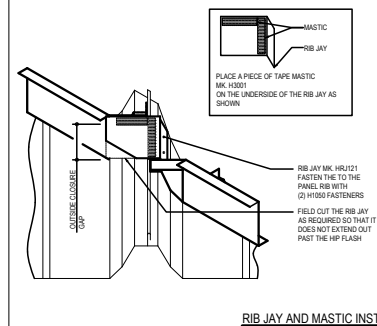
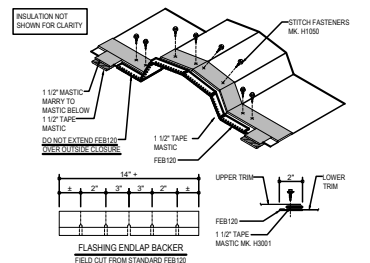
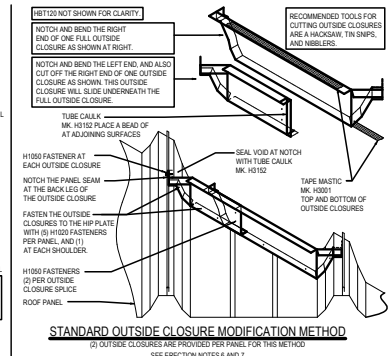
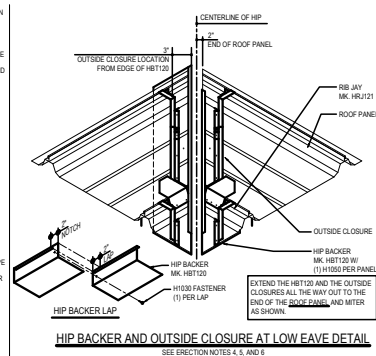
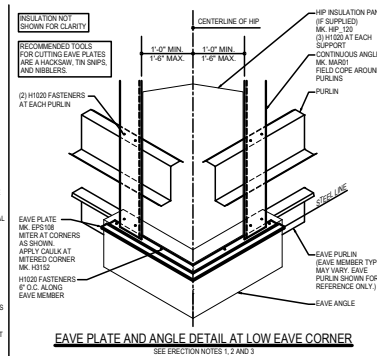

Detailer Notes:

1) N/A

[Download the DWG file by clicking here.](#)

1. INSTALL THE EAVE GABLES AND EAVE FLASHING AS SHOWN AT RIGHT. CLASP THE EAVE PLATES AT THE CORNERS WITH H1012 TUBE. REFER TO THE INSTALLATION PLAN FOR FURTHER GUIDANCE.
2. NEXT, TO INSULATION PANEL 1 (SUPPLIED), START AT THE LOW EAVE AND PLACE THE INSULATION PANEL IN THE VALLEY AND FASTEN WITH #1 H1020 FASTENERS AT EACH CORNER. FIELD WITH THE INSULATION PANEL AT THE EAVE PLATE. LAP THE INSULATION PANEL 2" AND FASTEN WITH #4 H1020 FASTENERS.
3. INSTALL THE INSULATION OVER THE INSULATION PANEL. IF NO INSULATION PANEL, INSTALL INSULATION OVER PURLIN. EITHER CASE, FASTEN WITH H1020 FASTENERS AND H1020 INSULATION WINDERS AS REQUIRED.
4. NEXT, START AT THE LOW EAVE AND PLACE THE HAT CHANNEL. FASTEN WITH H1020 FASTENERS AT EACH CORNER AND 12" ON CENTER. CONTINUE THE CHANNEL AS SHOWN. FASTEN TO EACH PURLIN WITH #2 H1020 FASTENERS.
5. CONTINUE THE VALLEY PLATE OVER THE HAT SECTIONS. AT THE EAVE & ROOF, EXTEND THE PLATE TO THE EDGE OF THE ROOF PANEL. FIELD CUTTING AS REQUIRED. FASTEN VALLEY PLATE TO HAT CHANNEL, NISSE WITH H1020 FASTENERS. FASTEN AS SHOWN. LAP THE VALLEY PLATE 2" AND FASTEN WITH #2 H1020 FASTENERS.
6. PLACE THE DIVERSTER FLASH OVER THE VALLEY PLATE AND TEMPORARILY FASTEN WITH #1 H1020 FASTENERS AT THE OUTSIDE CORNERS OF THE VALLEY. **DO NOT** USE THE VALLEY AS A DRAIN OR A WORK PLATFORM.
7. INSTALL 2" HAT TAPER MASTIC (H020) ON THE DIVERSTER FLASH 12" FROM THE CENTER OF THE VALLEY AS SHOWN. DO NOT REMOVE PAPER BACKING FROM VALLEY TO SET PANEL. ALSO APPLY A BEAD OF BUTYL TUBE (H013) FOR THE FLAT OF THE PANEL. UPLAP THE TAPER MASTIC 12" FROM THE CENTER OF THE VALLEY.
8. INSTALL THE ROOF PANELS, CUTTING EDGES AT THE REQUIRED ANGLE. PANELS 7.5" FROM THE CENTER OF THE VALLEY PLATE. NOTE: KEEP MASTIC SHAVINGS OUT OF MASTIC AND CLASP. REMOVE TEMPORARY DIVERSTER FASTENERS IF REQUIRED.
9. INSTALL THE MASTIC VEE DOG CLOSURE.
AS THE PANELS ARE BEING INSTALLED, REMOVE THE PAPER BACKING FROM THE 2" TAPER MASTIC AND SEAL THE VEE DOG CLOSURE IN THE MASTIC WITH H1020 FASTENERS. FASTEN WITH H1020 FASTENERS AT THE CORNERS AND 12" ON CENTER. FASTEN TO EACH HAT CHANNEL WITH #2 H040 AND A BEAD OF BUTYL TUBE TO THE CLOSURE. SEE DETAIL BELOW.
10. BEFORE THE NEXT PANEL IS INSTALLED, APPLY A BEAD OF TUBE CLASP (H013) TO THE MALE SIDE OF THE PANEL FROM THE LOW END OF THE PANEL UP TO ENSURE WEATHERTIGHTNESS, AS SHOWN IN THE CALX DETAIL.
11. FASTEN PANELS WITH H1020 FASTENERS 12" O.C. OVER THE TAPER MASTIC AND 24" O.C. OVER THE BUTYL TUBE. FASTEN TO THE CENTER OF THE FASTENERS. TAKE SPECIAL CARE AT THIS POINT TO MAINTAIN PANEL MODULITY.
12. FIELD WORK THE HIGH AND LOW ENDS OF THE VALLEY AS REQUIRED TO ENSURE WEATHERTIGHTNESS.

METAL VOID CLOSURE MK. SS36C WITH (1) PIECE OF TAPE MASTIC (H040) AND HEAD OF TUBE CALK (H015) FASTEN WITH (2) H1020 FASTENERS

DIVERTER FLASH MK. VDF_121

VALLEY PLATE MK. VPL_120

ROOF PANEL

(1) H1020 FASTENER AT EACH PANEL RIB

INSULATION PAN MK. VIP_125

2" NOT SUPPLIED

LAP INSULATION PAN 2" AND FASTEN WITH (4) H1020 FASTENERS

HAT CHANNEL MK. HAT_120 WITH (2) H1020 FASTENERS AT EACH SUPPORT

TUBE CALK MK. H015

PURLIN

2" 14" TAPE MASTIC MK. H020

SS360 VALLEY FINAL ASSEMBLY DETAIL

H1030 FASTENERS 2 1/2" O.C. IN PANEL FLAT, CENTERED OVER TAPE MASTIC (1 1/4" FROM PANEL EDGES)

BEAD OF BUTYL TUBE CAULK (H1051) FOR THE FLAT OF THE PANEL UPSLOPE OF THE TAPE MASTIC

(1) H1030 FASTENER AT EACH PANEL RIB LOCATION

(1) H1051 FASTENER AT EACH CORNER (TEMPORARY)

HAT CHANNEL MK. HAT-120

METAL VOID CLOSURE INSIDE PANEL RIB. SEE ENLARGEMENT TO RIGHT FOR SEALANT PLACEMENT

FIELD CUT PANELS AS REQUIRED

DIVERTER FLASH MK. VDF-121

2 1/4" TAPE MASTIC MK. H1051

H1051 BUT OF TOP OF TAPE MASTIC

ADDITIONAL TAPE MASTIC MK. H1051 CLOSURE

DOWN SLOPE

PURLINE

VALLEY PLATE
MK. VPL-120

INSULATION PAN
(IF SUPPLIED)
MK. VIP-120

MASTIC AND VOID CLOSURE DETAIL
SEE ERECTION NOTES & 9, 10, AND 11

Technical drawing showing two cross-sections of a roof assembly, labeled "12:12" and "12:12".

Top Section Labels:

- H1020 FASTENERS AT 8" ON CENTER ALONG LOW EAVE
- H1020 FASTENERS AT 8" ON CENTER (OVER HOLE)
- H001 TAPE MASTIC CONTINUOUS UNDER EAVE PLATE
- EAVE PURLIN (EAVE MEMBER TYPE MAY VARY. EAVE PURLIN SHOWN FOR REFERENCE ONLY)
- 12:12 GALK AT CORNER OF EAVE PLATES
- EAVE ANGLE (REG'D WITH EAVE PURLIN ONLY)
- H001 TAPE MASTIC CONTINUOUS ON TOP OF EAVE PLATE
- EAVE PLATE MITER AT CORNER AS SHOWN
- INSULATION PAN (IF SUPPLIED) MIN. UP 12"
- HAT CHANNEL MIN. UP 12"
- (2) H1020 FASTENERS AT EACH SUPPORT

Bottom Section Labels:

- ATTACH THE INSULATION PAN WITH (1) H1020 FASTENER AT EACH PURLIN
- EAVE ANGLE
- EAVE PLATE
- STEEL LINE

Dimensions:

- 1" 8"
- CENTER LINE OF PURLIN
- 1" 8"

Diagram illustrating the components and assembly of a roof panel closure:

- 6" BEAD OF H3151 BUTYL CAULK ON VERTICAL AND HORIZONTAL OF INBLE RIB
- 2) H1025 FASTENERS INTO CLOSURE
- CAULK ON MASTIC
- 1/4" TAPE H2041 APPLICATION
- ROOF PANEL
- CONTINUATION OF INBLE
- 1/4" TAPE PAD (BK. H2050)
- FORM MANY EXCESS MASTIC THAT IS NOT UNDER PANEL CLOSURE
- METAL CLOSURE (BK. S2041)
- INVERTER FLASH
- POURED OFF

Detailer Notes:

1) N/A

EP6040 - SSII VALLEY CONDITION
Download the DWG file by clicking here.

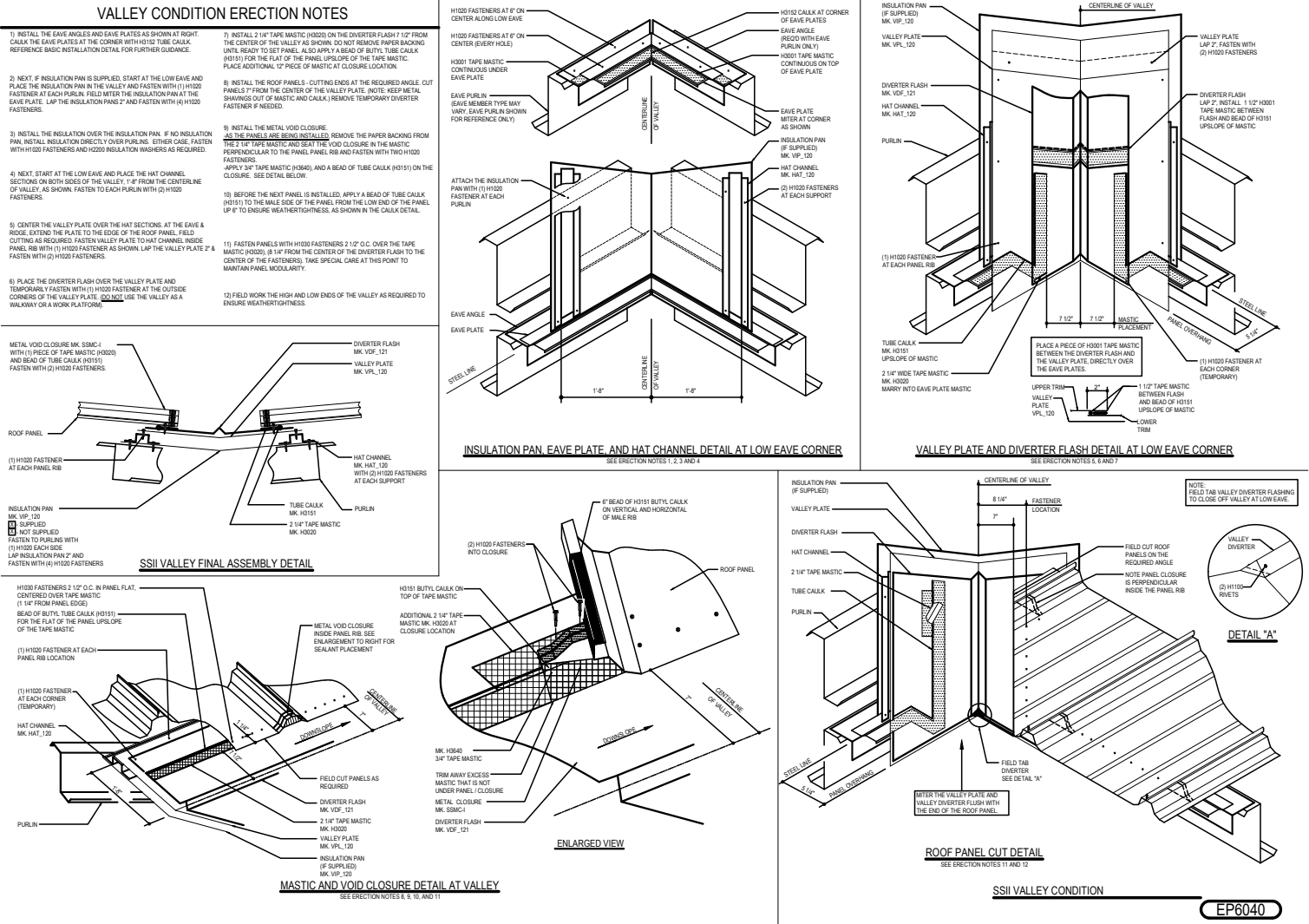

Detailer Notes:

1) N/A