

HIP AND VALLEY

- EP6020 - CFR HIP

EP6040 - CFR VALLEY

EP6020 - CFR HIP CONDITION

Download the DWG file by clicking here.

HIP CONDITION ERECTION NOTES (INSULATED CONDITION)

- 1) INSTALL THE EAVE PLATES AS SHOWN AT RIGHT. MITER CORNERS AND CAULK THE EAVE PLATES AT THE CORNER WITH H1012 TUBE CAULK.
- 2) AFTER THE INSTALLATION OF THE EAVE PLATES AND BEFORE ROOF PANEL INSTALLATION, START AT THE LOW EAVE AND RUN MARSH ANGLE ALONG BOTH SIDES OF THE HIP AS SHOWN IN EAVE PLATE AND ANGLE DETAIL. COPY THE VERTICAL LEG OF THE ANGLE AT EACH PURLIN LOCATION. FASTEN ANGLE TO PURLINS WITH (2) H1030 FASTENERS AT EACH PURLIN LOCATION.
- 3) IF THE INSULATION PAN (HP-120) IS SUPPLIED, INSTALL INSULATION PAN OVER PURLINS AND FASTEN AT EACH SUPPORT WITH (2) H1030 FASTENERS. DRAPE THE INSULATION PAN AND FASTEN WITH H1030 SCREWS AND H2000 INSULATION WASHERS. IF INSULATION PANS NOT SUPPLIED, DRAPE INSULATION (MARSH MAR1) ANGLE AND FASTEN WITH H1030 SCREWS AND H2000 INSULATION WASHERS.
- 4) INSTALL THE ROOF PANELS. FIELD OUT THE PANELS AT THE REQUIRED ANGLE, 2" DOWN FROM THE HIP CENTERLINE. THEN INSTALL THE HET120 AT THE END OF THE PANEL, CUT EDGE. FASTEN WITH (1) H1030 FASTENER PER PANEL.
- 5) INSTALL THE OUTSIDE CLOSURES, ALONG WITH THE FOLLOWING NOTES 8 AND 7 BELOW. REFER TO THE OUTSIDE CLOSURE MODIFICATION METHOD DETAILS BELOW FOR FURTHER INSTRUCTIONS OF HOW TO MODIFY AND INSTALL THE OUTSIDE CLOSURES.
- 6) APPLY 1 1/2" TAPE MASTIC (H3001) TO THE BOTTOM OF THE MODIFIED OUTSIDE CLOSURES. THEN PLACE THE VERTICAL LEG OF THE OUTSIDE CLOSURES 3" FROM THE EDGE OF THE HET120. FASTEN CLOSURES INTO PANEL AND THROUGH THE HET120 BACKER WITH (2) H1030 SCREWS, AND (1) AT EACH SHOULDER. INSPECT FOR WEATHERTIGHTNESS AND APPLY TUBE CAULK (H1012) AS REQUIRED.
- 7) APPLY 1 1/2" TAPE MASTIC (H3001) TO THE TOP OF THE MODIFIED OUTSIDE CLOSURES. AT THE GAP BETWEEN THE OUTSIDE CLOSURES, APPLY A SECTION OF THE RIB JAY (HR121) WITH (2) H1030 FASTENERS AND (2) LAYERS OF 1 1/2" TAPE MASTIC (H3001) ON THE PANEL RIB ACROSS THE RIB JAY. SEE RIB JAY AND MASTIC INSTALLATION SECTION FOR GUIDANCE.
- 8) INSTALL THE HIP FLASH BY CENTERING IT OVER THE MODIFIED OUTSIDE CLOSURES AND FASTEN WITH H1030 SCREWS AT 8" ON CENTER.
- 9) FIELD WORK THE HIP FLASH AS REQUIRED AT THE ENDS TO ENSURE WEATHERTIGHTNESS. REFER TO THE DETAILS AT FAR RIGHT FOR A SUGGESTED METHOD OF TRANSITIONING THE HIP FLASH INTO THE RIDGE CAP.

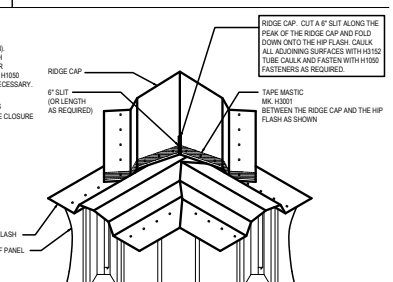
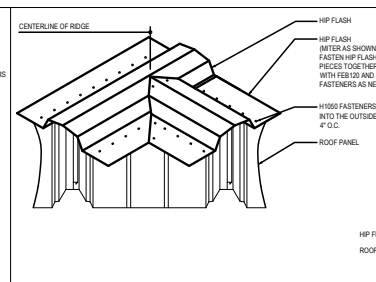
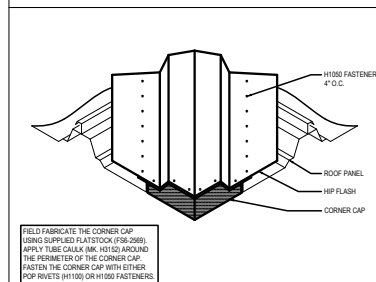
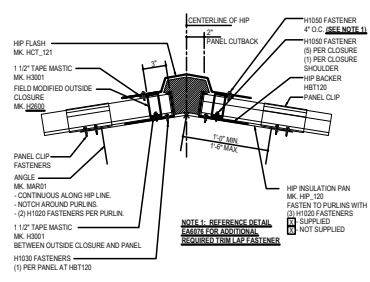
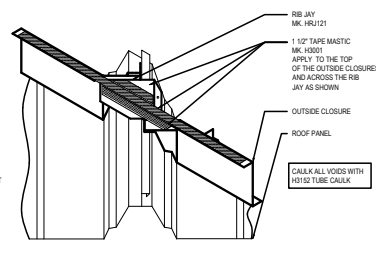
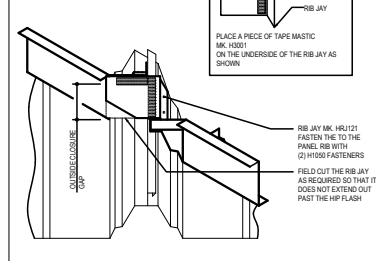
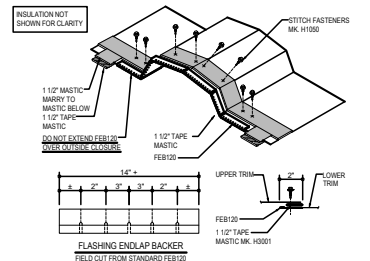
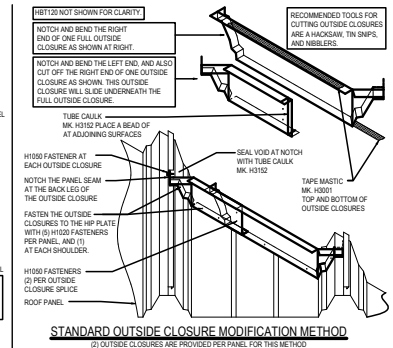
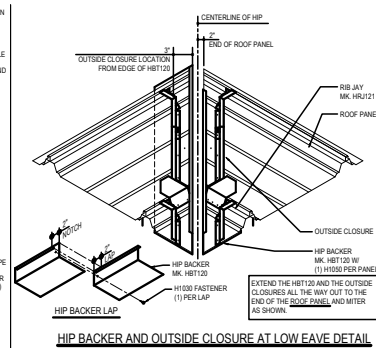
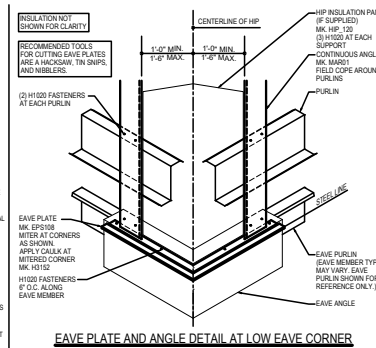

Detailer Notes:

- 1) N/A

EP6040 - CFR VALLEY CONDITION

Download the DWG file by clicking here.

VALLEY CONDITION ERECTION NOTES

- 1) INSTALL THE EAVE ANGLES AND EAVE PLATES AS SHOWN AT RIGHT. CAULK THE EAVE PLATES AT THE CORNER WITH H1012 TUBE CAULK. REFERENCE BASIC INSTALLATION DETAIL FOR FURTHER GUIDANCE.
- 2) NEXT, IF INSULATION PAN IS SUPPLIED, START AT THE LOW EAVE AND PLACE THE INSULATION PAN IN THE VALLEY AND FASTEN WITH (1) H1020 FASTENER AT EACH PURLIN. FIELD AFTER THE INSULATION PAN AT THE EAVE PLATE. LAP THE INSULATION PAN 2" AND FASTEN WITH (4) H1020 FASTENERS.
- 3) INSTALL THE INSULATION OVER THE INSULATION PAN. IF NO INSULATION PAN, INSTALL INSULATION DIRECTLY OVER PURLIN. EITHER CASE, FASTEN WITH H1020 FASTENERS AND H2000 INSULATION WASHERS AS REQUIRED.
- 4) NEXT, START AT THE LOW EAVE AND PLACE THE HAT CHANNEL SECTIONS ON BOTH SIDES OF THE VALLEY. 1" IF FROM THE CENTERLINE OF VALLEY, AS SHOWN. FASTEN TO EACH PURLIN WITH (2) H1020 FASTENERS.
- 5) CENTER THE VALLEY PLATE OVER THE HAT SECTIONS. AT THE EAVE & RIDGE, EXTEND THE PLATE TO THE EDGE OF THE ROOF PANEL. FIELD CUTTING AS REQUIRED. FASTEN VALLEY PLATE TO HAT CHANNEL INSIDE PANEL RIB WITH (1) H1020 FASTENER AS SHOWN. LAP THE VALLEY PLATE 2" & FASTEN WITH (2) H1020 FASTENERS.
- 6) PLACE THE DIVERTER FLASH OVER THE VALLEY PLATE AND TEMPORARILY FASTEN WITH (1) H1020 FASTENER AT THE OUTSIDE CORNER OF THE VALLEY PLATE. DO NOT USE THE VALLEY AS A WALKWAY OR A WORK PLATFORM.
- 7) INSTALL 2 1/4" TAPE MASTIC (H2020) ON THE DIVERTER FLASH 1 1/2" FROM THE CENTER OF THE VALLEY AS SHOWN. DO NOT REMOVE PAPER BACKING UNTIL READY TO SET PANEL. ALSO APPLY A BEAD OF BUTYL TUBE CAULK (H0151) FOR THE FLAT OF THE PANEL UPSLOPE OF THE TAPE MASTIC.
- 8) INSTALL THE ROOF PANELS. CUTTING ENDS AT THE REQUIRED ANGLE. CUT PANELS 7" FROM THE CENTER OF THE VALLEY PLATE. (NOTE: KEEP METAL SHAVINGS OUT OF MASTIC AND CAULK.) REDUCE TEMPORARY DIVERTER FASTENER IF NEEDED.
- 9) INSTALL THE CFR RUBBER VOID CLOSURE. AS THE PANELS ARE BEING INSTALLED, REMOVE THE PAPER BACKING FROM THE 2 1/4" TAPE MASTIC AND SEAL THE VOID CLOSURE IN THE MASTIC AT THE END OF THE PANEL AND FASTEN WITH ONE H1020 FASTENER. APPLY (2) PIECES OF 2 1/4" TAPE MASTIC (H2020) AND A BEAD OF TUBE CAULK (H0151) ON THE CLOSURE. SEE DETAIL BELOW.
- 10) BEFORE THE NEXT PANEL IS INSTALLED, APPLY A BEAD OF TUBE CAULK (H0151) TO THE MALE SIDE OF THE PANEL FROM THE LOW END OF THE PANEL UP 8" TO ENSURE WEATHERTIGHTNESS, AS SHOWN IN THE CAULK DETAIL.
- 11) FASTEN PANELS WITH H1020 FASTENERS 2 1/2" O.C. OVER THE TAPE MASTIC (H2020). 8 1/4" FROM THE CENTER OF THE DIVERTER FLASH TO THE CENTER OF THE FASTENERS. TAKE SPECIAL CARE AT THIS POINT TO MAINTAIN PANEL PARALLELITY.
- 12) FIELD WORK THE HIGH AND LOW ENDS OF THE VALLEY AS REQUIRED TO ENSURE WEATHERTIGHTNESS.

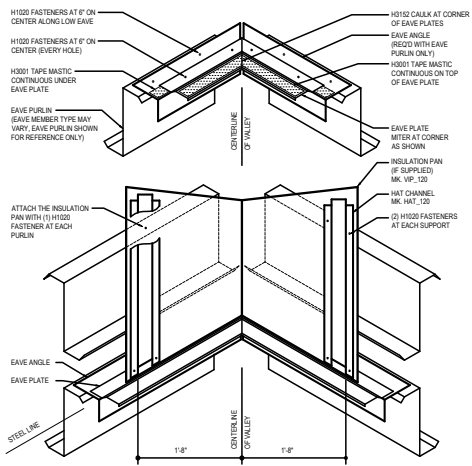

INSULATION PAN, EAVE PLATE, AND HAT CHANNEL DETAIL AT LOW EAVE CORNER
SEE ERECTION NOTES 1, 2, 3 AND 4

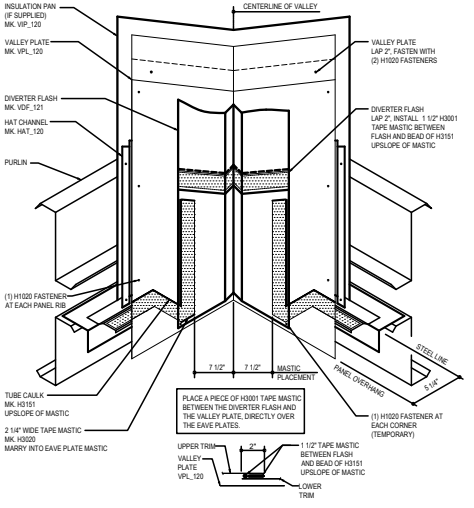

VALLEY PLATE AND DIVERTER FLASH DETAIL AT LOW EAVE CORNER
SEE ERECTION NOTES 5, 6 AND 7

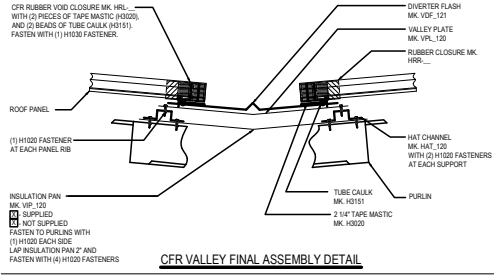

CFR VALLEY FINAL ASSEMBLY DETAIL

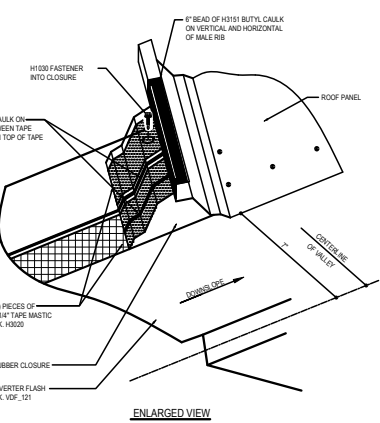

ENLARGED VIEW

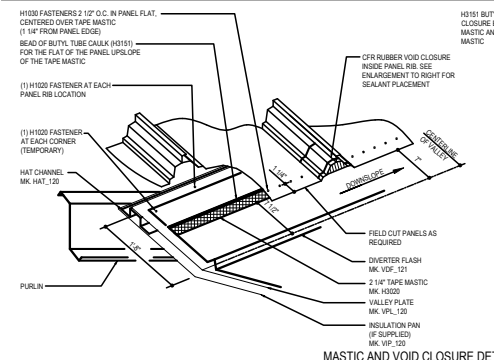

MASTIC AND VOID CLOSURE DETAIL AT VALLEY
SEE ERECTION NOTES 8, 9, 10, AND 11

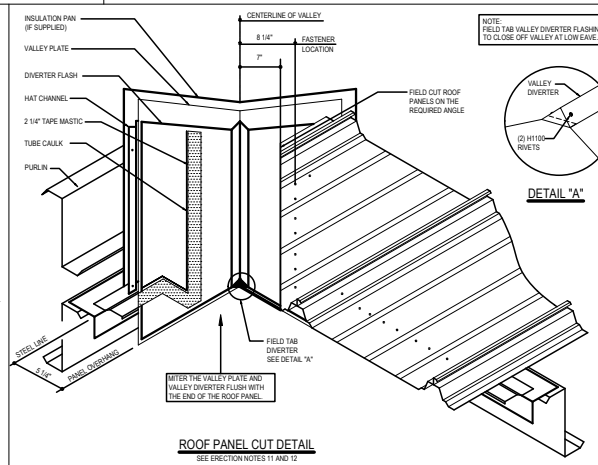

ROOF PANEL CUT DETAIL
SEE ERECTION NOTES 11 AND 12

CFR VALLEY CONDITION

EP6040

Detailer Notes:

- 1) N/A