

RAKE (PARAPET)

- EF6010 - RAKE PARAPET WALL ABOVE
 - EF6030 - RAKE PARAPET MASONRY WALL
 - EF6050 - RAKE PARAPET RAFTER IN HIGH BLDG
 - EF6060 - RAKE PARAPET RAFTER IN LOW BLDG
 - EF6090 - NON-STRUCTURAL PARAPET
 - EF6610 - RAKE PARAPET INSULATED WALL ABOVE
 - EF6650 - RAKE PARAPET INSULATED WALL ABOVE & BELOW
 - EF6690 - NON-STRUCTURAL PARAPET - IMP WITH BACKER
-

EF6010 - RAKE PARAPET w/ WALL PANEL ABOVE

[Download the DWG file by clicking here.](#)

PARAPET LAP & FLASHING BACKER

SLIDE FIELD CUT SECTION OF FLASHING ENDLAP BACKER ONTO THE LOWER TRIM PIECE AS SHOWN BELOW. PLACE TAPE MASTIC NEXT TO HEM OF THE BACKER (NOT ON TOP OF HEM). FASTEN LAP WITH STITCH FASTENERS. ROOF STRUCTURAL FASTENERS SHOULD BE USED TO FASTEN THROUGH PANEL FLAT INTO RAKE ANGLE.

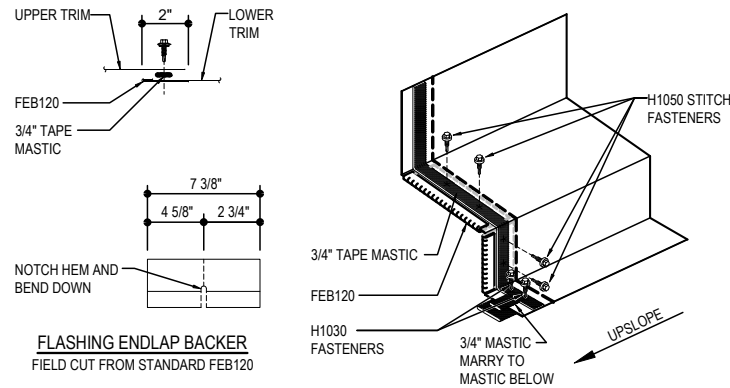

NOTE 1: KEEP FASTENERS 2"
AWAY FROM RAKE CLIPS!!

**NOTE 2: AS A STANDARD, PANELS
WILL BE STEPPED IF ROOF SLOPE
IS < 1/2:12**
**FIELD MITERING WILL BE REQUIRED
IF ROOF SLOPE IS > 1/2:12**

ERECTOR NOTE: _____
PLACE WALL FASENERS THROUGH
RAKE ANGLE ONLY.
DO NOT PLACE WALL FASTENERS
THROUGH RAKE PARAPET TRIM.

WALL PANEL (SEE NOTE 2)

WALL PANEL CLOSURE	
R-PANEL	MK. CIR
A-PANEL	MK. CIA
REV. PANEL	MK. CIV

w/ 3/4" TAPE MASTIC MK. H3000
AT TOP AND BOTTOM OF CLOSURE

- RAKE PARAPET TRIM
MK. RPU121
(ANGLED FOR POSTIVE DRAINAGE)
- H1030 FASTENERS 4" O.C.
(SEE NOTE 1)

2 1/4" TAPE MASTIC MK. H3020
BETWEEN TRIM & ROOF PANEL
(APPLY MASTIC TO TRIM PRIOR
TO INSTALLING TRIM)

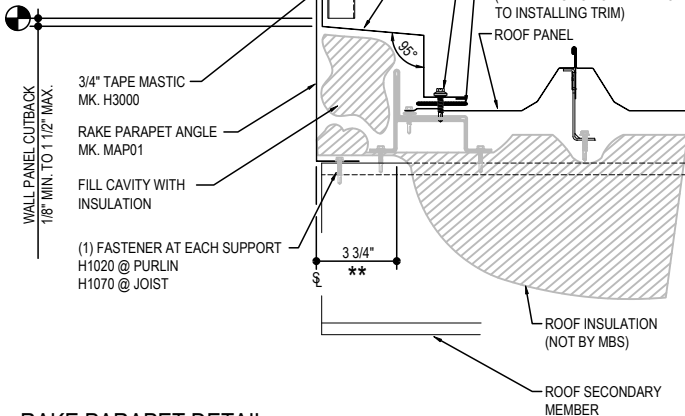

RAKE PARAPET DETAIL

RAKE PARAPET DETAIL w/ WALL PANELS
SEE WALL SHEETING ERECTION NOTES FOR WALL PANEL FASTENER LOCATIONS

EF6010

Detailer Notes:

1) N/A

EF6030 - RAKE PARAPET w/ MASONRY WALL

[Download the DWG file by clicking here.](#)

PARAPET LAP & FLASHING BACKER

SLIDE FIELD CUT SECTION OF FLASHING ENDLAP BACKER ONTO THE LOWER TRIM PIECE AS SHOWN BELOW. PLACE TAPE MASTIC NEXT TO HEM OF THE BACKER (NOT ON TOP OF HEM). FASTEN LAP WITH STITCH FASTENERS. ROOF STRUCTURAL FASTENERS SHOULD BE USED TO FASTEN THROUGH PANEL FLAT INTO RAKE ANGLE.

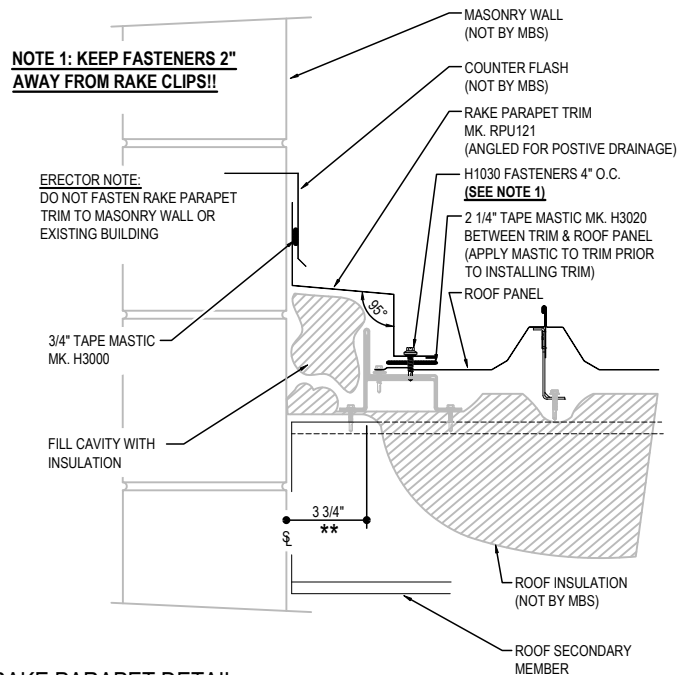
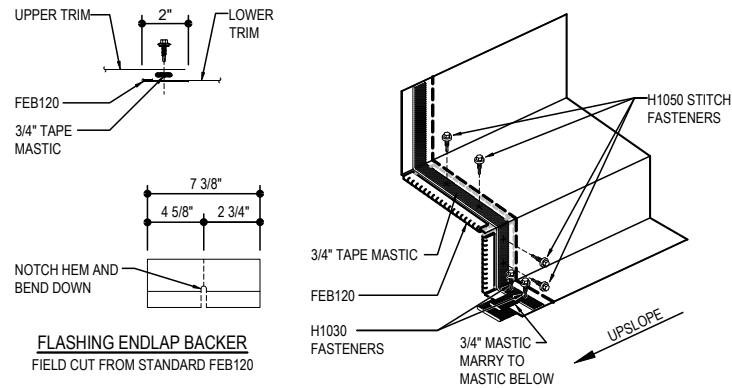

RAKE PARAPET DETAIL

RAKE PARAPET DETAIL w/ MASONRY WALL

EF6030

Detailer Notes:

1) N/A

EF6050 - RAKE PARAPET w/ RAFTER IN HIGH BUILDING

[Download the DWG file by clicking here.](#)

PARAPET LAP & FLASHING BACKER

SLIDE FIELD CUT SECTION OF FLASHING ENDLAP BACKER ONTO THE LOWER TRIM PIECE AS SHOWN BELOW. PLACE TAPE MASTIC NEXT TO HEM OF THE BACKER (NOT ON TOP OF HEM). FASTEN LAP WITH STITCH FASTENERS. ROOF STRUCTURAL FASTENERS SHOULD BE USED TO FASTEN THROUGH PANEL FLAT INTO RAKE ANGLE.

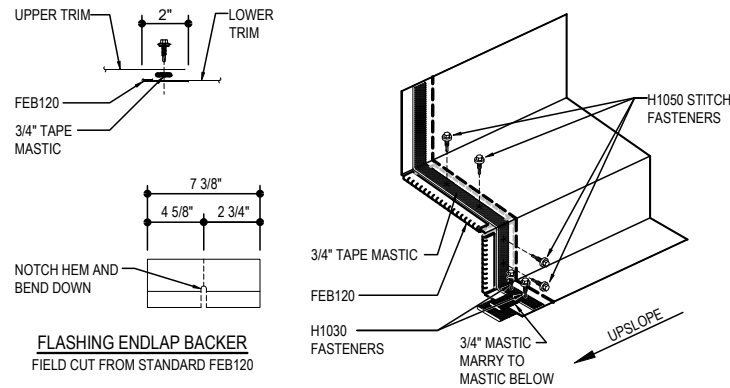

NOTE 1: KEEP FASTENERS 2"
AWAY FROM RAKE CLIPS!!

**NOTE 2: AS A STANDARD, PANELS
WILL BE STEPPED IF ROOF SLOPE
IS < 1/2:12**
**FIELD MITERING WILL BE REQUIRED
IF ROOF SLOPE IS > 1/2:12**

ERECTOR NOTE: _____
PLACE WALL FASENERS THROUGH
RAKE ANGLE ONLY.
DO NOT PLACE WALL FASTENERS
THROUGH RAKE PARAPET TRIM.

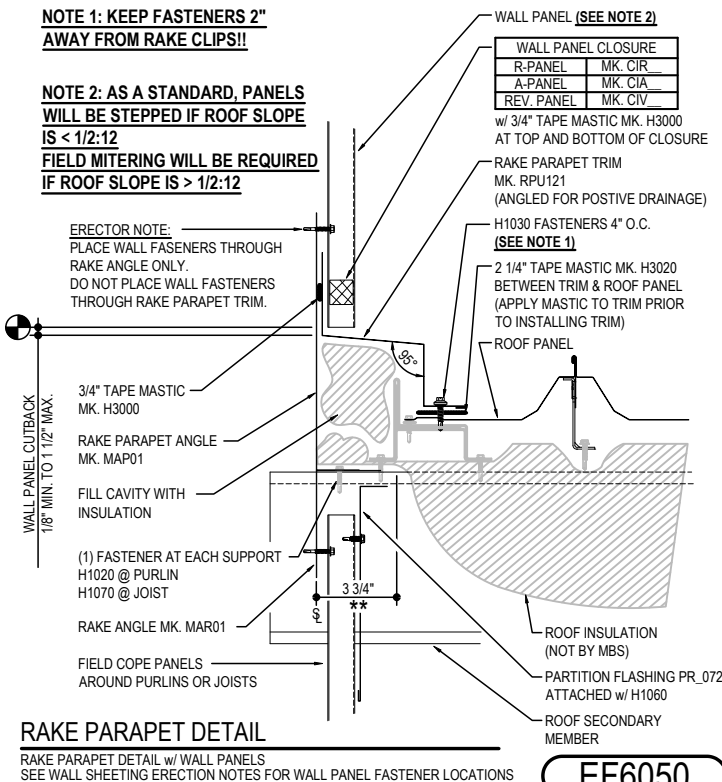

Detailer Notes:

1) N/A

EF6060 - RAKE PARAPET w/ RAFTER IN LOW BUILDING

[Download the DWG file by clicking here.](#)

PARAPET LAP & FLASHING BACKER

SLIDE FIELD CUT SECTION OF FLASHING ENDLAP BACKER ONTO THE LOWER TRIM PIECE AS SHOWN BELOW. PLACE TAPE MASTIC NEXT TO HEM OF THE BACKER (NOT ON TOP OF HEM). FASTEN LAP WITH STITCH FASTENERS. ROOF STRUCTURAL FASTENERS SHOULD BE USED TO FASTEN THROUGH PANEL FLAT INTO RAKE ANGLE.

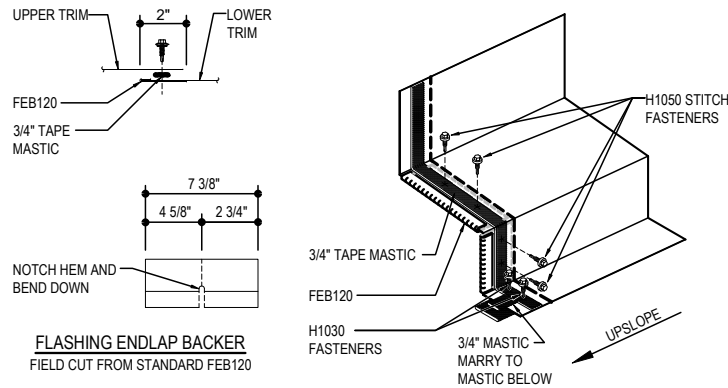

NOTE 1: KEEP FASTENERS 2"
AWAY FROM RAKE CLIPS!!

**NOTE 2: AS A STANDARD, PANELS
WILL BE STEPPED IF ROOF SLOPE
IS < 1/2:12**
**FIELD MITERING WILL BE REQUIRED
IF ROOF SLOPE IS > 1/2:12**

ERECTOR NOTE: _____
PLACE WALL FASENERS THROUGH
RAKE ANGLE ONLY.
DO NOT PLACE WALL FASTENERS
THROUGH RAKE PARAPET TRIM.

WALL PANEL (SEE NOTE 2)

WALL PANEL CLOSURE	
R-PANEL	MK. CIR
A-PANEL	MK. CIA
REV. PANEL	MK. CIV

w/ 3/4" TAPE MASTIC MK. H3000
AT TOP AND BOTTOM OF CLOSURE

— — — — —

—RAKE PARAPET TRIM
MK. RPU121
(ANGLED FOR POSTIVE DRAINAGE)

— H1030 FASTENERS 4" O.C.

(SEE NOTE 1)

2 1/4" TAPE MASTIC MK. H3020
BETWEEN TRIM & ROOF PANEL
(APPLY MASTIC TO TRIM PRIOR
TO INSTALLING TRIM)

— ROOF PANEL

WALL PANEL CUTBACK
1/8" MIN. TO 1 1/2" MAX.

3/4" TAPE
MK. H3000

RAKE PAR
MK. MAP01

FILL CAVITY
INSULATION

(1) FASTENER AT EACH SUPPORT
H1020 @ PURLIN
H1070 @ JOIST

BAKE AND

FIELD COPE PANELS —————
AROUND PURLINS OR JOISTS

— ROOF INSULATION
(NOT BY MBS)

— PARTITION FLASHING PR_072
ATTACHED w/ H1060

— ROOF SECONDARY
MEMBER

RAKE PARAPET DETAIL

RAKE PARAPET DETAIL w/ WALL PANELS
SEE WALL SHEETING ERECTION NOTES FOR WALL PANEL FASTENER LOCATIONS

EF6060

Detailer Notes:

1) N/A

EF6090 - NON-STRUCTURAL PARAPET

[Download the DWG file by clicking here.](#)

PARAPET LAP & FLASHING BACKER

SLIDE FIELD CUT SECTION OF FLASHING ENDLAP BACKER ONTO THE LOWER TRIM PIECE AS SHOWN BELOW. PLACE TAPE MASTIC NEXT TO HEM OF THE BACKER (NOT ON TOP OF HEM). FASTEN LAP WITH STITCH FASTENERS. ROOF STRUCTURAL FASTENERS SHOULD BE USED TO FASTEN THROUGH PANEL FLAT INTO RAKE ANGLE.

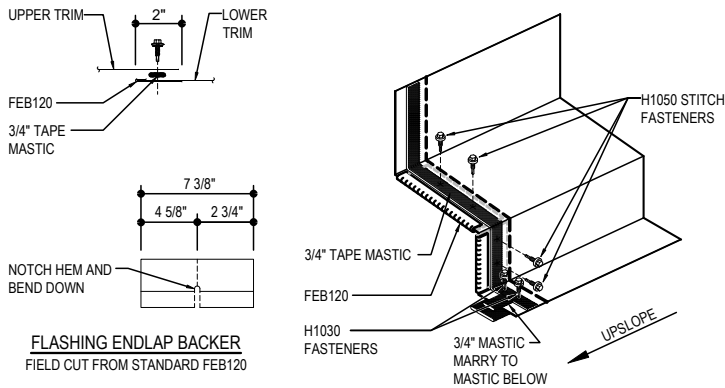

CAP TRIM LAP

APPLY CONTINUOUS BEAD OF CAULK 1" FROM END OF TRIM DOWN PROFILE OF TRIM. FASTEN LAP WITH POP RIVETS AS SHOWN.

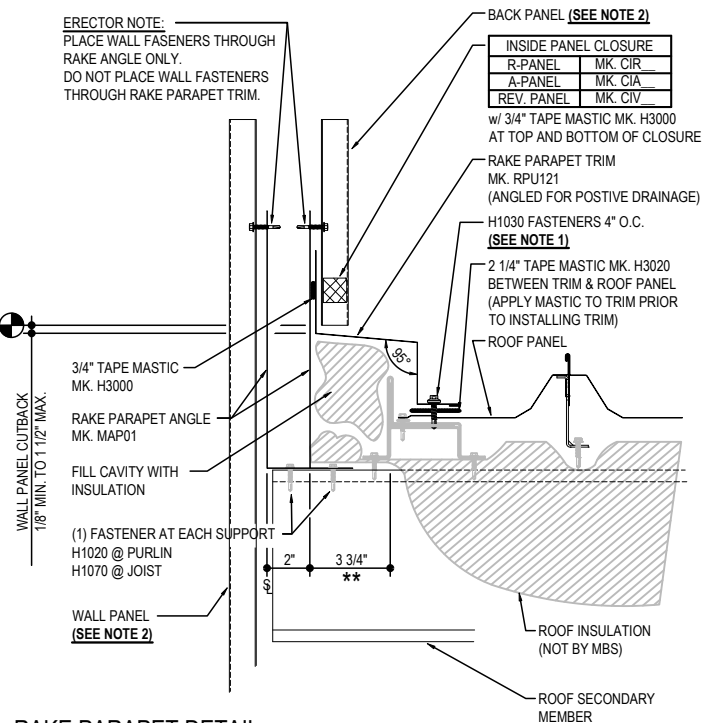
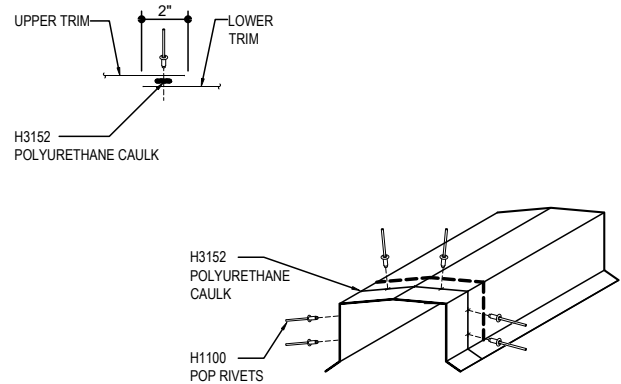

NOTE 1: KEEP FASTENERS 2" AWAY FROM RAKE CLIPS!!

NOTE 2: AS A STANDARD, PANELS WILL BE STEPPED IF ROOF SLOPE IS < 1/2:12
FIELD MITERING WILL BE REQUIRED IF ROOF SLOPE IS > 1/2:12

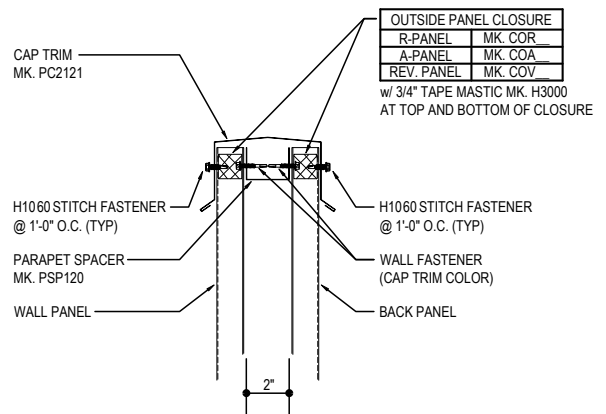

RAKE PARAPET DETAIL

RAKE PARAPET DETAIL w/ WALL PANELS
SEE WALL SHEETING ERECTION NOTES FOR WALL PANEL FASTENER LOCATIONS

EF6090

Detailer Notes:

- 1) PANEL CLOSURES ARE ALWAYS PROVIDED AS A STANDARD AT THE BACK PANEL.
- 2) OUTSIDE WALL PANEL CLOSURES ARE OPTIONAL ON EXTERIOR PANEL. TURN OFF OUTSIDE CLOSURE LAYER IF NOT REQUIRED.

EF6610 - RAKE PARAPET w/ INSULATED WALL PANEL ABOVE

[Download the DWG file by clicking here.](#)

PARAPET LAP & FLASHING BACKER

SLIDE FIELD CUT SECTION OF FLASHING ENDLAP BACKER ONTO THE LOWER TRIM PIECE AS SHOWN BELOW. PLACE TAPE MASTIC NEXT TO HEM OF THE BACKER (NOT ON TOP OF HEM). FASTEN LAP WITH STITCH FASTENERS. ROOF STRUCTURAL FASTENERS SHOULD BE USED TO FASTEN THROUGH PANEL FLAT INTO RAKE ANGLE.

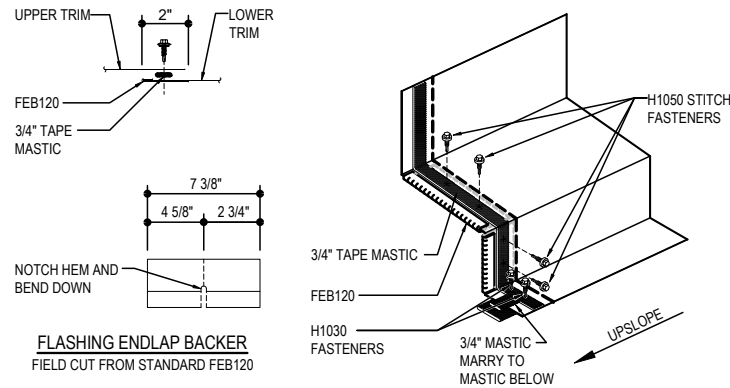

NOTE 1: KEEP FASTENERS 2"
AWAY FROM RAKE CLIPS!!

**NOTE 2: AS A STANDARD, PANELS
WILL BE STEPPED IF ROOF SLOPE
IS $< 1/2:12$**
**FIELD MITERING WILL BE REQUIRED
IF ROOF SLOPE IS $> 1/2:12$**

ERECTOR NOTE: _____
PLACE WALL FASTENERS THROUGH
RAKE ANGLE ONLY.
DO NOT PLACE WALL FASTENERS
THROUGH RAKE PARAPET TRIM.

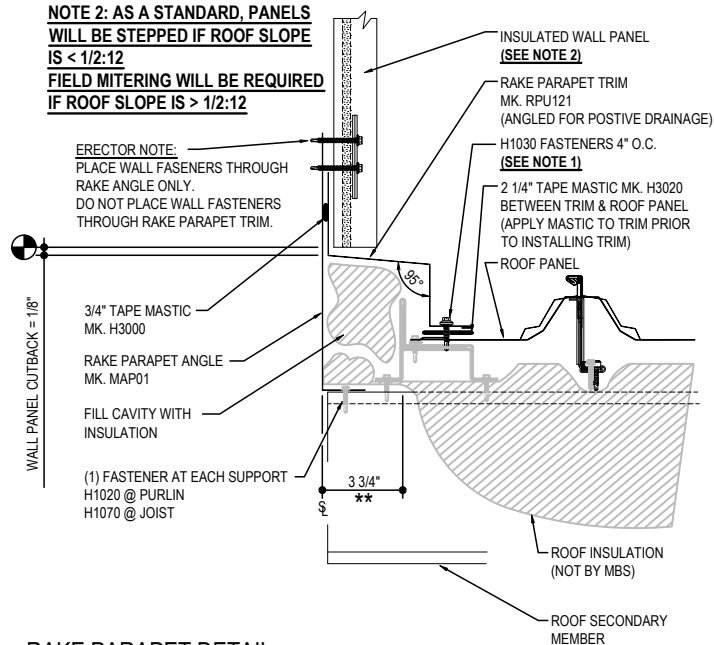

RAKE PARAPET DETAIL

RAKE PARAPET DETAIL w/ INSULATED WALL PANELS
SEE INSULATED WALL SHEETING ERECTION DETAILS FOR INSTALLATION
INSTRUCTIONS.

EF6610

Detailer Notes:

1) N/A

EF6650 - RAKE PARAPET w/ INSULATED WALL PANEL ABOVE/BELOW

[Download the DWG file by clicking here.](#)

PARAPET LAP & FLASHING BACKER

SLIDE FIELD CUT SECTION OF FLASHING ENDLAP BACKER ONTO THE LOWER TRIM PIECE AS SHOWN BELOW. PLACE TAPE MASTIC NEXT TO HEM OF THE BACKER (NOT ON TOP OF HEM). FASTEN LAP WITH STITCH FASTENERS. ROOF STRUCTURAL FASTENERS SHOULD BE USED TO FASTEN THROUGH PANEL FLAT INTO RAKE ANGLE.

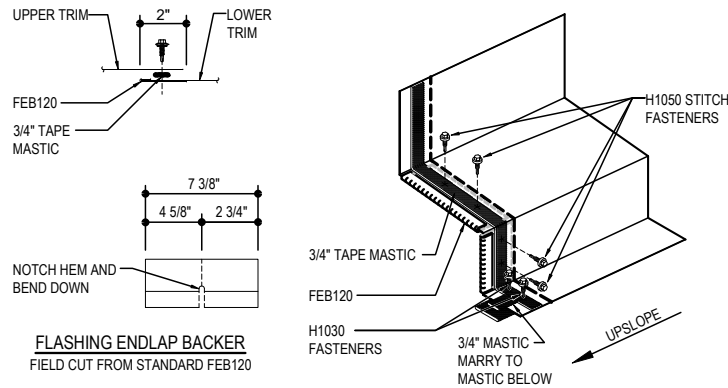

NOTE 1: KEEP FASTENERS 2" AWAY FROM RAKE CLIPS!!

NOTE 2: AS A STANDARD, PANELS WILL BE STEPPED IF ROOF SLOPE IS < 1/2:12. FIELD MITERING WILL BE REQUIRED IF ROOF SLOPE IS > 1/2:12

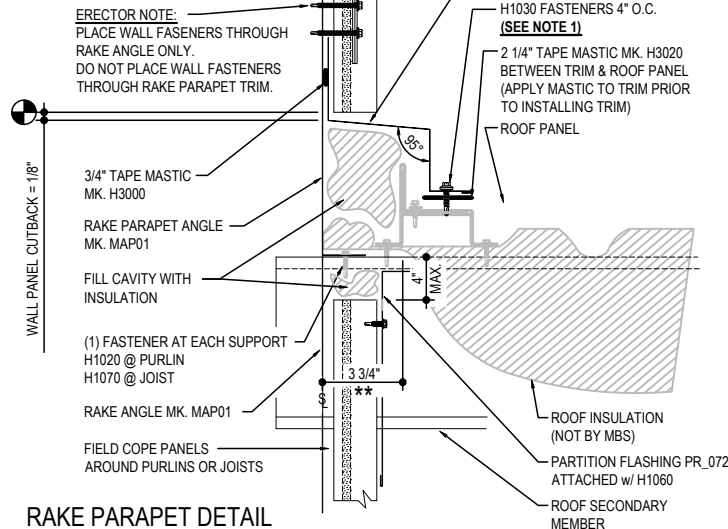

RAKE PARAPET DETAIL

RAKE PARAPET DETAIL w/ INSULATED WALL PANELS
SEE INSULATED WALL SHEETING ERECTION DETAILS FOR INSTALLATION INSTRUCTIONS.

EF6650

Detailer Notes:

1) N/A

EF6690 - NON-STRUCTURAL PARAPET - IMP WITH BACKER

[Download the DWG file by clicking here.](#)

PARAPET LAP & FLASHING BACKER

SLIDE FIELD CUT SECTION OF FLASHING ENLAP BACKER ONTO THE LOWER TRIM PIECE AS SHOWN BELOW. PLACE TAPE MASTIC NEXT TO HEM OF THE BACKER (NOT ON TOP OF HEM). FASTEN LAP WITH STITCH FASTENERS. ROOF STRUCTURAL FASTENERS SHOULD BE USED TO FASTEN THROUGH PANEL FLAT INTO RAKE ANGLE.

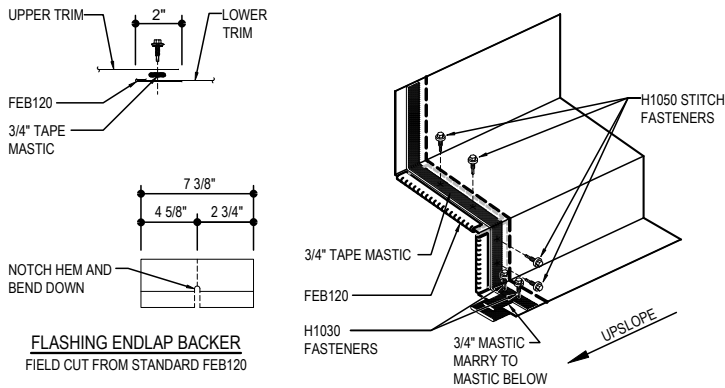

CAP TRIM LAP

APPLY CONTINUOUS BEAD OF CAULK 1" FROM END OF TRIM DOWN PROFILE OF TRIM. FASTEN LAP WITH POP RIVETS AS SHOWN.

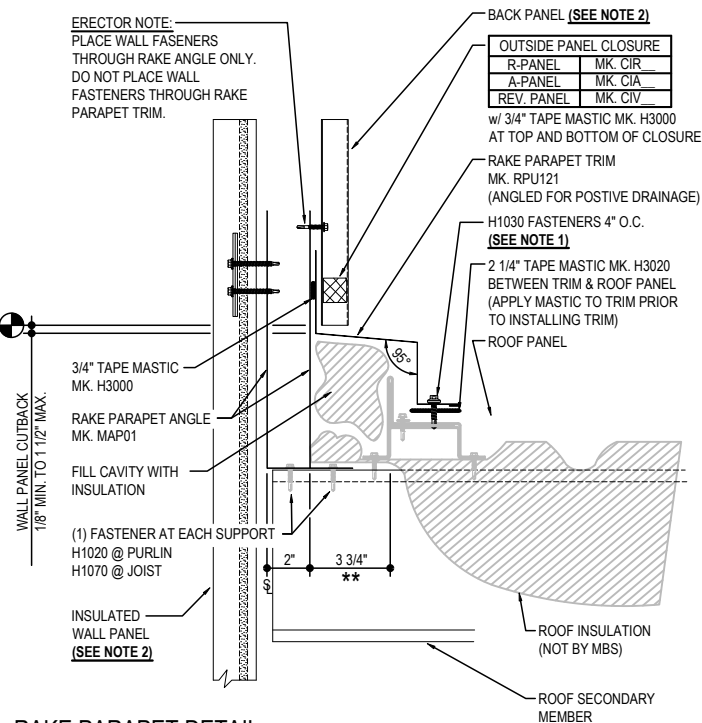
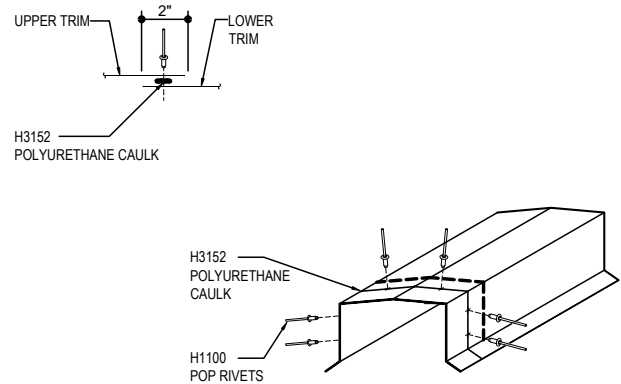

NOTE 1: KEEP FASTENERS 2" AWAY FROM RAKE CLIPS!!

NOTE 2: AS A STANDARD, PANELS WILL BE STEPPED IF ROOF SLOPE IS < 1/2:12
FIELD MITERING WILL BE REQUIRED IF ROOF SLOPE IS > 1/2:12

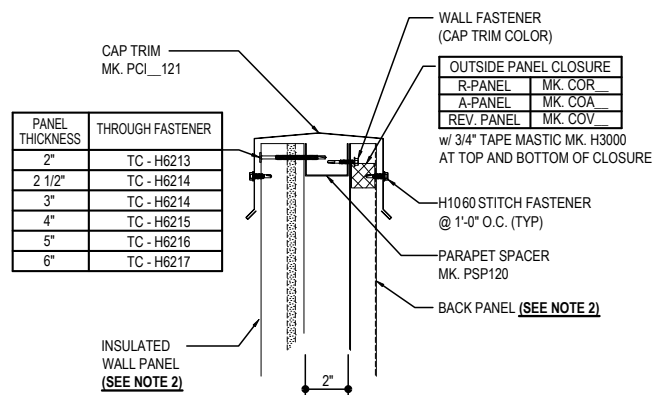

RAKE PARAPET DETAIL

RAKE PARAPET DETAIL w/ WALL PANELS
SEE WALL SHEETING ERECTION NOTES FOR WALL PANEL FASTENER LOCATIONS

EF6690

Detailer Notes:

1) N/A